



## The Birches, SE7

£524,950

Three bedroom terraced house with a south facing rear garden and a garage en-block. Accommodation comprises of a porch to front which leads onto a reception room and through to a kitchen/dining room that our vendor has recently updated. Upstairs are three bedrooms and a family bathroom, plus loft space which could be converted to a further bedroom (STTP). Offered with no chain.

Situated in a quiet cul-de-sac, minutes from Charlton Station and within easy access of North Greenwich Jubilee Line and for buses and trains to the Elizabeth Line. There are shops and superstores close by and popular primary schools.

### Features

- Three Bedroom Terrace
- Cul-de-Sac Location
- Garage En-Block
- Close To The Station
- South Facing Garden
- No Chain

# The Birches, London, SE7

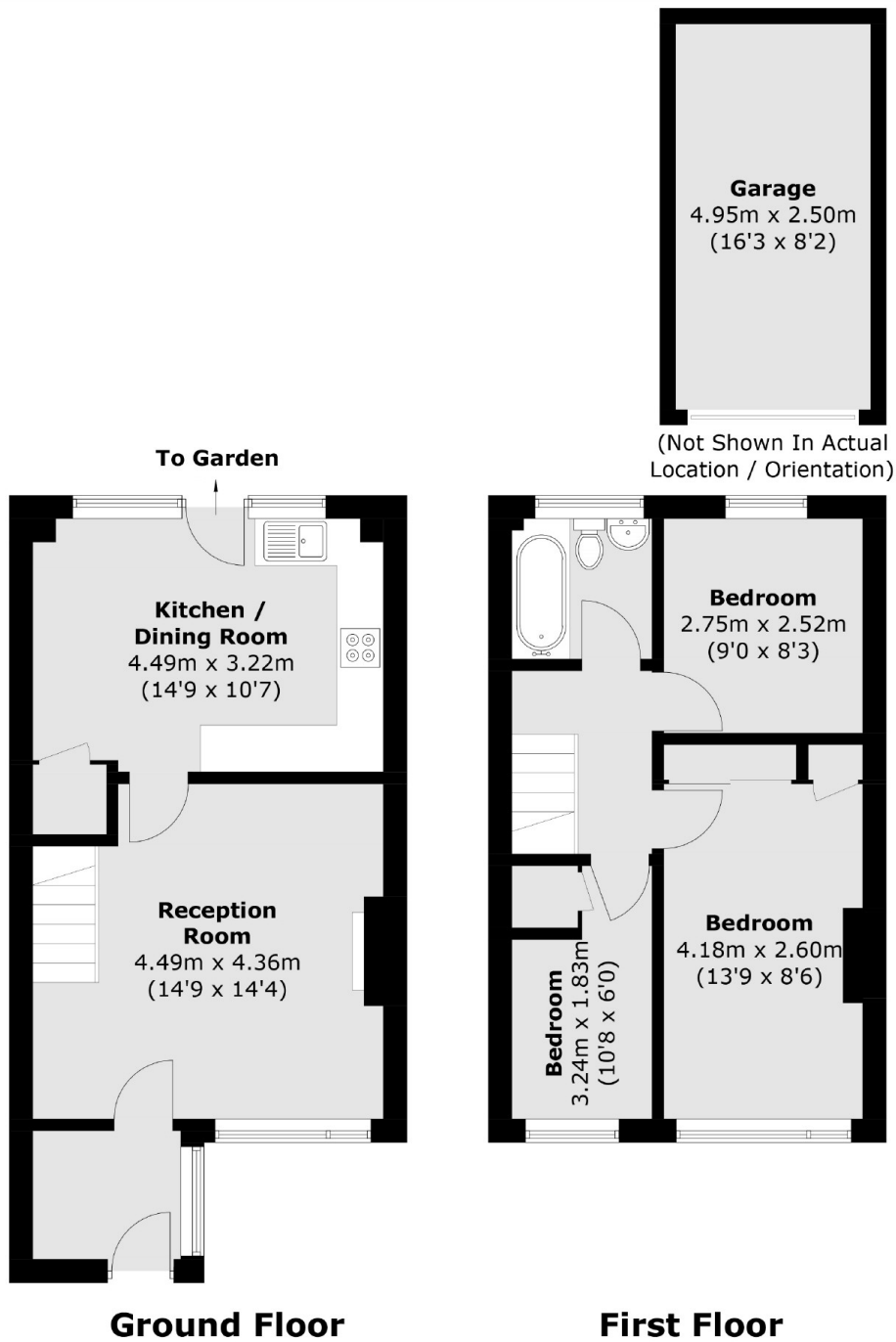

Total area (approx.): 72.9 sq. m (784.6 sq. ft)

Garage (approx.): 12.4 sq. m (133.5 sq. ft)