



Victoria Way, SE7

£400,000

Bright and spacious two double bedroom first floor apartment which offers bright open plan living space, a large balcony, parking and lift access.

Accommodation comprises of a large reception room with dual aspect windows, wooden floors and central heating. This is open plan to a fitted kitchen with space for all appliances and which offers plenty of storage. Both bedrooms are doubles and there is a well presented family bathroom. This is a fantastic first time buy or investment purchase.

Situated on Victoria Way, minutes from Charlton Station and close to North Greenwich Jubilee Line. The shops and superstores are within a short walk and the property is close to popular primary schools.

Features

Spacious Two Double Flat
Excellent Living Space
Large Balcony
Minutes From Charlton Station
Parking
Lift Access

Victoria Way, London, SE7

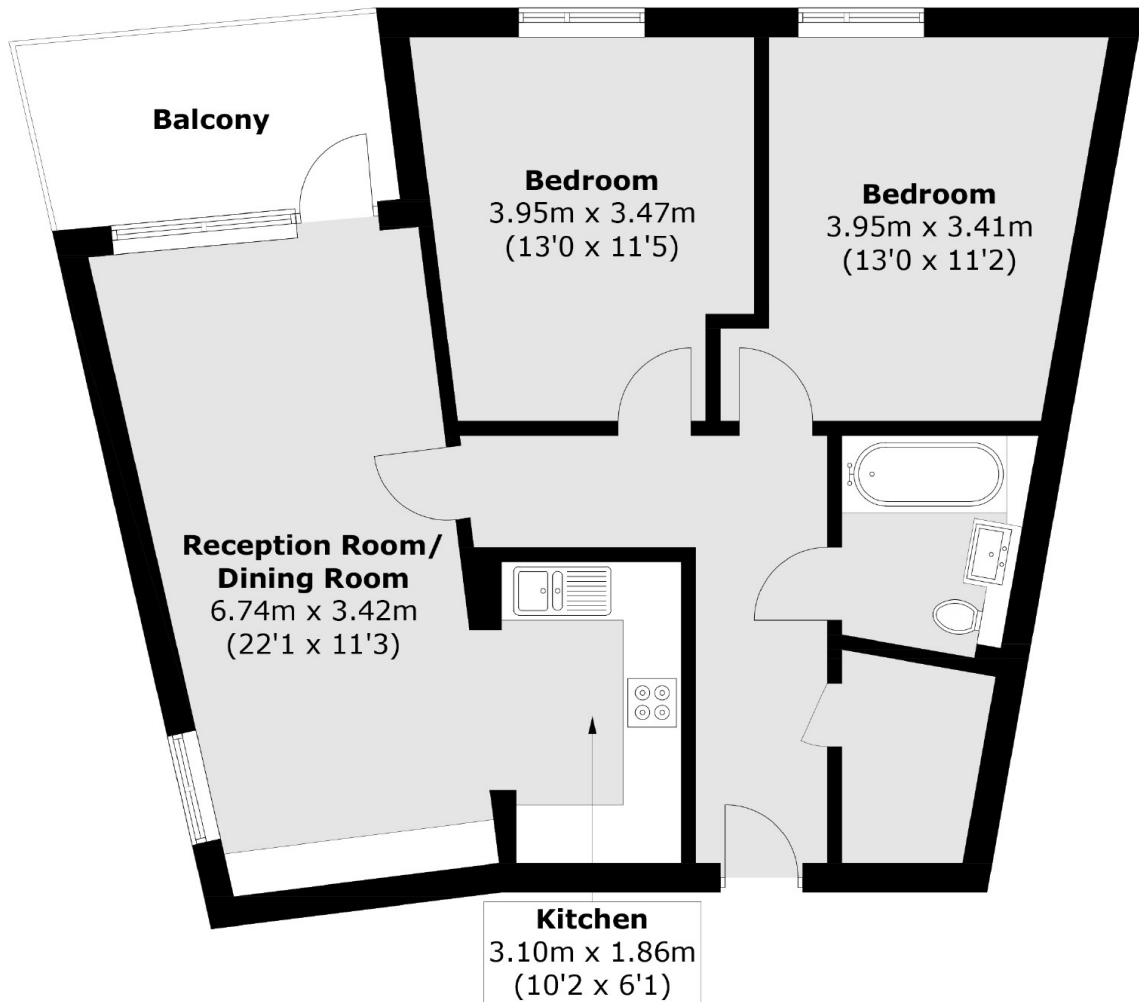

Total area (approx.): 72.0 sq. m (775.0 sq. ft)

Balcony (approx.): 7.0 sq. m (75.3 sq. ft)