

## Merbury Close, SE28

£200,000

Excellent first floor one double bedroom flat with good size rooms, neutral decor and plenty of storage. There is a spacious reception room with space for a dining table and open plan to the kitchen. There is a large bedroom with a 'Jack and Jill' bathroom. The parking is gated and secure and the property is offered with no chain.

Situated in a gated development, close to the Thames River Walk and the Elizabeth Line and within easy reach of the shops and amenities in Woolwich.

### Features

Spacious One Bedroom Flat  
Close To The Elizabeth Line  
Minutes From The River Walk  
Near To Shops And Amenities  
Gated Parking  
No Chain

# Merbury Close, London, SE28

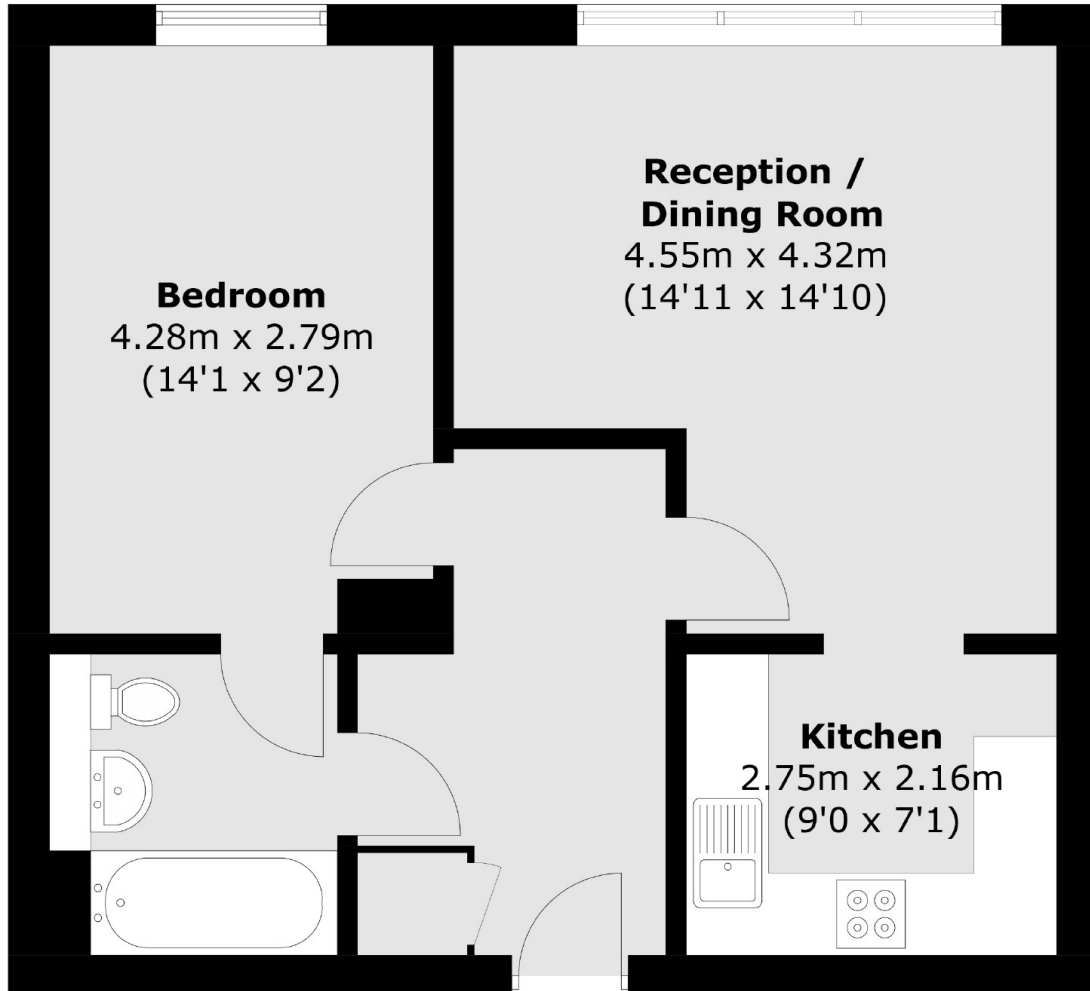

Total area (approx.): 49.0 sq. m (527.4 sq. ft)