

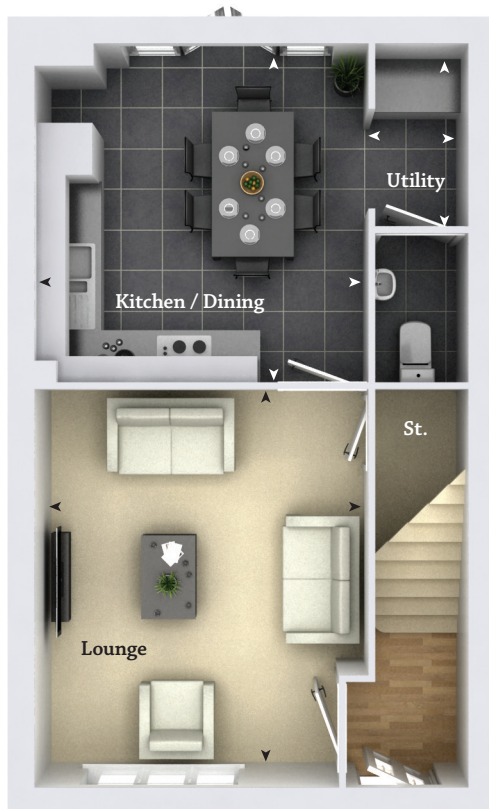

introducing the
Studland
Three bedroom home

A three bedroom home featuring a spacious lounge and open plan kitchen / dining area with separate utility space and french doors leading to the garden. Upstairs, the spacious master bedroom benefits from superb en suite facilities.



Ground



First

Ground floor Lounge 4.38 x 3.67 (14'5" x 12'0") • Kitchen / Dining area 3.72 x 3.67 (12'3" x 12'0") • Utility area 1.98 x 1.03 (6'6" x 3'5") • Cloaks

First floor Bedroom one 3.44 x 2.96 (9'2" x 11'3") • En suite • Bedroom two 3.10 x 2.69 (10'2" x 8'10") • Bedroom three 3.58 x 1.97 (11'9" x 6'5") • Bathroom