

Glade Court

Uxbridge • Middlesex • UB8 1PJ

PCM: £1,600 PCM



coopers
est 1986

A Luxury TWO DOUBLE BEDROOM, TWO BATHROOM Top floor apartment situated in the heart of Uxbridge Town Centre. Perfect for the modern lifestyle and Commuters. Bars restaurants and shopping facilities on your doorstep. Accommodation; Two double bedrooms (master with ensuite bathroom), Large open-plan Lounge to kitchen, Further Bathroom. Benefits; Allocated parking, Double glazing, gas central heating, entry-phone system, Communal gardens. FURNISHED

Walking Distance to Uxbridge Town Centre

Great Transport Links

Allocated Parking

Easy Access to M40

Communal Gardens

Close Distance to Heathrow Airport

Great Local Amenities

Close to Brunel University

Council Tax Band D

Ample Storage Space

Available Date

5th May 2025

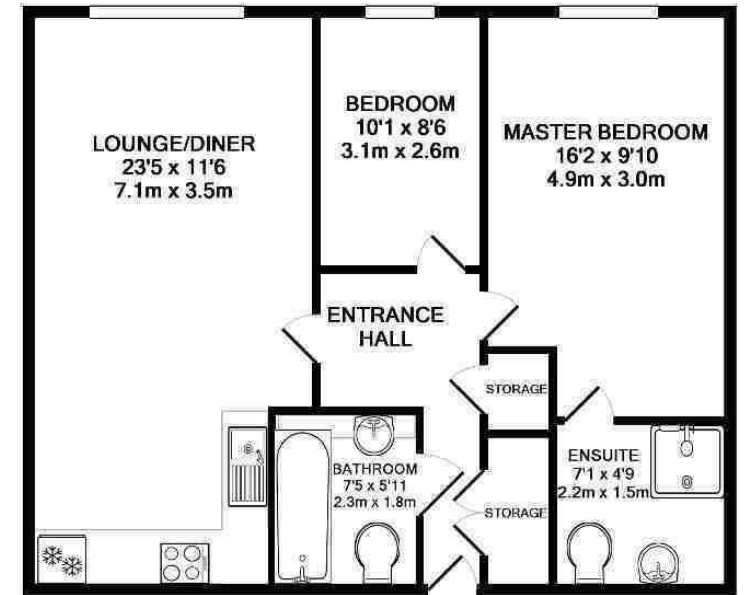

TOTAL APPROX. FLOOR AREA 647 SQ.FT. (60.1 SQ.M.)

Whilst every attempt has been made to ensure the accuracy of the floor plan contained here, measurements of doors, windows, rooms and any other items are approximate and no responsibility is taken for any error, omission, or mis-statement. This plan is for illustrative purposes only and should be used as such by any prospective purchaser. The services, systems and appliances shown have not been tested and no guarantee as to their operability or efficiency can be given

Made with Metropix ©2014

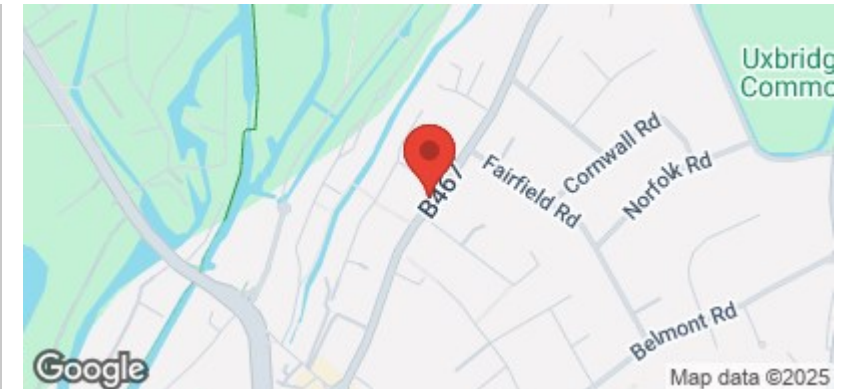

coopers
est 1986

01895 257 566

**1 Vine Street, Uxbridge,
Middlesex, UB8 1QE**

propertymanagement@coopersresidential.co.uk

CoopersResidential.co.uk

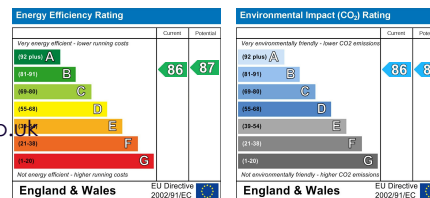

Important Notice: These particulars, whilst believed to be accurate are set out as a general outline only for guidance and do not constitute any part of an offer or contract. Intending purchasers should not rely on them as statements or representation of fact, but must satisfy themselves by inspection or otherwise has the authority to make or give any representation or warranty in respect of the property.