

Lynhurst Road

Hillingdon • Middlesex • UB10 9ED

PCM: £1,750 PCM



coopers
est 1986

Offered to the market is this two bedroom end of terrace house in the ever popular Oak Farm Estate. The property briefly comprises entrance hall leading to laminated through lounge and onto the brand new kitchen with fitted appliances. Upstairs offers a master bedroom with ample storage, second bedroom and family bathroom with shower over bath. A large garden to the rear of the property and driveway parking for two cars at the front.

Available Unfurnished.

Two Bedroom House

Large Garden

Located on the Oak Farm Estate

End of Terrace House

Available Now

Close to local Amenities

Council Tax Band D

Driveway Parking

Easy Access to A40/M25/M4

Unfurnished

Available Date

21st April 2025



GROUND FLOOR
355 sq.ft. (32.9 sq.m.) approx.

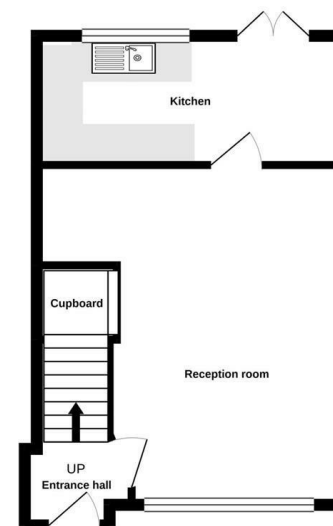

1ST FLOOR
318 sq.ft. (29.5 sq.m.) approx.

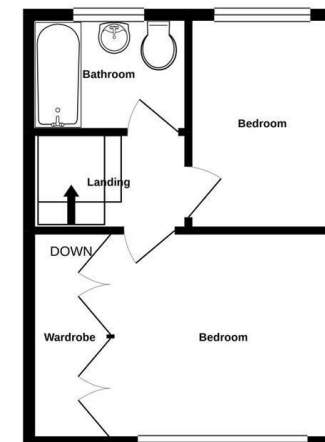

TOTAL FLOOR AREA : 672 sq.ft. (62.5 sq.m.) approx.

Whilst every attempt has been made to ensure the accuracy of the floorplan contained here, measurements of doors, windows, rooms and any other items are approximate and no responsibility is taken for any error, omission or mis-statement. This plan is for illustrative purposes only and should be used as such by any prospective purchaser. The services, systems and appliances shown have not been tested and no guarantee as to their operability or efficiency can be given.
Made with Metropix ©2020

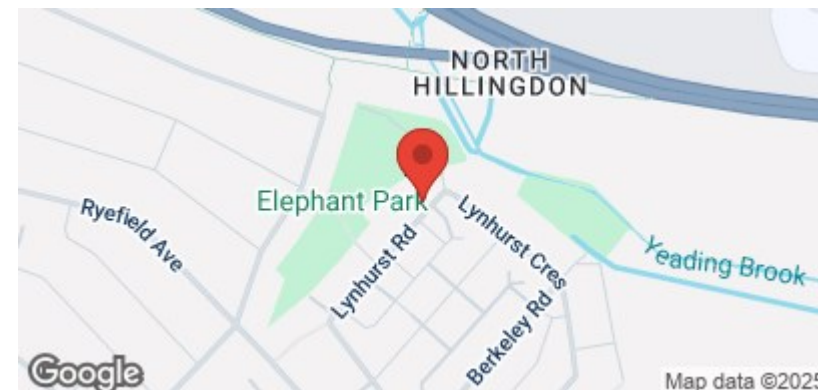

coopers
est 1986

01895 257 566

**1 Vine Street, Uxbridge,
Middlesex, UB8 1QE**

propertymanagement@coopersresidential.co.uk

CoopersResidential.co.uk

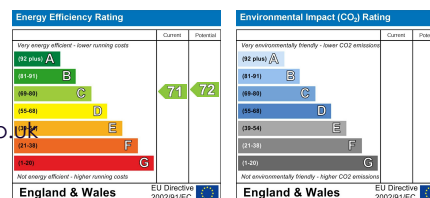

Important Notice: These particulars, whilst believed to be accurate are set out as a general outline only for guidance and do not constitute any part of an offer or contract. Intending purchasers should not rely on them as statements or representation of fact, but must satisfy themselves by inspection or otherwise has the authority to make or give any representation or warranty in respect of the property.