

The Green

Southall • • UB2 4FF

PCM: £1,875 PCM



coopers
est 1986

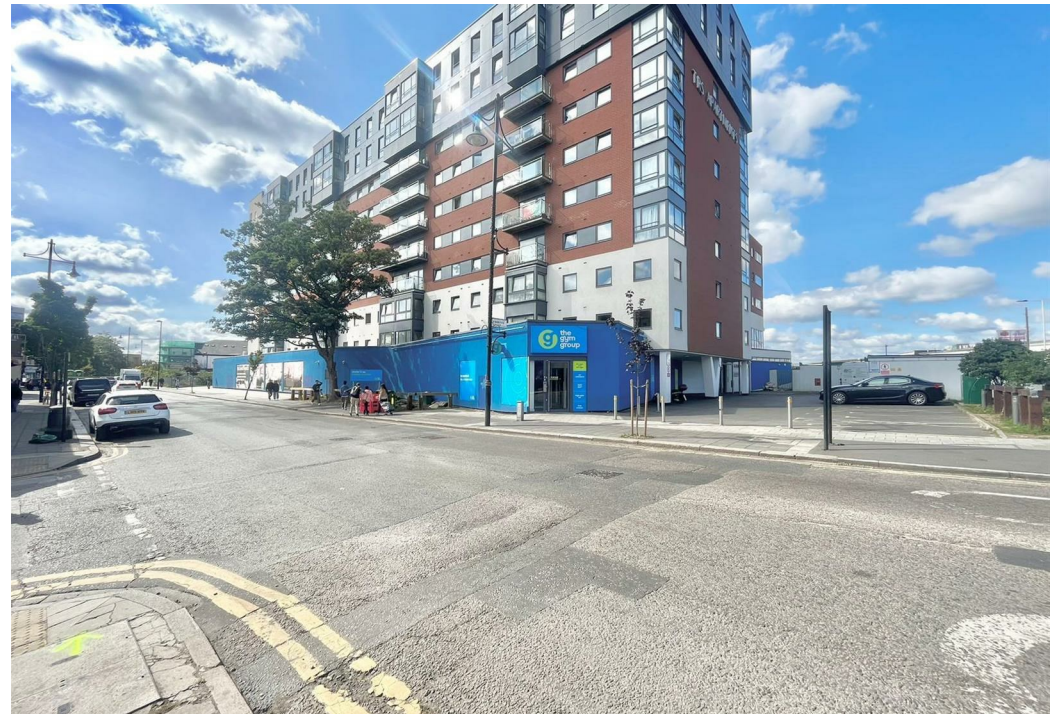

Presented to the market, this immaculate two bedroom apartment located in an exciting development next to Southall Train Station, which also provides easy access to local amenities. Features include two double bedrooms, bathroom with bath tub & shower, ensuite, spacious lounge, fitted kitchen with appliances and ample storage.

Parking available at an additional cost. Available Unfurnished.

Two Bedrooms

Two Bathrooms

Unfurnished

24 Hour Concierge

Parking Available At Additional Cost

Moments From Southall Station

Elizabeth Line

Local Amenities

Council Tax Band C

8th Floor

Available Date

24th September 2024



GROUND FLOOR
648 sq.ft. (60.2 sq.m.) approx.

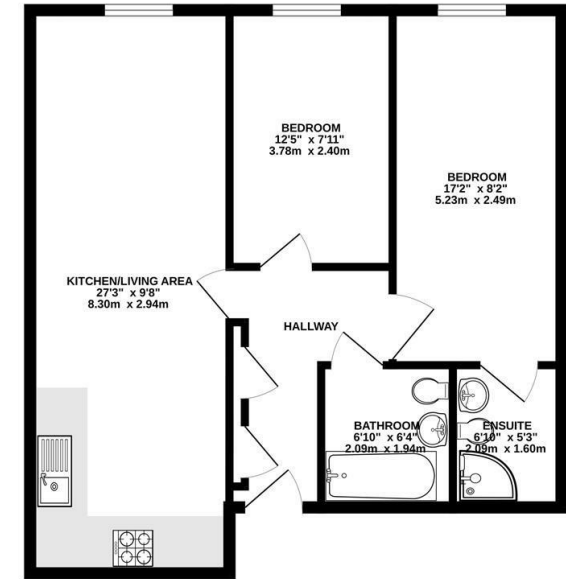

TOTAL FLOOR AREA: 648 sq.ft. (60.2 sq.m.) approx.
While every attempt has been made to ensure the accuracy of the footprint contained here, measurements of doors, windows, rooms and any other items are approximate and no responsibility is taken for any error, omission or mis-statement. This plan is for illustrative purposes only and should be used as such by any prospective purchaser. The services, fixtures and appliances shown have not been tested and no guarantee as to their operability or efficiency can be given.
Made with Metropac C2024



01895 257 566
1 Vine Street, Uxbridge,
Middlesex, UB8 1QE
propertymanagement@coopersresidential.co.uk

CoopersResidential.co.uk

Energy Efficiency Rating		Environmental Impact (CO ₂) Rating	
Current	Potential	Current	Potential
76	76		

EU Directive 2002/91/EC

Important Notice: These particulars, whilst believed to be accurate are set out as a general outline only for guidance and do not constitute any part of an offer or contract. Intending purchasers should not rely on them as statements or representation of fact, but must satisfy themselves by inspection or otherwise has the authority to make or give any representation or warranty in respect of the property.