

Newcombe Rise

Middlesex • Middlesex • UB7 8QE

PCM: £1,600 PCM



coopers
est 1986

This beautiful two bedroom home is ideal for a small family. Located within a short drive of Stockley Business Park, the M25 and M4 motorways as well as being within a short walk of West Drayton train station.

Downstairs consists of a large lounge, separate kitchen and a downstairs WC, conservatory. Upstairs has two bedrooms and a family bathroom, small lawn and a shed for storage. Allocated parking included.

Unfurnished.

Private Garden

Allocated Parking

Close To West Drayton High Street

Close To West Drayton Station

Easy Access To Stockley Business Park

Easy Access To M4/M25 Motorways

Council Tax Band D

Conservatory

Full Fitted Kitchen With Appliances

Great Transport Links

Available Date

3rd September 2024

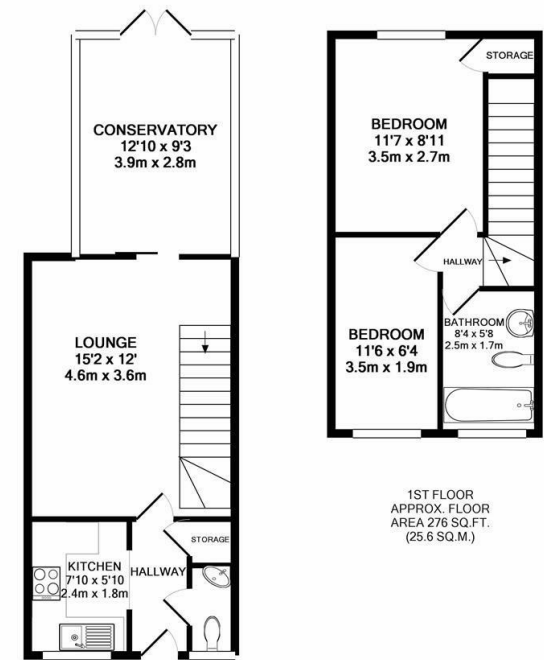

1ST FLOOR
APPROX. FLOOR
AREA 276 SQ.FT.
(25.6 SQ.M.)

GROUND FLOOR
APPROX. FLOOR
AREA 394 SQ.FT.
(36.6 SQ.M.)

TOTAL APPROX. FLOOR AREA 670 SQ.FT. (62.2 SQ.M.)

Whilst every attempt has been made to ensure the accuracy of the floor plan contained here, measurements of doors, windows, rooms and any other items are approximate and no responsibility is taken for any error, omission, or mis-statement. This plan is for illustrative purposes only and should be used as such by any prospective purchaser. The services, systems and appliances shown have not been tested and no guarantee as to their operability or efficiency can be given.
Made with Metropix ©2017



01895 257 566

**1 Vine Street, Uxbridge,
Middlesex, UB8 1QE**

propertymanagement@coopersresidential.co.uk

CoopersResidential.co.uk

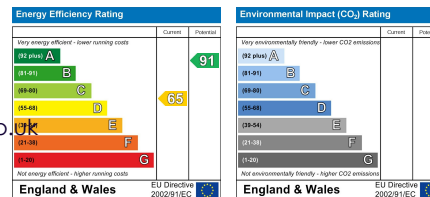

Important Notice: These particulars, whilst believed to be accurate are set out as a general outline only for guidance and do not constitute any part of an offer or contract. Intending purchasers should not rely on them as statements or representation of fact, but must satisfy themselves by inspection or otherwise has the authority to make or give any representation or warranty in respect of the property.

coopers
est 1986