



Connells

Wolverhampton Road  
Cannock



### Ground Floor

#### Living Room

11' 8" x 11' 9" ( 3.56m x 3.58m )

Having a double glazed front entrance door, double glazed bay window to the front aspect, radiator, ceiling light point, wooden flooring and access to the cellar and lounge

#### Cellar

Having ample storage space, power and lighting

#### Lounge

11' 8" x 11' 9" ( 3.56m x 3.58m )

Having a double glazed window to the rear aspect, radiator, ceiling light point, laminate flooring and archway for access to the stairs leading to the first floor

#### Kitchen

9' 2" x 6' 7" ( 2.79m x 2.01m )

Being a fitted kitchen with a range of wall, base and drawer units with laminate work surfaces over and having a sink/drainer, integrated electric oven with gas hobs and extractor hood, space for appliances, radiator, ceiling spotlights, laminate flooring, double glazed window to the side aspect, double glazed door to the side rear garden and open access to rear reception area having radiator, ceiling spotlights, laminate flooring and double glazed French doors to the rear garden



## First Floor

### Bedroom 1

11' 8" x 11' 9" ( 3.56m x 3.58m )

Having a double glazed window to the front aspect, radiator, ceiling light point, wooden flooring and storage cupboard

### Bedroom 2

8' 5" x 9' 1" ( 2.57m x 2.77m )

Having a double glazed window to the rear aspect, radiator and ceiling light point

### Shower Room

Having a WC, wash hand basin, double shower cubicle, part tiled walls, radiator, ceiling light point, vinyl flooring and a double glazed window to the rear aspect

### Loft

Fully boarded and having a double glazed window

## Outside

### Rear

Having a decking area, large gravel bed, mature shrubs and bushes and a fully insulated outbuilding with power and lighting







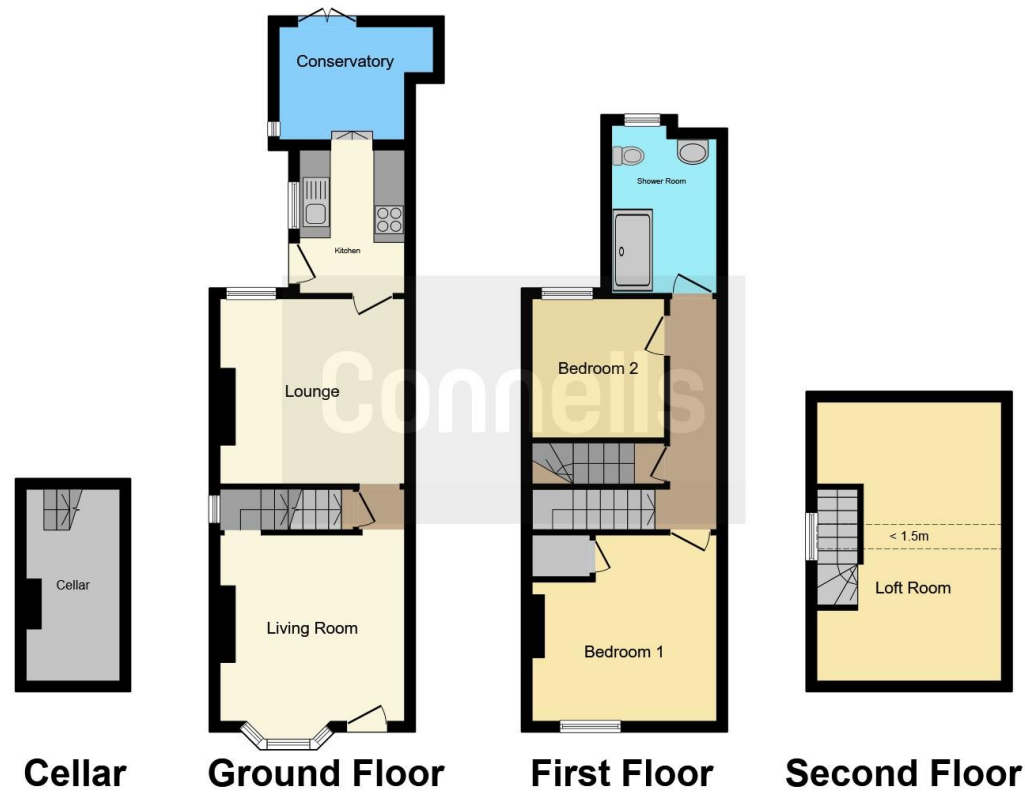

This floor plan is for illustrative purposes only. It is not drawn to scale. Any measurements, floor areas (including any total floor area), openings and orientation are approximate. No details are guaranteed, they cannot be relied upon for any purpose and they do not form part of any agreement. No liability is taken for any error, omission or misstatement. A party must rely upon its own inspection(s). Powered by [www.focalagent.com](http://www.focalagent.com)

To view this property please contact Connells on

**T 01543 500923**  
**E [cannock@connells.co.uk](mailto:cannock@connells.co.uk)**

10-12 Wolverhampton Road  
 CANNOCK WS11 1AH

**EPC Rating: Awaited**

Tenure: Freehold

**view this property online [connells.co.uk/Property/CNK107210](http://connells.co.uk/Property/CNK107210)**



1. MONEY LAUNDERING REGULATIONS Intending purchasers will be asked to produce identification documentation at a later stage and we would ask for your co-operation in order that there will be no delay in agreeing the sale. 2. These particulars do not constitute part or all of an offer or contract. 3. The measurements indicated are supplied for guidance only and as such must be considered incorrect. Potential buyers are advised to recheck measurements before committing to any expense. 4. We have not tested any apparatus, equipment, fixtures, fittings or services and it is in the buyers interest to check the working condition of any appliances.

Connells Residential is registered in England and Wales under company number 1489613, Registered Office is Cumbria House, 16-20 Hockliffe Street, Leighton Buzzard, Bedfordshire, LU7 1GN. VAT Registration Number is 500 2481 05.

**See all our properties at [www.connells.co.uk](http://www.connells.co.uk) | [www.rightmove.co.uk](http://www.rightmove.co.uk) | [www.zoopla.co.uk](http://www.zoopla.co.uk)**

Property Ref: CNK107210 - 0001