



Connells

Berry Hill
Hednesford, Cannock



Ground Floor

Entrance Hallway

Having a double glazed side entrance door, storage cupboard and doors to lounge and kitchen

Lounge

14' 1" x 11' 8" (4.29m x 3.56m)

Having a double glazed bay window to the front, radiator, fireplace, ceiling light point, carpeted flooring and stairs to first floor

Kitchen

11' 8" x 8' 5" (3.56m x 2.57m)

Being a fitted kitchen with a range of wall, base and drawer units with laminate work surfaces over and having a one and a half bowl sink/drainer, electric oven with gas hobs and cooker-hood over, integrated fridge/freezer, tiled splash-backs, ceiling light point, tiled flooring, double glazed window to the rear aspect and door to conservatory

Conservatory

Having tiled flooring, radiator, ceiling fan light, fitted blinds and door to rear garden



First Floor

Landing

Having carpeted flooring, double glazed window, ceiling light point and doors to bedrooms and bathroom

Bedroom 1

11' 8" x 8' 5" (3.56m x 2.57m)

Having a double glazed window to the front aspect, radiator, ceiling light point and laminate flooring

Bedroom 2

11' 8" x 11' 8" (3.56m x 3.56m)

Having a double glazed window to the rear aspect, radiator, ceiling light point and carpeted flooring

Bathroom

Having a WC, wash hand basin, walk in shower, towel radiator, storage cupboard and vinyl flooring

Outside

Front

Having a driveway, laid to lawn, pathway to entrance door and mature trees

Rear

Having a paved patio area, gravel bed and a variety of mature trees and bushes







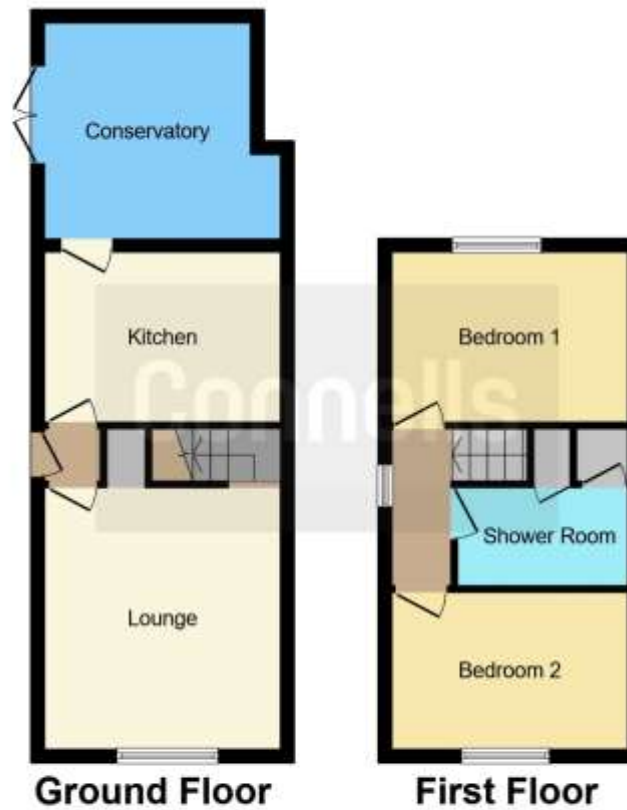

This floorplan is for illustrative purposes only and is not drawn to scale. Measurements, floor-areas, openings and orientations are approximate. They should not be relied upon for any purpose and do not form any part of an agreement. No liability is taken for any error or mis-statement. All parties must rely on their own inspections.

To view this property please contact Connells on

T 01543 500923
E cannock@connells.co.uk

10-12 Wolverhampton Road
 CANNOCK WS11 1AH

EPC Rating: C

Tenure: Freehold

view this property online connells.co.uk/Property/CNK106534



1. MONEY LAUNDERING REGULATIONS Intending purchasers will be asked to produce identification documentation at a later stage and we would ask for your co-operation in order that there will be no delay in agreeing the sale. 2. These particulars do not constitute part or all of an offer or contract. 3. The measurements indicated are supplied for guidance only and as such must be considered incorrect. Potential buyers are advised to recheck measurements before committing to any expense. 4. We have not tested any apparatus, equipment, fixtures, fittings or services and it is in the buyers interest to check the working condition of any appliances.

Connells Residential is registered in England and Wales under company number 1489613, Registered Office is Cumbria House, 16-20 Hockliffe Street, Leighton Buzzard, Bedfordshire, LU7 1GN. VAT Registration Number is 500 2481 05.

See all our properties at www.connells.co.uk | www.rightmove.co.uk | www.zoopla.co.uk

Property Ref: CNK106534 - 0003