

pomp

properties



West Cromwell Road

, London, SW5 9QJ

£480,000

Pomp Properties are proud to introduce to the market this delightful 1 Bedroom Flat on West Cromwell Road.

Situated on the 3rd floor of this sought-after address, this bright 1 bedroom flat offers a prime location and a host of outstanding features, this property is sure to captivate both first-time buyers and astute investors alike.

The quaint and functional kitchen features an electric hob, ample storage space, and stylish countertops.

The bedroom is a private oasis, with generous dimensions, it offers plenty of room for a comfortable bed, a cozy reading nook, or even a small home office. A built-in wardrobe provides convenient storage solutions, keeping your living space clutter-free and organized.

The tiled bathroom has a full size bathtub, with glass shower screen.

Excellent transport links, including nearby Earls Court tube station and bus stops, provide easy access to the rest of the city, making commuting a breeze.

In summary, this exceptional 1 bedroom flat at West Cromwell Road offers a rare combination of style, convenience, and comfort. Don't miss this opportunity to own a slice of urban paradise in one of the most desirable locations. Schedule a viewing today and envision your future in this remarkable home!

Viewing

Please contact our Pomp Properties Office on 020 7373 4000 if you wish to arrange a viewing appointment for this property or require further information.

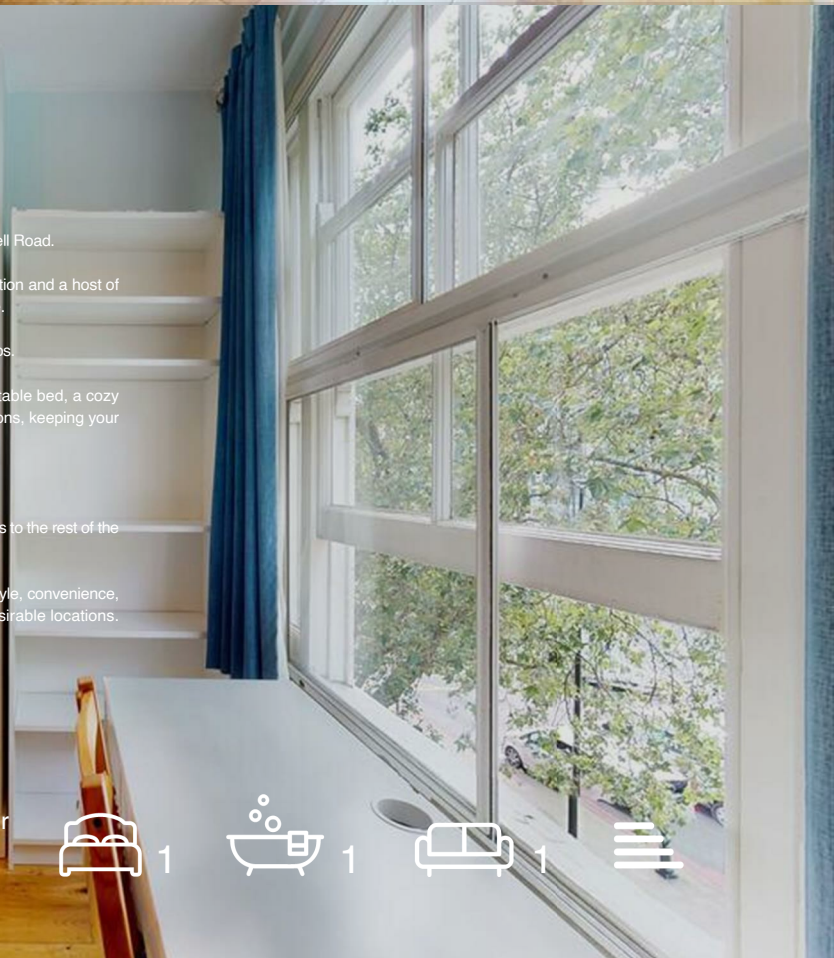

Floor Plan

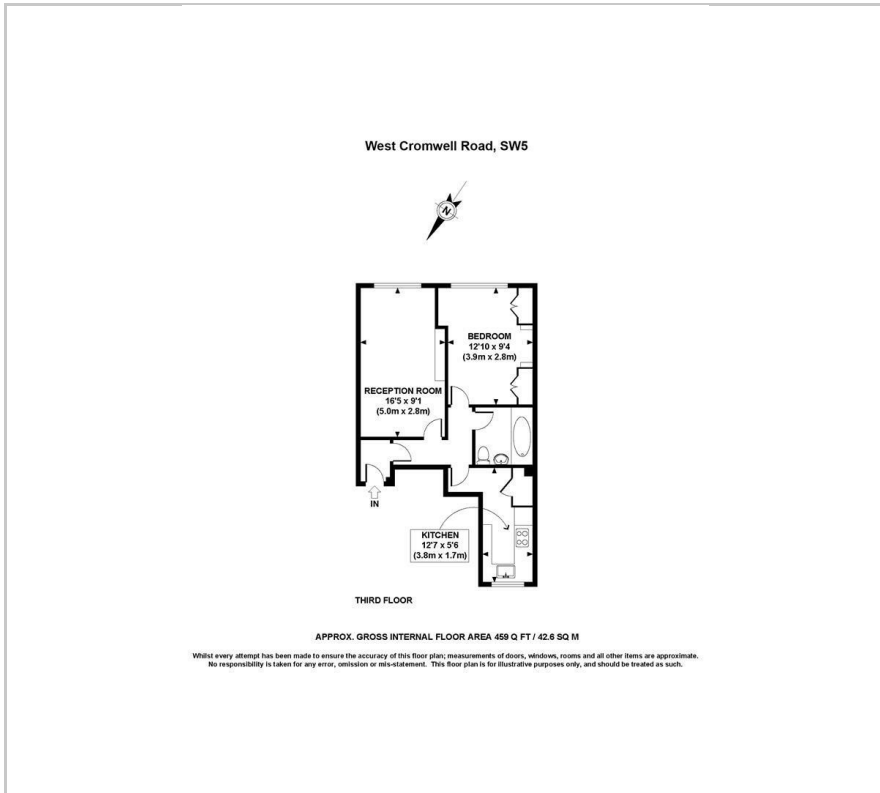

Area Map



Energy Efficiency Graph

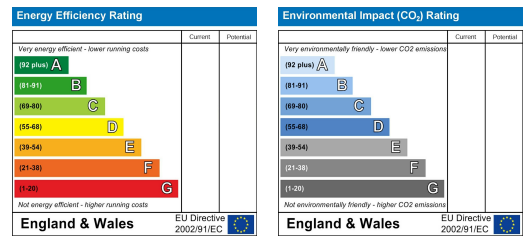

These particulars, whilst believed to be accurate are set out as a general outline only for guidance and do not constitute any part of an offer or contract. Intending purchasers should not rely on them as statements of representation of fact, but must satisfy themselves by inspection or otherwise as to their accuracy. No person in this firm's employment has the authority to make or give any representation or warranty in respect of the property.