



HUNTERS®
HERE TO GET *you* THERE

Arthur Terrace Bishop Auckland, DL14 6BL

Arthur Terrace Bishop Auckland, DL14 6BL

Price £60,000

Spacious two bedroomed end of terrace property offered for sale with no onward chain. Ideal for first time buyers or investors alike. Situated on Arthur Terrace, just a short distance from the town centre which provides easy access to a range of facilities such as supermarkets, shops, healthcare facilities, good primary and secondary schools. There is an extensive public transport system which provides access to not only the neighbouring towns and villages but to further afield places such as Darlington, Durham and Newcastle.

In brief the property comprises; an entrance hall leading into the living room, dining room, kitchen and bathroom to the ground floor. Whilst the first floor contains the two double bedrooms. Externally the property has an enclosed yard to the rear with gated access into the back lane, whilst to the front on street parking is available.

Hunters Bishop Auckland 147-149 Newgate Street, Bishop Auckland, DL14 7EN | 01388 311582
bishopauckland@hunters.com | www.hunters.com

GROUND FLOOR

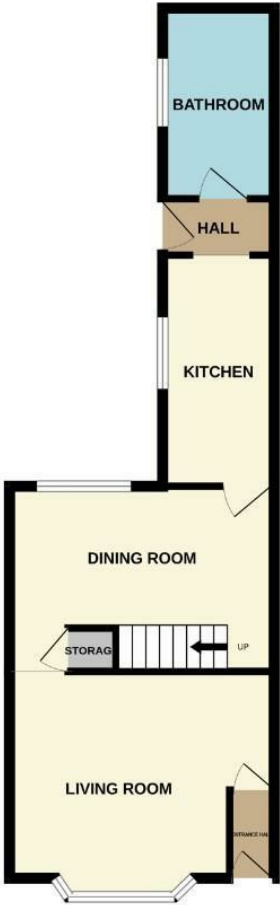

1ST FLOOR

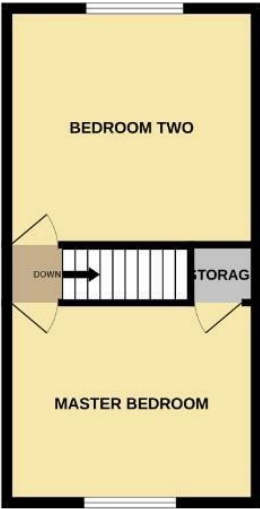

Whilst every attempt has been made to ensure the accuracy of the floorplan contained here, measurements of doors, windows, rooms and any other items are approximate and no responsibility is taken for any error, omission or mis-statement. This plan is for illustrative purposes only and should be used as such by any prospective purchaser. The services, systems and appliances shown have not been tested and no guarantee as to their operability or efficiency can be given.
Made with Metropex ©2025

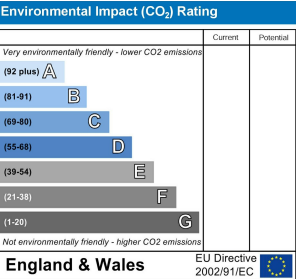
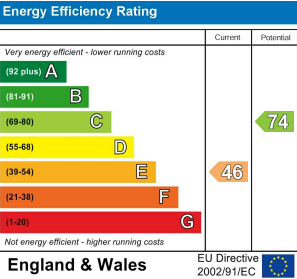

Living Room

13'0" x 10'9"

Spacious living room located to the front of the property, with ample space for furniture and large bay window to the front elevation.

Dining Room

13'0" x 11'9"

The second reception room is another good size, with room for a table and chairs, further furniture and window to the rear elevation.

Kitchen

12'1" x 5'10"

The kitchen contains a range of base and drawer units, complementing work surfaces, tiled splash backs and sink/drain unit. Space is available for free standing appliances and window to the side elevation.

Bathroom

10'2" x 5'10"

The bathroom contains a panelled bath, WC and wash hand basin.

Master Bedroom

13'0" x 10'7"

The master bedroom is a large double bedroom with window to the front elevation.

Bedroom Two

13'0" x 11'7"

The second bedroom is another double bedroom with built in storage cupboard and window to the rear elevation.

External

Externally the property has an enclosed yard to the rear with gated access into the back lane, whilst to the front on street parking is available.

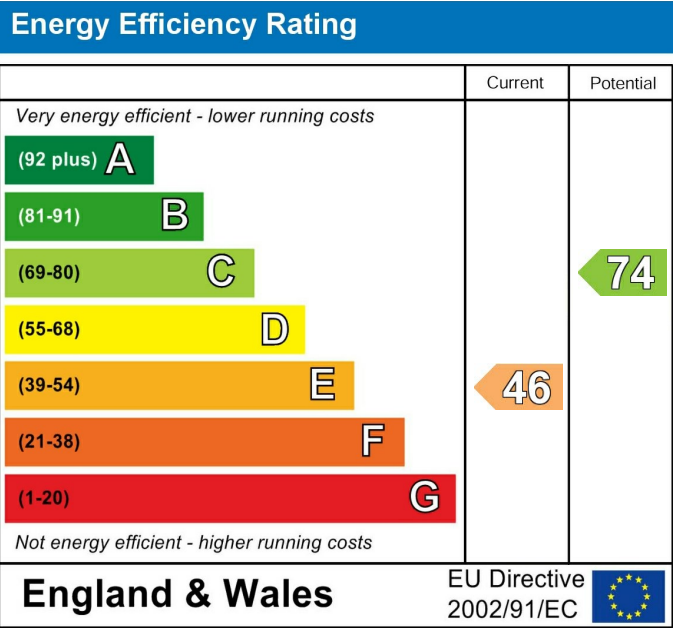

These particulars are intended to give a fair and reliable description of the property but no responsibility for any inaccuracy or error can be accepted and do not constitute an offer or contract. We have not tested any services or appliances (including central heating if fitted) referred to in these particulars and the purchasers are advised to satisfy themselves as to the working order and condition. If a property is unoccupied at any time there may be reconnection charges for any switched off/disconnected or drained services or appliances - All measurements are approximate. If you are thinking of selling your home or just curious to discover the value of your property, Hunters would be pleased to provide free, no obligation sales and marketing advice. Even if your home is outside the area covered by our local offices we can arrange a Market Appraisal through our national network of Hunters estate agents.



