



HUNTERS[®]
HERE TO GET *you* THERE

The Centre Evenwood, Bishop Auckland, DL14 9QF

The Centre Evenwood, Bishop Auckland, DL14 9QF

Price £63,000

Two bed terraced property, located on The Centre in Evenwood. The property is located overlooking the main green and benefits from a front garden and is offered for sale with no onward chain. The village provides a range of local amenities including; a primary school, village shop, cafés and doctors surgery. The nearby town Bishop Auckland is only approximately 4 miles away which provides a vast range of supermarkets, secondary schools, popular retails stores, restaurants and recreational facilities. Great links are available to commuters, the A688 leads to the A1 (M) both North and South as well as offering access to Barnard Castle and other nearby towns. The historical city Durham is located only approx. 15 miles away, providing a larger selection of restaurants and shops as well as having the popular indoor and outdoor markets. The area is perfect for dog lovers, walkers and cyclists with Hamsterley Forest being 15 minutes drive, Teesdale and Weardale is 30 minutes away. The cladding was done in 2021 with the value around £9,000.

In brief the property comprises; an entrance porch leading into the living room and kitchen. The first floor contains the two double bedrooms and bathroom. The loft is partially boarded with a drop-down ladder. Externally the property has an enclosed yard and outhouse to the rear, whilst to the front there is an enclosed front garden.

Hunters Bishop Auckland 147-149 Newgate Street, Bishop Auckland, DL14 7EN | 01388 311582
bishopauckland@hunters.com | www.hunters.com

GROUND FLOOR

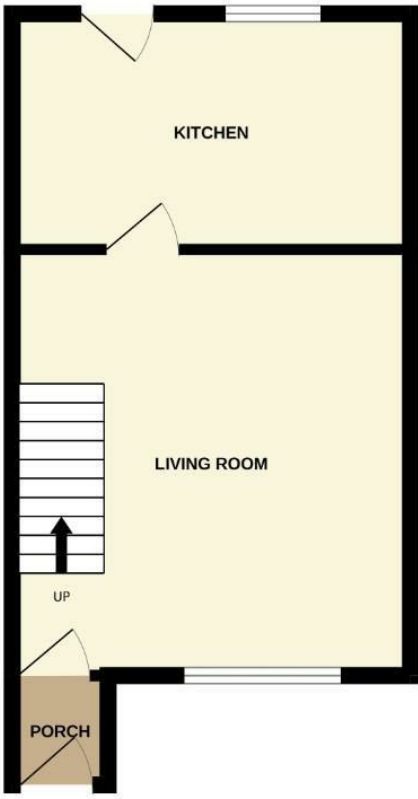

1ST FLOOR

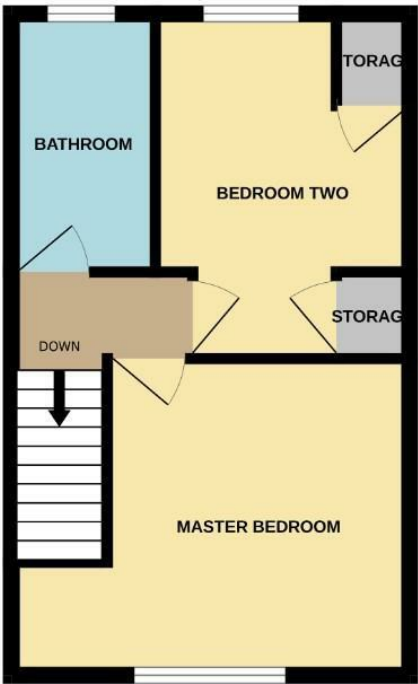

Whilst every attempt has been made to ensure the accuracy of the floorplan contained here, measurements of doors, windows, rooms and any other items are approximate and no responsibility is taken for any error, omission or mis-statement. This plan is for illustrative purposes only and should be used as such by any prospective purchaser. The services, systems and appliances shown have not been tested and no guarantee as to their operability or efficiency can be given.
Made with Metropix ©2025

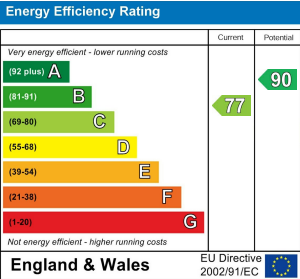

Living Room

14'9" x 13'9"

Spacious living room located to the front of the property, with window overlooking the front garden.

Kitchen

13'8" x 8'2"

The kitchen is fitted with a range of wall and base units, complementing work surfaces, tiled splash backs and sink/drainers unit. Space is available for free standing kitchen appliances.

Master Bedroom

11'5" x 10'2"

The master bedroom provides space for a king sized bed, further furniture and window to the front elevation.

Bedroom Two

11'11" x 8'4"

The second bedroom is another double room with built in storage cupboards and window to the rear elevation.

Bathroom

8'10" x 4'11"

The bathroom is fitted with a panelled bath, WC and wash hand basin.

External

Externally the property has an enclosed yard with outhouse providing storage. Whilst to the front there is an enclosed garden with gate leading out onto the green.

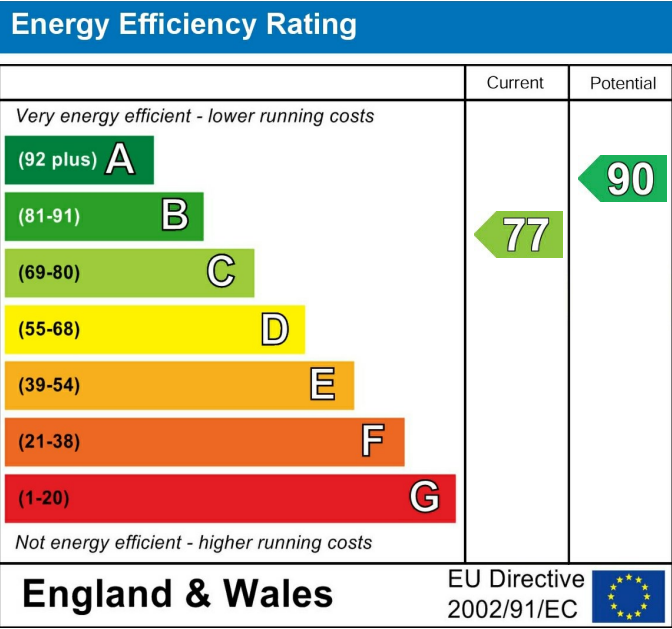

These particulars are intended to give a fair and reliable description of the property but no responsibility for any inaccuracy or error can be accepted and do not constitute an offer or contract. We have not tested any services or appliances (including central heating if fitted) referred to in these particulars and the purchasers are advised to satisfy themselves as to the working order and condition. If a property is unoccupied at any time there may be reconnection charges for any switched off/disconnected or drained services or appliances - All measurements are approximate. If you are thinking of selling your home or just curious to discover the value of your property, Hunters would be pleased to provide free, no obligation sales and marketing advice. Even if your home is outside the area covered by our local offices we can arrange a Market Appraisal through our national network of Hunters estate agents.







