



HUNTERS[®]

HERE TO GET *you* THERE

Manor Street Evenwood, Bishop Auckland, DL14 9Q

W822 PHF

17 Manor Street, Evenwood, Bishop Auckland, DL14 9QB

Price £50,000

Two bedroomed terraced property, located on Manor Road in Evenwood. Pleasantly positioned within close reach to local amenities which are available within the village including; a primary school, village shop, cafés and doctors surgery. The nearby town Bishop Auckland is only approximately 4 miles away which provides a vast range of supermarkets, secondary schools, popular retail stores, restaurants and recreational facilities. Great links are available to commuters, the A688 leads to the A1 (M) both North and South as well as offering access to Barnard Castle and other nearby towns. The historical city Durham is located only approx. 15miles away, providing a larger selection of restaurants and shops as well as having the popular indoor and outdoor markets.

In brief the property comprises; an entrance hall leading through into the living room, dining room and kitchen. The first floor contains a master bedroom, second bedroom and family bathroom. Externally the property has an enclosed yard to the rear with outhouse and gated access into the back lane. To the front of the property on street parking is available.

Hunters Bishop Auckland 147-149 Newgate Street, Bishop Auckland, DL14 7EN | 01388 311582
bishopauckland@hunters.com | www.hunters.com

GROUND FLOOR

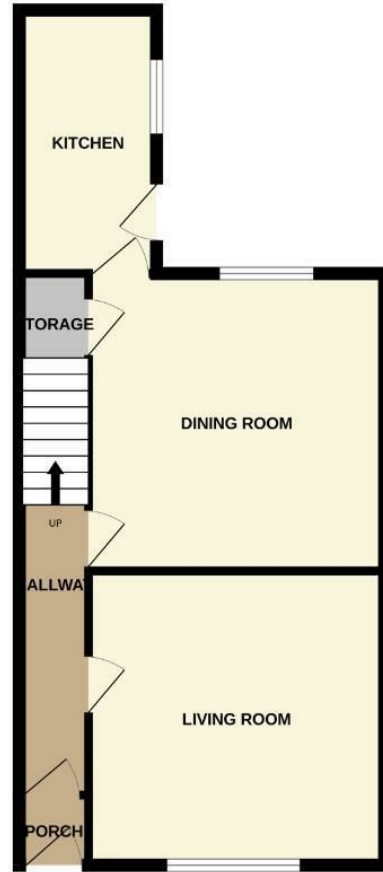

1ST FLOOR



Whilst every attempt has been made to ensure the accuracy of the floorplan contained here, measurements of doors, windows, rooms and any other items are approximate and no responsibility is taken for any error, omission or mis-statement. This plan is for illustrative purposes only and should be used as such by any prospective purchaser. The services, systems and appliances shown have not been tested and no guarantee as to their operability or efficiency can be given.
Made with Homestyler 10/2023

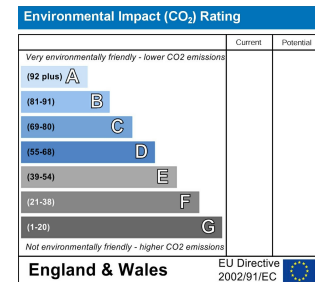
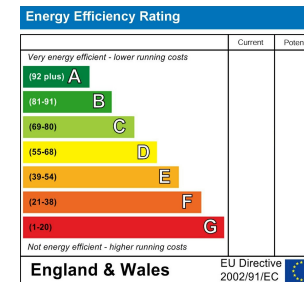

Living Room

13'1" x 13'1"

The living room is located to the front of the property, with ample space for furniture and window to the front elevation.

Dining Room

13'1" x 13'1"

The dining room is another good size reception room with space for a table and chairs, further furniture and window to the rear elevation.

Kitchen

11'9" x 5'10"

The kitchen is fitted with a range of wall, base and drawer units, complementing work surfaces, tiled splash backs and sink/drain unit. Space is available for further free standing appliances.

Master Bedroom

16'9" x 13'1"

The master bedroom provides space for a king sized bed, further furniture and window to the front elevation.

Bedroom Two

13'1" x 10'8"

The second bedroom is another double bedroom with window to the rear elevation.

Bathroom

9'6" x 5'10"

Fitted with a panelled bath, WC and wash hand basin. Opaque window to the side elevation.

External

Externally the property has an enclosed yard to the rear with outhouse and gated access into the back lane. To the front of the property on street parking is available.

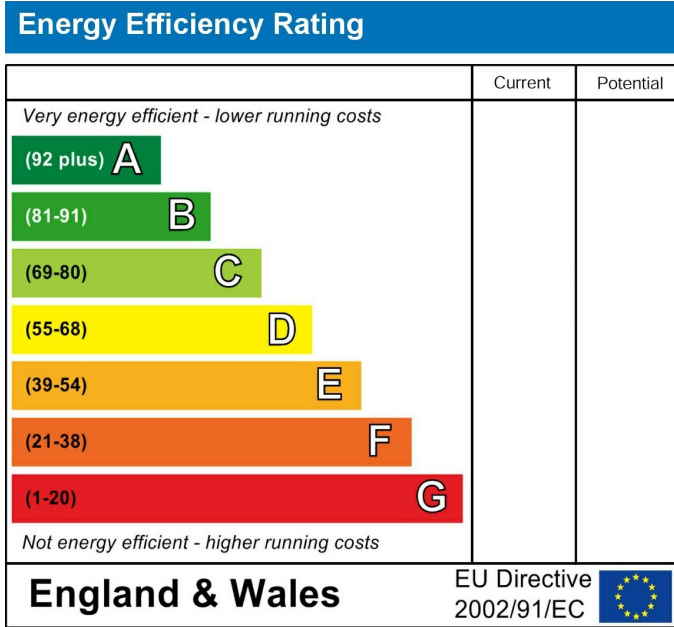

These particulars are intended to give a fair and reliable description of the property but no responsibility for any inaccuracy or error can be accepted and do not constitute an offer or contract. We have not tested any services or appliances (including central heating if fitted) referred to in these particulars and the purchasers are advised to satisfy themselves as to the working order and condition. If a property is unoccupied at any time there may be reconnection charges for any switched off/disconnected or drained services or appliances - All measurements are approximate. If you are thinking of selling your home or just curious to discover the value of your property, Hunters would be pleased to provide free, no obligation sales and marketing advice. Even if your home is outside the area covered by our local offices we can arrange a Market Appraisal through our national network of Hunters estate agents.



