



12 Burden Way, London

London

Guide Price £475,000



12 Burden Way

London, London

2-bed terraced house with cosy living room, double bedrooms, natural light, lovely garden, and convenient location near amenities and transport links.

Council Tax band: C

Tenure: Freehold

EPC Energy Efficiency Rating: D

EPC Environmental Impact Rating: D

- 2 Double Bedrooms
- Rear access
- Beautiful Garden



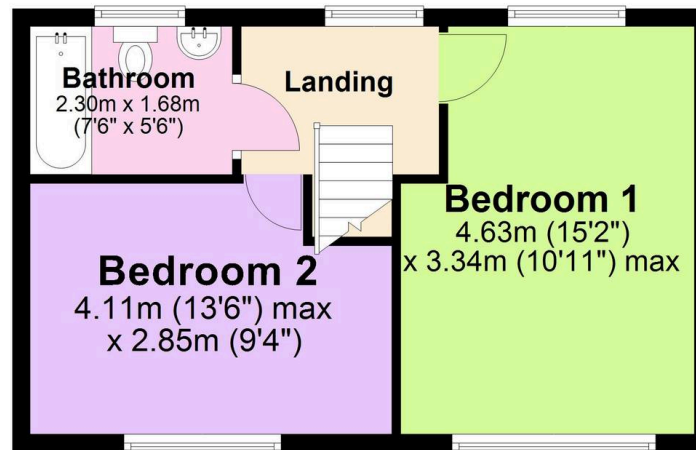
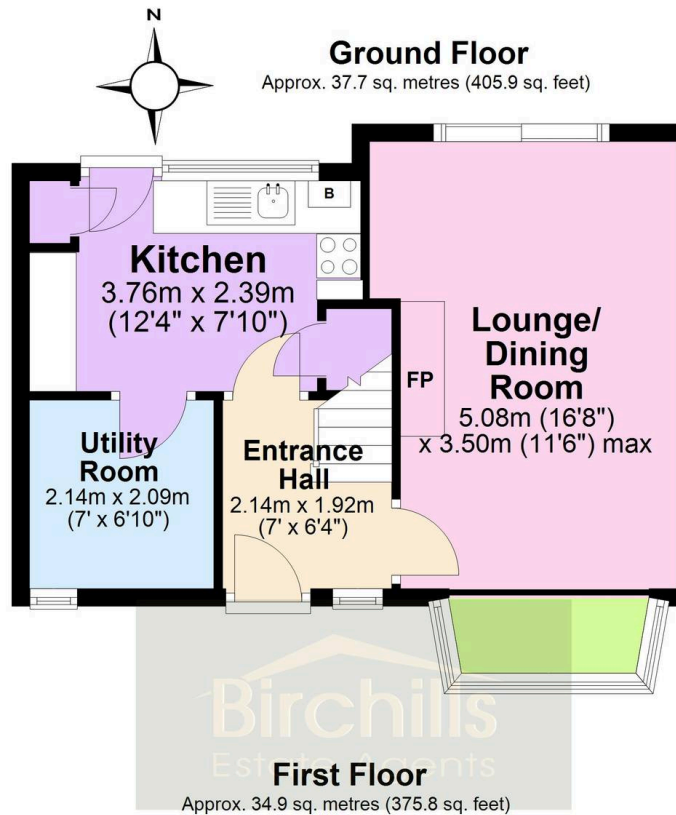

Total area: approx. 72.6 sq. metres (781.8 sq. feet)

Illustrations are for viewing purposes only. Measurements are not to scale. Property Total and Floor Totals are internal figures only and do not include Balconies, Garden, Patios or Terraces if shown. Floor Area of any Outbuilding may be included in overall Total.
Plan produced using PlanUp.