



Flat 3, Arlington House Regents Drive, Woodford Green

Woodford Green

Guide Price £635,000



Flat 3

Arlington House Regents Drive, Woodford Green

Council Tax band: G

Tenure: Share of Freehold

EPC Energy Efficiency Rating: C

EPC Environmental Impact Rating: C

- Allocated Gated Parking
- Duplex
- Prestigious Area (Repton Park)
- Long Lease
- Double Gated Development
- 2 Double Bedrooms
- 2 WCs
- 3D Tour Available



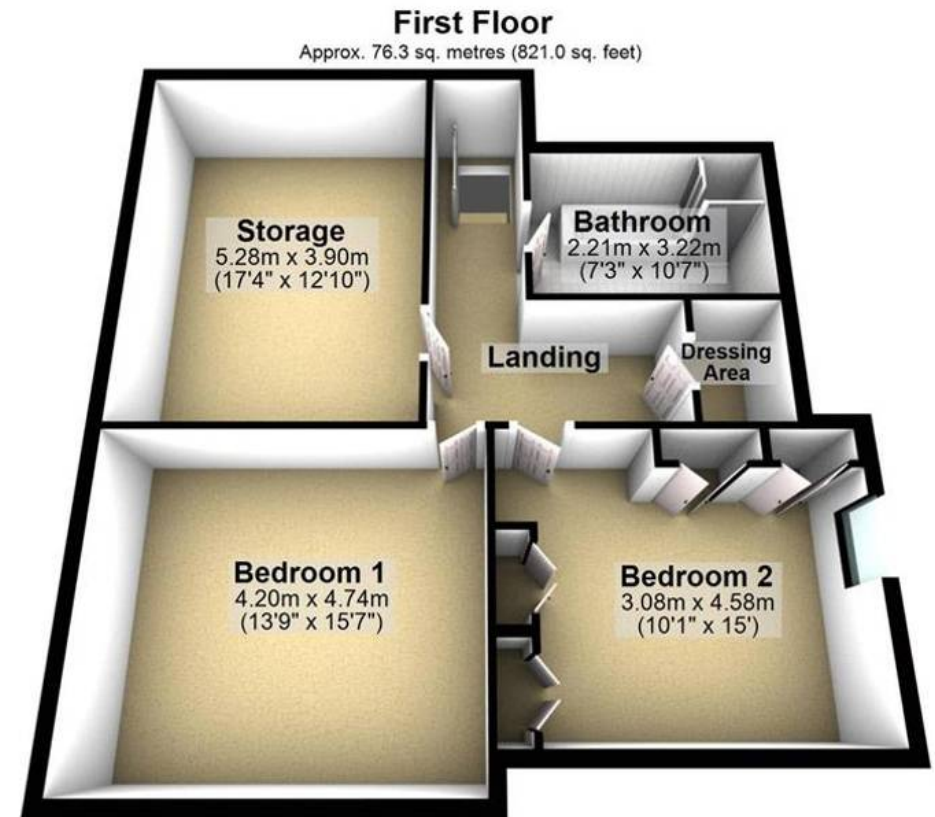
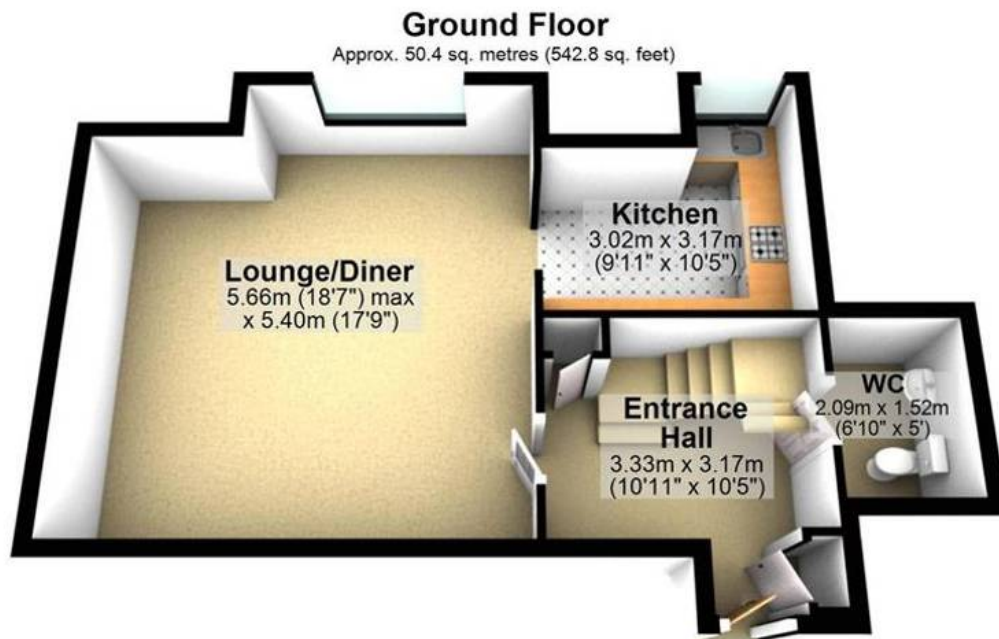

Total area: approx. 126.7 sq. metres (1363.8 sq. feet)