



**HUNTERS**<sup>®</sup>  
HERE TO GET *you* THERE





# Princes Terrace, Dymchurch Road, Hythe

Guide Price £250,000



GUIDE PRICE OF £250,000 - £270,000. This delightful terraced house presents an excellent opportunity for those seeking a comfortable family home or a sound investment. The property boasts three well-proportioned bedrooms, providing ample space for relaxation and rest. The single reception room offers a welcoming atmosphere, perfect for entertaining guests or enjoying quiet evenings with family.

The light and airy accommodation offers, entrance porch, sitting room and kitchen/dining room leading to rear garden. The rear garden is particular feature of the home and offers plenty space to entertain and is mainly laid to lawn and provides a blank canvass to create your own space.

Hythe is known for its picturesque surroundings and vibrant community, offering a range of local amenities, including shops, schools, and recreational facilities. The nearby coastline provides opportunities for leisurely walks and outdoor activities, enhancing the appeal of this lovely home.

This property is a wonderful canvas for personalisation, allowing new owners to infuse their style and preferences. With its prime location and potential, this terraced house is not to be missed. Whether you are looking to settle down in a friendly neighbourhood or seeking a property with great rental potential, this home in Hythe is sure to meet your needs.

The charming Cinque Ports Town of Hythe, with an attractive seafront, 3 supermarkets (including Waitrose, Sainsburys and Aldi) and busy High Street with a choice of interesting, independent shops and restaurants. There are a variety of sports and leisure facilities, including 2 golf courses and the Hotel Imperial Leisure Centre. The historic and picturesque Royal Military Canal, with pleasant walks and cycle path and seafront with long pebbly beach are also nearby. Visit the famous Romney Hythe and Dymchurch Steam Railway.

The area has easy access to the M20 motorway, with Dover Harbour a short distance away to pop across to France. While the high-speed service to London St. Pancras in approx 50 minutes can also be accessed from nearby Folkestone Central and West station.

Broadband - 7mb - 1000mb

Mobile Phone coverage - Okay to Good

Flood Risk - High



- NO ONWARD CHAIN
- THREE BEDROOM TERRACE HOME
  - ENTRANCE PORCH
  - KITCHEN/DINING ROOM
- GROUND FLOOR BATHROOM
- ENCLOSED REAR GARDEN
  - DOUBLE GLAZED
  - GAS CENTRAL HEATING

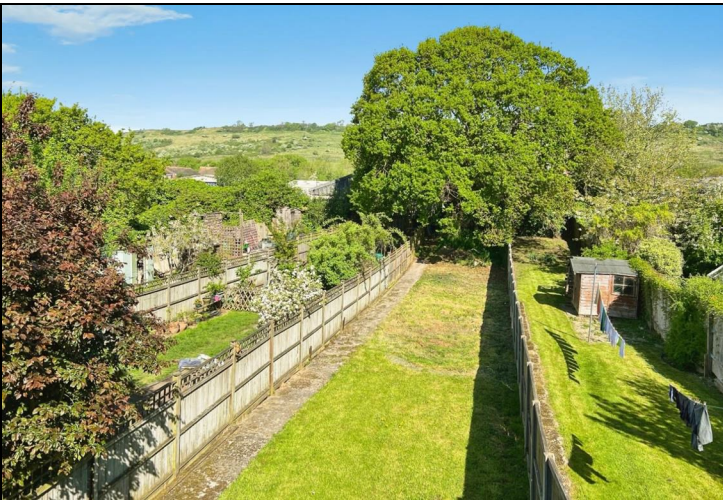















GROUND FLOOR

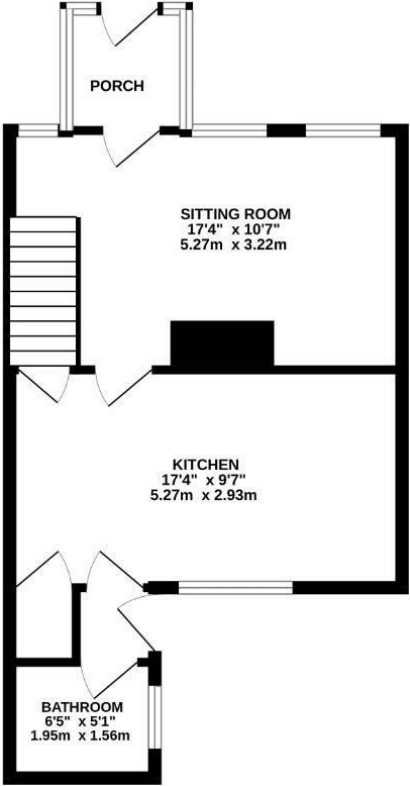

1ST FLOOR

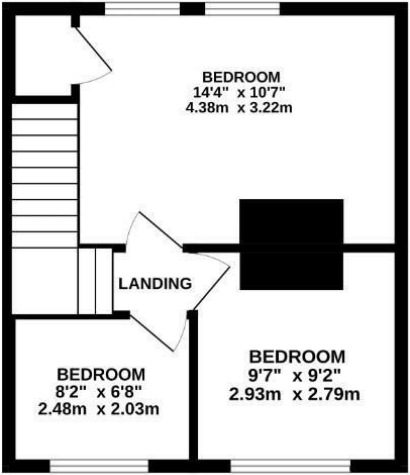

Whilst every attempt has been made to ensure the accuracy of the floorplan contained here, measurements of doors, windows, rooms and any other items are approximate and no responsibility is taken for any error, omission or mis-statement. This plan is for illustrative purposes only and should be used as such by any prospective purchaser. The services, systems and appliances shown have not been tested and no guarantee as to their operability or efficiency can be given.  
Made with Metropix 2025

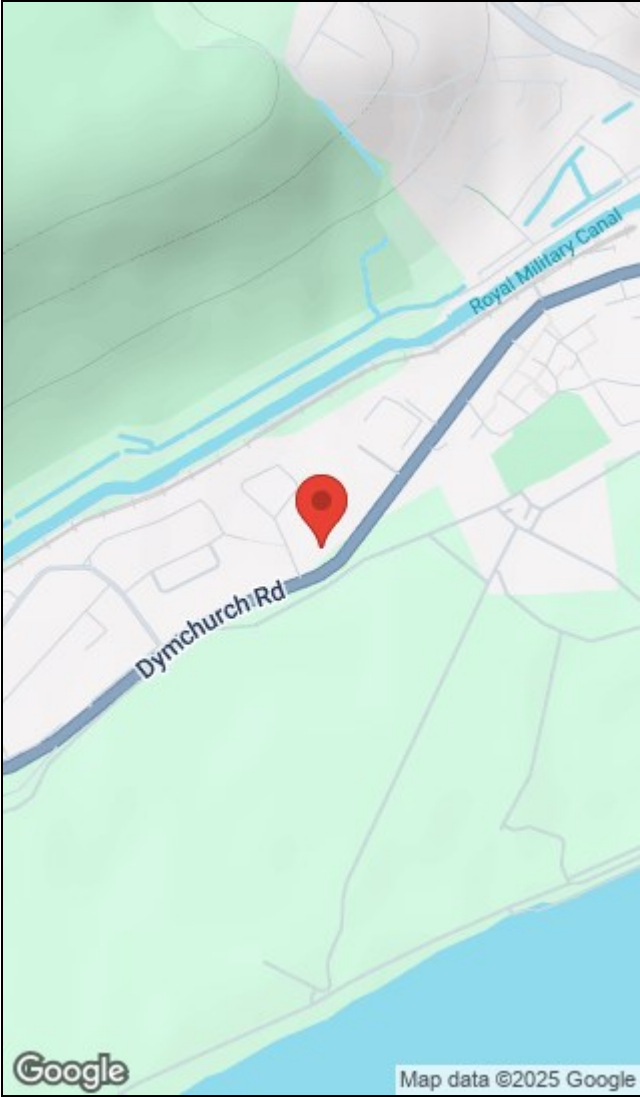

Energy Efficiency Rating		Environmental Impact (CO <sub>2</sub> ) Rating	
	Potential		Potential
Very energy efficient - lower running costs		Very environmentally friendly - lower CO <sub>2</sub> emissions	
(92 plus) <b>A</b>		(92 plus) <b>A</b>	
(81-91) <b>B</b>		(81-91) <b>B</b>	
(69-80) <b>C</b>		(69-80) <b>C</b>	
(55-68) <b>D</b>		(55-68) <b>D</b>	
(39-54) <b>E</b>		(39-54) <b>E</b>	
(21-38) <b>F</b>		(21-38) <b>F</b>	
(1-20) <b>G</b>		(1-20) <b>G</b>	
Not energy efficient - higher running costs		Not environmentally friendly - higher CO <sub>2</sub> emissions	
	65		
	88		
EU Directive 2002/91/EC		EU Directive 2002/91/EC	
England & Wales		England & Wales	

156a High Street, Hythe, Kent, CT21 6JU | 01303 261557  
hythe@hunters.com | www.hunters.com



This Hunters business is independently owned and operated by Black & White Estates Limited | Registered Address: 4 Middle Row, Ashford, Kent, TN24 8SQ | Registered Number: 7896701 England and Wales | VAT No: 973 6297 73 with the written consent of Hunters Franchising Limited.