



Willow Street, E4 7EG

PCM
£2,800 PCM

 Coultons

PROPERTY SUMMARY

3



1



1





GROUND FLOOR
627 sq ft. (58.2 sq.m.) approx.



1ST FLOOR
627 sq ft. (58.2 sq.m.) approx.

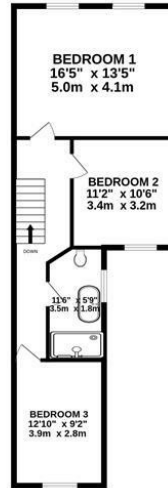

WILLOW STREET E4 7EG

TOTAL FLOOR AREA: 1253 sq ft. (116.4 sq.m.) approx.

Whilst every attempt has been made to ensure the accuracy of the floorplan contained here, measurements of doors, windows, rooms and any other items are approximate and no responsibility is taken for any error, omission or mis-statement. This plan is for illustrative purposes only and should be used as such by any prospective purchaser. The services, systems and appliances shown have not been tested and no guarantee as to their operability or efficiency can be given.
Made with Metropix 12/2014

LOCAL AUTHORITY

TENURE

COUNCIL TAX BAND

VIEWINGS

By prior appointment only

| Energy Efficiency Rating | | Current | Potential |
|---|----------------------------|---------|-----------|
| Very energy efficient - lower running costs | | | |
| (92 plus) A | | | |
| (81-91) B | | | |
| (69-80) C | | | |
| (55-68) D | | | |
| (39-54) E | | | |
| (21-38) F | | | |
| (1-20) G | | | |
| Not energy efficient - higher running costs | | | |
| England & Wales | EU Directive 2002/91/EC | | |

Agents Note: Whilst every care has been taken to prepare these particulars, they are for guidance purposes only. All measurements are approximate and are for general guidance purposes only and whilst every care has been taken to ensure their accuracy, they should not be relied upon and potential buyers/tenants are advised to recheck the measurements



OFFICE ADDRESS

26 Station Road
North Chingford
London
E4 7BE

020 8090 0860
lettings@coultons.co.uk
www.coultons.co.uk

OFFICE ADDRESS

425a Lordship Lane
Wood Green
London
N22 5DH

020 3869 8989
lettings@coultons.co.uk
www.coultons.co.uk