



27 Chorley Hall Lane, Alderley Edge, SK9 7EU

mosley jarman

27 Chorley Hall Lane, Alderley Edge, SK9 7EU

£515,000

- Two double bedrooms
- Two en-suite bathrooms
- Modern extended dining kitchen
- Original features
- South-facing rear patio
- Central Alderley Edge spot
- Walk to train station
- Near local bars and eateries
- Close to schools and park
- Viewing highly recommended



27 Chorley Hall Lane, Alderley Edge, SK9 7EU

£515,000



Nestled in the heart of Alderley Edge, this charming two-bedroom, two-bathroom mid terraced house on Chorley Hall Lane offers a delightful blend of period features and modern living. The property is ideally situated within walking distance of the train station, local parks, vibrant bars, restaurants, and reputable schools, making it perfect for families and professionals alike.

As you enter, you are greeted by an entrance hall that leads to a spacious living room, complete with built in storage cupboard in the alcove. The heart of the property is undoubtedly the modern living dining kitchen, which has been thoughtfully extended to create a bright and airy space. The original fireplace with tiled surround and slate hearth adds to the original charm of the property. The kitchen boasts a rain sensor electric Velux window and bifolding doors that open onto a south-facing rear patio, perfect for enjoying sunny afternoons and entertaining guests.

The two double bedrooms are generously sized, each featuring fitted storage to maximise space and convenience. Both bedrooms benefit from their own ensuite bathrooms, with one also featuring a Velux window, ensuring ample natural light throughout.

Additionally, the property includes a cellar with a utility cupboard and a convenient w.c., providing extra storage and functionality.

The property benefits from plantation shutters in multiple rooms and air conditioning in the living dining kitchen & principle bedroom. This delightful home combines the charm of its period style with the comforts of modern living, making it an ideal choice for those seeking a stylish and convenient lifestyle in one of Cheshire's most sought-after locations. Don't miss the opportunity to make this lovely property your new home.



BASEMENT LEVEL

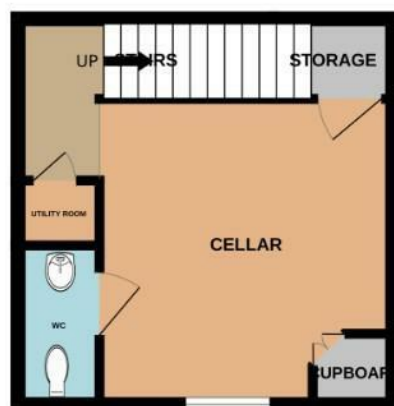

GROUND FLOOR

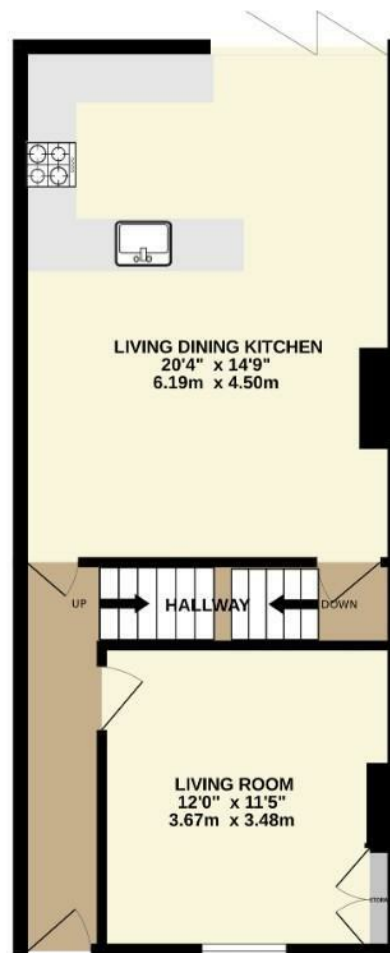

1ST FLOOR



TOTAL FLOOR AREA : 1149 sq.ft. (106.7 sq.m.) approx.

Whilst every attempt has been made to ensure the accuracy of the floorplan contained here, measurements of doors, windows, rooms and any other items are approximate and no responsibility is taken for any error, omission or mis-statement. This plan is for illustrative purposes only and should be used as such by any prospective purchaser. The services, systems and appliances shown have not been tested and no guarantee as to their operability or efficiency can be given.

Made with Metropix ©2025

44 Alderley Road, Wilmslow, Cheshire SK9 1NY
Tel: 01625 444 899 Email: wilmslow@mosleyjarman.co.uk
www.mosleyjarman.co.uk

PROPERTY MISDESCRIPTION ACT 1991: The Agents has not tested any apparatus, equipment, fixtures and fittings, or services, so cannot verify that they are in working order or fit for the purpose. the buyer is advised to obtain verification from his or her Professional Buyer. References to the tenure of the proeprty are baed on information supplied by the Vendor. The agents have not had sight of the title documents. The buyer to obtain verification from their Solicitor. You are advised to check the availability of any property before travelling any distance to view.

