



19 Chestnut Close, Wilmslow, Cheshire, SK9 2NT

*mosley jarman* &



19 Chestnut Close, Wilmslow, Cheshire, SK9 2NT

**£1,250 Per Calendar Month**

- End mews home in sought after and convenient location
- Close to local amenities and the A34
- Three ground floor bedrooms
- Bathroom with shower over the bath
- Light and airy open-plan living room on the first floor
- Fitted kitchen with washing machine, fridge freezer, oven and hob
- Parking to the front. Enclosed gardens to the rear
- Gas central heating and double-glazing
- EPC rating: D
- Council Tax band: C (Cheshire East)



19 Chestnut Close, Wilmslow, Cheshire, SK9 2NT

**Per Calendar Month £1,250 Per Calendar Month**



Enjoying a position within a sought after residential location, this end mews home would make an ideal home for a couple of young family alike. An entrance hall provides access to three ground floor bedrooms and a bathroom with three piece suite and shower unit over the bath. A stairway leads up to the first floor and a light and airy open-plan living room. A fitted kitchen provides storage cupboards and drawers along with a washing machine, fridge/freezer, oven and hob. Gas central heating and double-glazing. To the front the property offers off-road parking for one car. There is an enclosed garden to the rear with paved patio area. UNFURNISHED. AVAILABLE: IMMEDIATELY.

#### IMPORTANT INFORMATION

Parking - Off road parking via a driveway to the front of the property

Heating - Gas central heating

Mains - Gas, Electric and Water

Refuse - Cheshire East Council operate a chargeable garden waste disposal service. For full details please visit [cheshireeast.gov.uk/gardenbin](http://cheshireeast.gov.uk/gardenbin)

Broadband providers - Openreach. You may also be able to obtain broadband service from these Fixed Wireless Access providers covering your area for EE and Three

Mobile providers - Likely coverage by EE, O2, Three and Vodafone

\*Broadband and mobile providers information taken from the Ofcom mobile and broadband checker





GROUND FLOOR  
332 sq.ft. (30.8 sq.m.) approx.

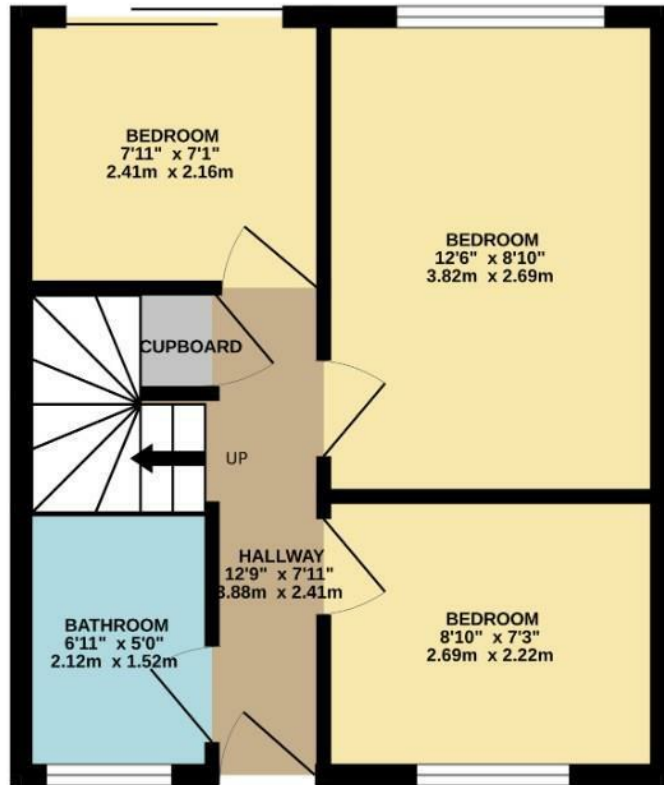

1ST FLOOR  
332 sq.ft. (30.8 sq.m.) approx.

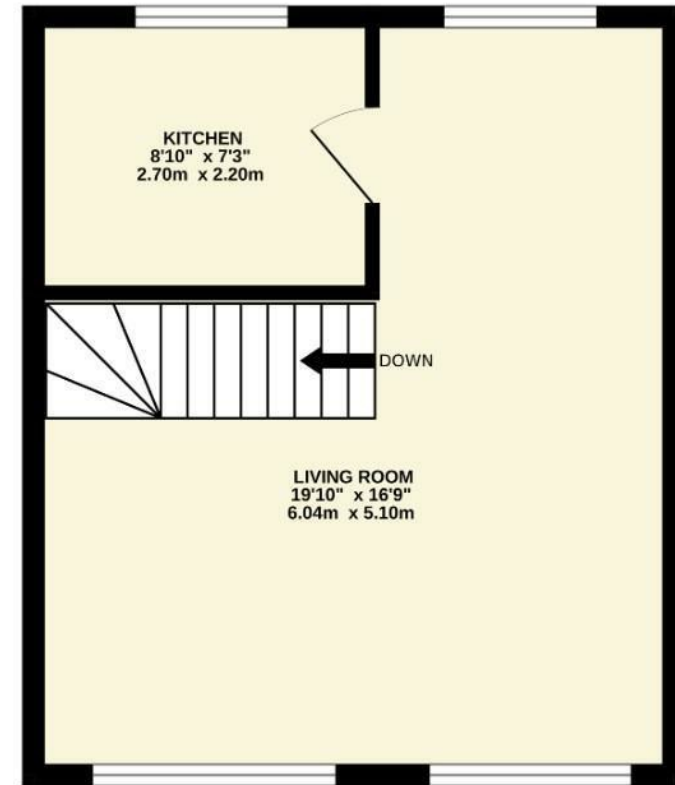

TOTAL FLOOR AREA : 663 sq.ft. (61.6 sq.m.) approx.

Whilst every attempt has been made to ensure the accuracy of the floorplan contained here, measurements of doors, windows, rooms and any other items are approximate and no responsibility is taken for any error, omission or mis-statement. This plan is for illustrative purposes only and should be used as such by any prospective purchaser. The services, systems and appliances shown have not been tested and no guarantee as to their operability or efficiency can be given.  
Made with Metropix ©2024