



## 332 Whitchurch Road

Heath, Cardiff, CF14 3NG

**£1,250 Per Month**

REF: 19352571

PHYSICAL AND ONLINE VIEWING AVAILABLE!!

2 BEDROOM FIRST FLOOR FLAT - £1250PCM -  
AVAILABLE 1ST JULY 2025 - FULLY FURNISHED - BILLS  
EXCLUDED - PROFESSIONALS AND STUDENTS  
WELCOME

- 2 Bedroom First Floor Flat
- £1250pcm
- Available 1st July 2025
- Fully Furnished
- Bills Excluded
- Students & Professionals Welcome
- Contract until 30th June 2026
- Deposit: £1,350

### Viewing

Please contact our Cathays Head Office Office on 02922331425 if you wish to arrange a viewing appointment for this property or require further information.

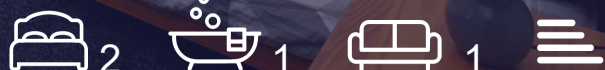



Floor Plan

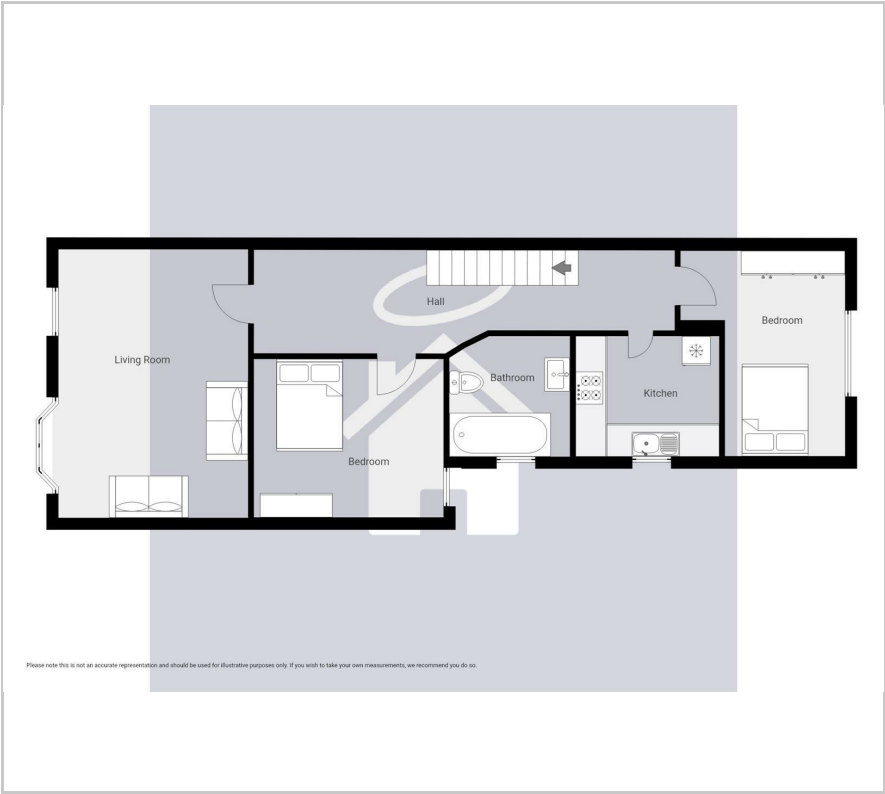

Area Map

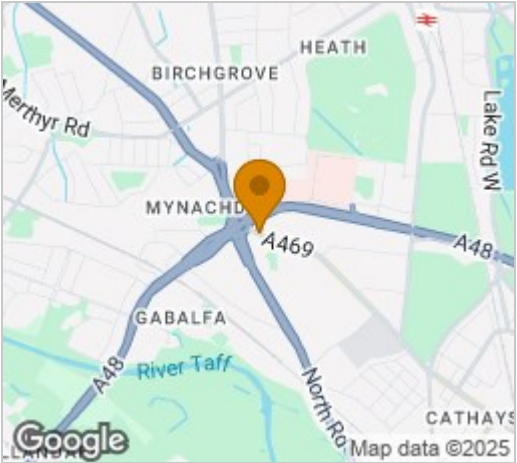

Energy Efficiency Graph

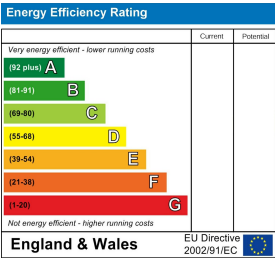

These particulars, whilst believed to be accurate are set out as a general outline only for guidance and do not constitute any part of an offer or contract. Intending purchasers should not rely on them as statements of representation of fact, but must satisfy themselves by inspection or otherwise as to their accuracy. No person in this firm's employment has the authority to make or give any representation or warranty in respect of the property.