



SCAN ME



Apartment

Beds 1, Baths 1, Lounges 1



Hepple Close, Isleworth, TW7

£250,000 Leasehold

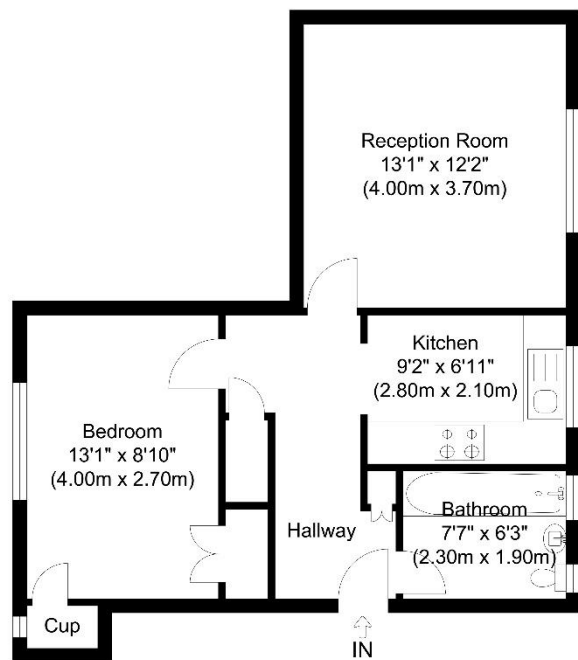

Total Gross Internal Area
498.15 sq. ft.
(46.28 sq. m)

Hepple Close, Isleworth, TW7

Illustration for identification purposes only, measurements are approximate, not to scale.



Property Description

Property Description - A ground floor apartment set on a private road off Park Road in Old Isleworth. Features include 965 yr + lease, allocated parking space, landscaped communal gardens, near Syon Lane Train as well as Syon park and Old Isleworth Riverside.

Accommodation - The accommodation comprises building entrance with secure entry phone system leading to into communal hallway. This then leads to the front door and into a long hallway entrance which has an airing cupboard and a deep storage cupboard. From there you have good size lounge. Separate fitted kitchen along two walls with appliances. Bedroom with two built in cupboards. Finally there is a three piece bathroom which is fully tiled.

Outside Areas - To the outside the property benefits from beautifully kept landscaped communal gardens all around, there is also allocated parking in a courtyard outside.

Transport Links & Nearby - Set a quiet road off Park Road you are within walking distance of Syon Lane National Rail nearby whilst the grounds at Syon Park and Old Isleworth Riverside are a short walk away. Finally Brentford and Hounslow Town Centres area short bus journey away as well as the shops at Isleworth Village.

Additional Information - Property: Tenure – Leasehold, Lease length 969 years unexpired. Ground Rental £NIL per annum. Service charge £1942.44 per annum. Council Tax - Band C (London Borough of Hounslow) £1672 per annum. EPC rating - D.



Woodlands Estates,
16 St Johns Road, Isleworth,
Middlesex, TW7 6NW

www.woodlandsestates.com
020 8560 3228
mail@woodlandsestates.com

Agents Note: Whilst every care has been taken to prepare these sales particulars, they are for guidance purposes only. All measurements are approximate are for general guidance purposes only and whilst every care has been taken to ensure their accuracy, they should not be relied upon and potential buyers are advised to recheck the measurements.

Follow us on Social Media

