



Offered TO LET is this deceptively sized refurbished FOUR-bedroom end of terrace property. This home offers entrance hallway, lounge, huge brand-new kitchen/diner with washing machine and fridge/freezer, modern replaced bathroom, Upvc double glazing, gas radiator heating. AVAILABLE NOW!! DONT LOSE OUT ON THIS HOME, BOOK YOUR APPOINTMENT NOW!!

Price Monthly Rental Of £1,300



GROUND FLOOR
357 sq.ft. (33.1 sq.m.) approx.

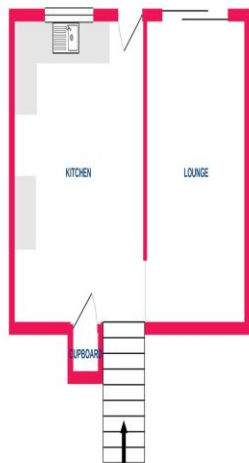

1ST FLOOR
254 sq.ft. (23.6 sq.m.) approx.

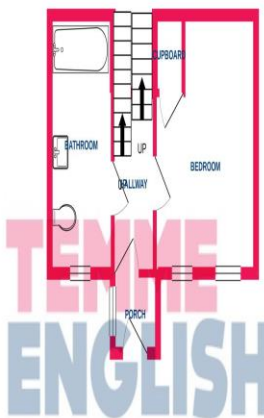

2ND FLOOR
350 sq.ft. (32.5 sq.m.) approx.

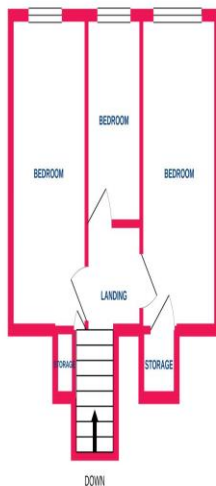

TEMME
ENGLISH

TOTAL FLOOR AREA : 961 sq.ft. (89.2 sq.m.) approx.

Whilst every attempt has been made to ensure the accuracy of the floorplan contained here, measurements of doors, windows, rooms and any other items are approximate and no responsibility is taken for any error, omission or mis-statement. This plan is for illustrative purposes only and should be used as such by any prospective purchaser. The services, systems and appliances shown have not been tested and no guarantee as to their operability or efficiency can be given.
Made with Mienpro ©2020

- **AVAILABLE NOW!!!**
- **Entrance Hall 8'3 x 7'4**
- **Lounge 14'4 x 10'3**
- **Brand New Kitchen/Diner 14'4 x 13'7**
- **Brand New Bathroom 11'5 x 6'0**
- **Bedroom One 14'4 x 10'9**
- **Bedroom Two 14'3 x 8'0**
- **Bedroom Three 11'8 x 10'5>7'8**
- **Bedroom Four 11'6 x 5'6**
- **Upvc Double Glazing, Gas Radiator Heating.**

