



Offered To Let is this wonderful two bedroom Couch House. This property offer's ground floor entrance, large-impressive lounge/diner, fitted modern kitchen with cooker and hob, family bathroom, Upvc double glazing, gas radiator heating, two allocated parking spaces and with walking distance of Laindon Stations.

Price Monthly Rental Of £1,100



FIRST FLOOR

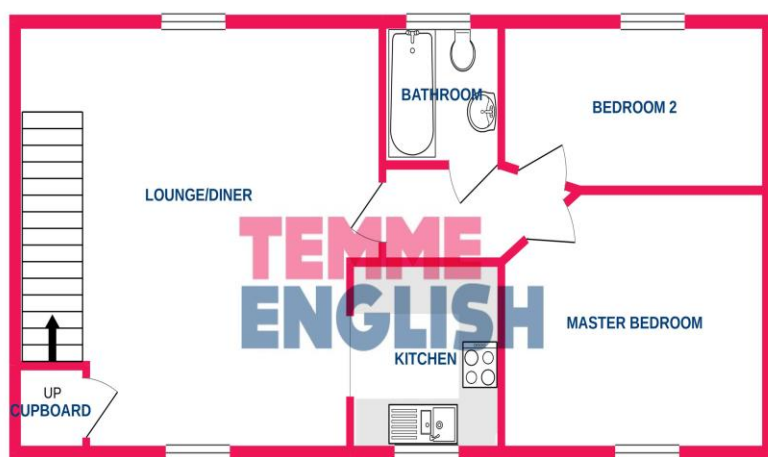

Whilst every attempt has been made to ensure the accuracy of the floorplan contained here, measurements of doors, windows, rooms and any other items are approximate and no responsibility is taken for any error, omission or mis-statement. This plan is for illustrative purposes only and should be used as such by any prospective purchaser. The services, systems and appliances shown have not been tested and no guarantee as to their quality or efficiency can be given.
Made with Metropix 03/2020

- **Stunning Two Bedroom Coach House**
- **Excellent Condition Throughout!**
- **AVAILABLE SOON!!**
- **Spacious Lounge Diner 18 x 12'11**
- **Stylish Kitchen 7'9 x 7'5**
- **Master Bedroom 13'10 x 10'7**
- **Bedroom Two 13'8 x 7'1**
- **Modern Bathroom 6'11 x 5'8**
- **Two Allocated Parking Bays Plus Ample Ground Floor Storage Cupboard**
- **Popular Dunton Fields Location Close To The A127 & Laindon Train Station**

