

HUNTERS®

HERE TO GET *you* THERE

Granville Square, London, SE15 6DX

Guide Price £375,000 to £400,000

Property Images



HUNTERS[®]

HERE TO GET *you* THERE

Property Images



Granville Square, SE15 6DX

Approx. Gross Internal Area 565 Sq Ft - 52.49 Sq M

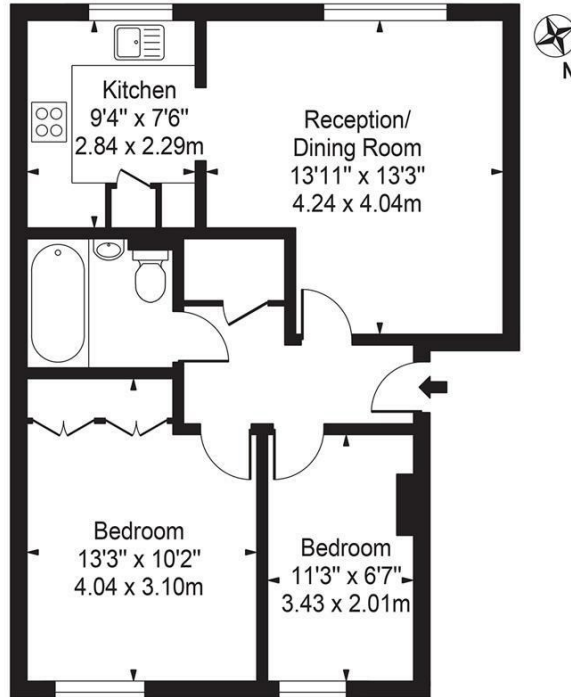

Second Floor

For Illustration Purposes Only - Not To Scale - Floor Plan by interDesign Photography

www.interdesignphotography.com

This floor plan should be used as general outline for guidance only.
All measurements are approximate and for illustration purposes only as defined by the RICS Code of Measuring Practice ©2016.

EPC

Energy Efficiency Rating		Current	Potential
<i>Very energy efficient - lower running costs</i>			
(92 plus) A			
(81-91) B		82	83
(69-80) C			
(55-68) D			
(39-54) E			
(21-38) F			
(1-20) G			
<i>Not energy efficient - higher running costs</i>			
England & Wales	EU Directive 2002/91/EC		

Map



Details

Type: Flat Beds: 2 Bathrooms: 1 Receptions: 1 Tenure: Leasehold

Summary

Guide Price £375,000 to £400,000 - new to market is this two bedroom apartment situated in Peckham. Spanning approximately 580 sqft and offering two double bedrooms, an open-plan living room and kitchen and a family bathroom this property would be perfect for a family home.

Features

• Guide Price £375,000 to £400,000 • Open-Plan Living Room/Kitchen • Allocated Parking • Secure Entry • Contemporary Bathroom • Proximity To Transport • 560 Sqft Approx • B EPC Rating • In proximity of coffee shops, restaurants and shops • Lots of parks, open and green spaces locally

EPC B

COUNCIL TAX BAND D

LEASEHOLD

Guide Price £375,000 to £400,000

Set on the second-floor of this popular residential block and in proximity of Peckham Rye station is this 2-bed apartment. Offered in good condition, spanning approximately 580sqft and offering two double bedrooms, a larger than average living room, a separate kitchen and a family bathroom this property would be perfect for a family home. The property also benefits from secure off-street parking and also substantial Communal Gardens.

Granville Square is very well located and residents are able to enjoy a plethora of bars, restaurants and coffee shops as well as extensive parks and open green spaces.

Nearby Peckham Rye station offers train services into London Victoria and London Bridge.

The property is offered with no onward chain and early viewing is advised.

Schools:

There are 3 schools that are in proximity:

Angel Oak Academy.

HUNTERS®

HERE TO GET *you* THERE

Michael Faraday
Brunswick Park

Transport:

Peckham Rye
Denmark Hill
Queens Road Peckham

There are also multiple buses serving surrounding areas and also the City of London

Recreation and Amenities:

Burgess Park offers lots of open green spaces and a lake for walks and family days out

There is also a Plethora of Boutique Coffee Shop, Restaurants and Bars to be enjoyed locally.