



HUNTERS[®]

HERE TO GET *you* THERE

7 The Finches, Portishead, Bristol, BS20 7NE

7 The Finches, Portishead, Bristol, BS20 7NE

£475,000

Being offered with NO CHAIN this enticing detached house is now available for sale in a sought-after location. The property comes in good condition, ready for a family to move in and make it their own. With close proximity to local amenities, green spaces, and nearby schools, it's ideally positioned for families seeking a blend of convenience and tranquillity.

The house features a wealth of space and versatility, offering two reception rooms. These are perfect for entertaining or creating dedicated spaces for work, leisure, or study. A well-appointed kitchen adds to the functionality of the home.

In addition, the property boasts four generously sized bedrooms, providing ample space for a growing family or guests. The master bedroom also has an en-suite shower room. As well as the two bathrooms there is a downstairs W/C, reducing the morning rush and allowing for private spaces for everyone in the home.

One of the unique features is a good sized and well maintained enclosed garden, offering a private outdoor space to enjoy during the warmer months. The property also benefits from a single garage.

In conclusion, this house is a perfect wonderful opportunity for families seeking a comfortable and spacious home in a desirable neighbourhood. Please contact us to arrange a viewing or for further information.

Hunters Bishopsworth 25 Highridge Road, Bristol, BS13 8HJ | 0117 244 4441
bishopsworth@hunters.com | www.hunters.com



Ground Floor
Floor area 47.9 m² (516 sq.ft.)

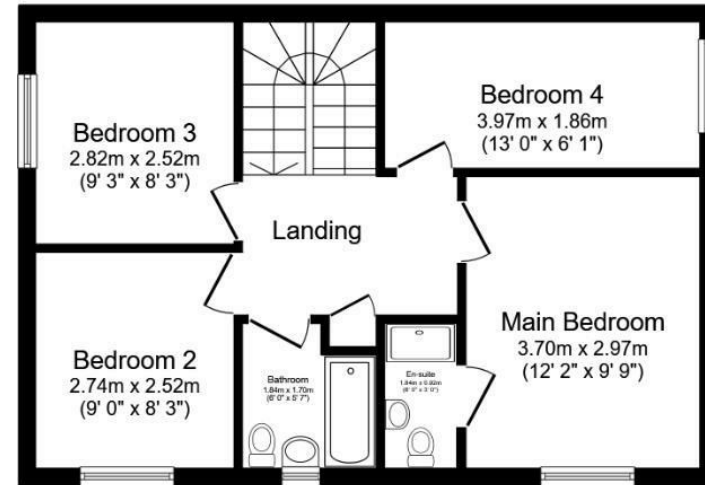

First Floor
Floor area 47.6 m² (513 sq.ft.)

TOTAL: 95.6 m² (1,029 sq.ft.)

This floor plan is for illustrative purposes only. It is not drawn to scale. Any measurements, floor areas (including any total floor area), openings and orientations are approximate. No details are guaranteed, they cannot be relied upon for any purpose and do not form any part of any agreement. No liability is taken for any error, omission or misstatement. A party must rely upon its own inspection(s). Powered by www.Propertybox.io

