



# 23 Ross Way

Knightsridge, Livingston, EH54 8LA

**SNEDDON  
MORRISON**  
SOLICITORS & ESTATE AGENTS







## Property Summary

Welcome to an executive four-bedroom detached house which forms part of a family-friendly neighbourhood in the Knightsridge area of Livingston. This beautiful home is attractively presented throughout and it offers lots of space too, featuring three reception areas (including a conservatory), a stylish breakfasting kitchen, as well as an en-suite, a family bathroom, and a separate WC. Furthermore, it has ample private parking and a fully-enclosed rear garden, which enjoys an easy-to-maintain design, laid with a timber deck and artificial lawn – perfect for relaxing in the sun.

Extras: all fitted floor and window coverings, light fittings, integrated appliances (five-burner gas hob, double oven, microwave, dishwasher, fridge, and freezer), and an undercounter washing machine to be included in the sale.



## Property Features

- Large detached house in excellent decorative order
- Set on a no-through road in popular Knightsridge
- Welcoming entrance hall with a convenient WC
- South-facing living room with box bay window
- Good-size dining room adjacent to the kitchen
- Versatile conservatory with rear garden access
- Modern, Shaker-inspired breakfasting kitchen
- Bright landing with airing cupboard and attic access
- Three double bedrooms with built-in wardrobes
- One versatile bedroom with built-in storage
- Quality three-piece en-suite shower room
- Contemporary three-piece family bathroom
- Carefully maintained front and rear gardens
- Private front driveway and integrated garage
- Gas central heating and double-glazed windows
- EPC Rating - C









South-facing living room with  
box bay window and a  
good-size dining room  
adjacent to the kitchen











Three double bedrooms with  
built-in wardrobes and  
one versatile bedroom with  
built-in storage









# Floorplan

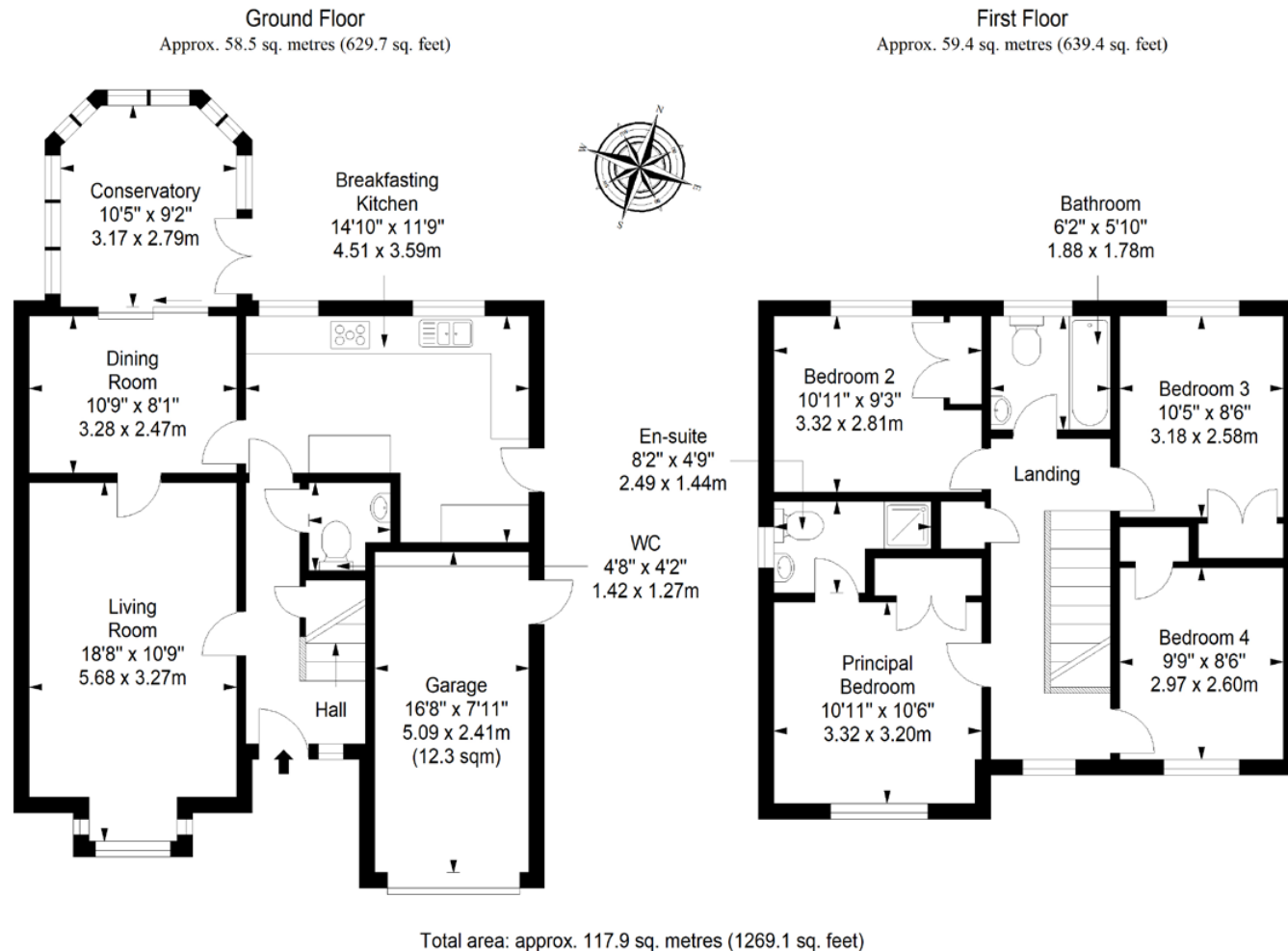

## All Enquiries to our Property Department:

01506 815832 | [afton.henderson@sneddons-ssc.co.uk](mailto:afton.henderson@sneddons-ssc.co.uk) | [www.sneddonmorrison.co.uk](http://www.sneddonmorrison.co.uk)  
14 East Main Street, Whitburn, West Lothian EH47 0RB

IMPORTANT: The selling agents for themselves and for the sellers of the above property give notice that these particulars are for guidance only and their accuracy is not guaranteed. These particulars will not form part of any contract and interested parties should satisfy themselves in all aspects prior to submitting offers. The sellers do not bind themselves to accept the highest offer. S1106