



27 Mathers Avenue

Whitburn, Bathgate, West Lothian, EH47 0NA



Property Summary

This two-bedroom semi-detached house occupies a generous corner plot, with private parking and low-maintenance enclosed gardens that are favourably south-facing. The property will no doubt appeal to professionals, young families, and investors, owing to its quiet location with easy access to local supermarket shopping and schools, as well as the M8 for swift commuting to Glasgow and Edinburgh which are equidistant from this small town setting and accessible in under 45 minutes.

Extras: All fitted floor and window coverings and light fittings are included.

Property Features

- Quiet small town setting
- Semi-detached house on a large corner plot
- Bright entrance hall with storage
- Spacious living room
- Breakfasting kitchen with garden access
- Two spacious double bedrooms (one with storage)
- Bright bathroom
- Enclosed south-facing gardens on three sides
- Private driveway
- Gas central heating and double glazing
- EPC Rating - D



Floorplan

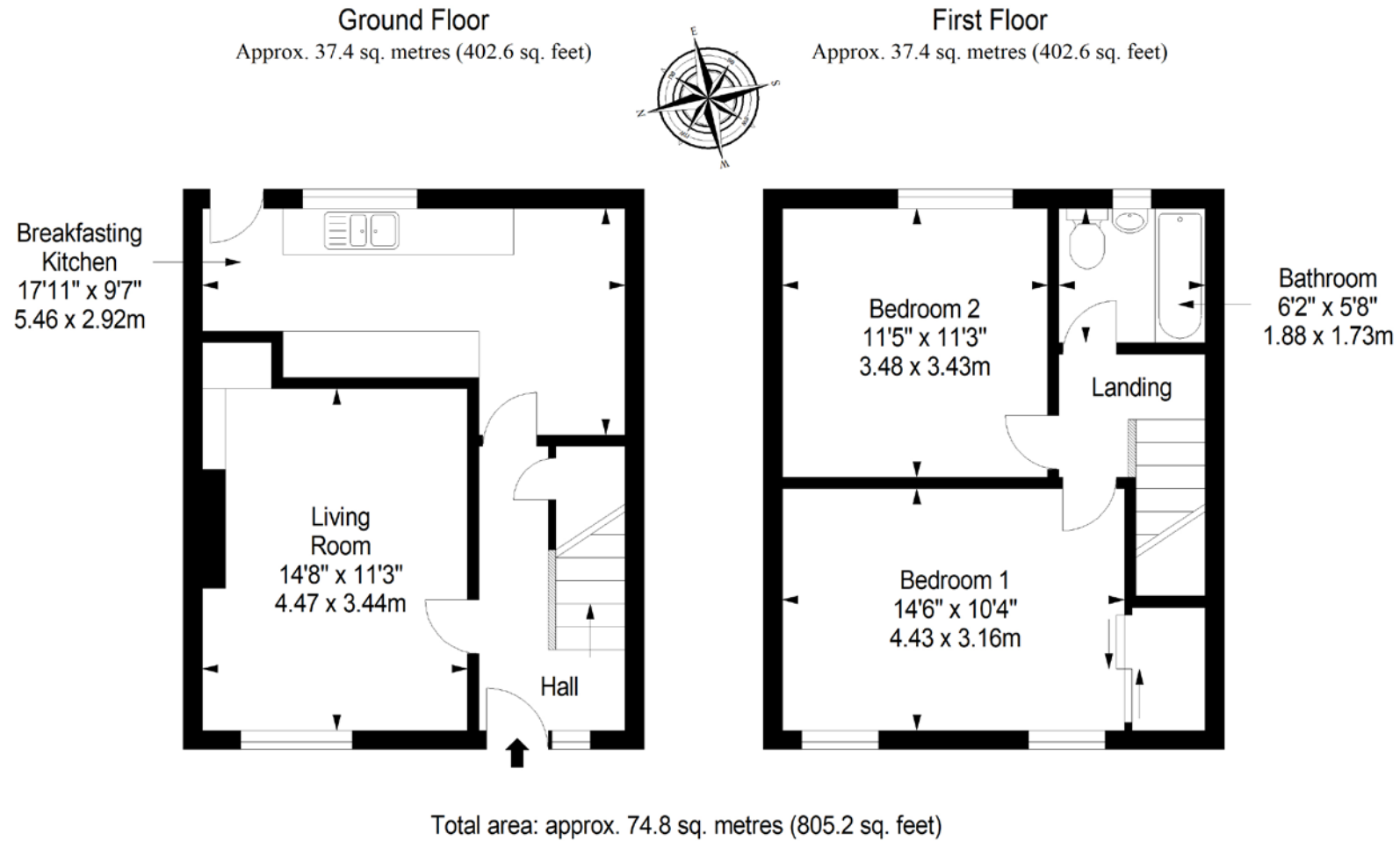

All Enquiries to our Property Department:

01506 815832 | afton.henderson@sneddons-ssc.co.uk | www.sneddonmorrison.co.uk
14 East Main Street, Whitburn, West Lothian EH47 0RB

IMPORTANT: The selling agents for themselves and for the sellers of the above property give notice that these particulars are for guidance only and their accuracy is not guaranteed. These particulars will not form part of any contract and interested parties should satisfy themselves in all aspects prior to submitting offers. The sellers do not bind themselves to accept the highest offer. S1106