

HoldenCopley

PREPARE TO BE MOVED

Elwes Lodge, Carlton, Nottinghamshire NG4 IDX

Guide Price £97,000

Elwes Lodge, Carlton, Nottinghamshire NG4 1DX



SIMPLY STUNNING!

This first floor maisonette is a true credit to its current owners who have transformed it into a stunning home. The property has a great sized lounge diner with feature lighting and access to a balcony offering stunning views. The kitchen is stylish and contemporary with feature lighting. There are also two double bedrooms and a modern bathroom suite. This property is presented to standard and ready to move straight into. It must be viewed to be fully appreciated.

360° Virtual Tour Available





- First Floor Maisonette
- Contemporary & Stylish Kitchen
- Great Sized Lounge Diner
- Stunning Bathroom
- Balcony
- Feature Lighting
- Presented To A High Standard
- Two Bedrooms
- Perfect First Time Buy
- Leasehold





ACCOMMODATION:

Entrance Hall

The hall has a UPVC door, laminated flooring, recessed spotlights and provides access to the accommodation

Living Room

15'8" x 12'1" (4.80 x 3.70)

The living room has a TV point, laminated flooring, a radiator, recessed spotlights and double glazed patio doors leading to the balcony

Kitchen

9'6" x 8'2" (2.90 x 2.50)

The kitchen has a range of base and wall units, a sink and a half with drainer and mixer taps, an integrated oven, hob, extractor fan, space for a fridge freezer, space and plumbing for a washing machine, recessed spotlights, laminated flooring and a double glazed window

Master Bedroom

11'1" x 8'10" (3.40 x 2.70)

The main bedroom has a double glazed window, a radiator and recessed spotlights

Bedroom Two

8'6" x 8'2" (2.60 x 2.50)

The second bedroom has a double glazed window, a radiator and recessed spotlights

Bathroom

7'6" x 5'6" (2.30 x 1.70)

The bathroom has a 'P' shaped bath with mains fed shower over, hand basin with vanity storage, low level flush WC, chrome heated towel rail, recessed spotlights and a double glazed window

Disclaimer

Agents Disclaimer: HoldenCopley, their clients and employees I: Are not authorised to make or give any representations or warranties in relation to the property either here or elsewhere, either on their own behalf or on behalf of their client or otherwise. They assume no responsibility for any statement that may be made in these particulars. These particulars do not form part of any offer or contract and must not be relied upon as statements or representations of fact. 2: Any areas, measurements or distances are approximate. The text, photographs and plans are for guidance only and are not necessarily comprehensive. It should not be assumed that the property has all necessary planning, building regulation or other consents and HoldenCopley have not tested any services, equipment or facilities. Purchasers must make further

investigations and inspections before entering into any agreement.

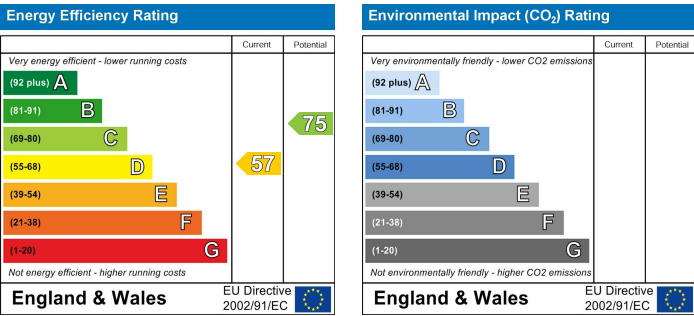

Elwes Lodge, Carlton, Nottinghamshire NG4 IDX

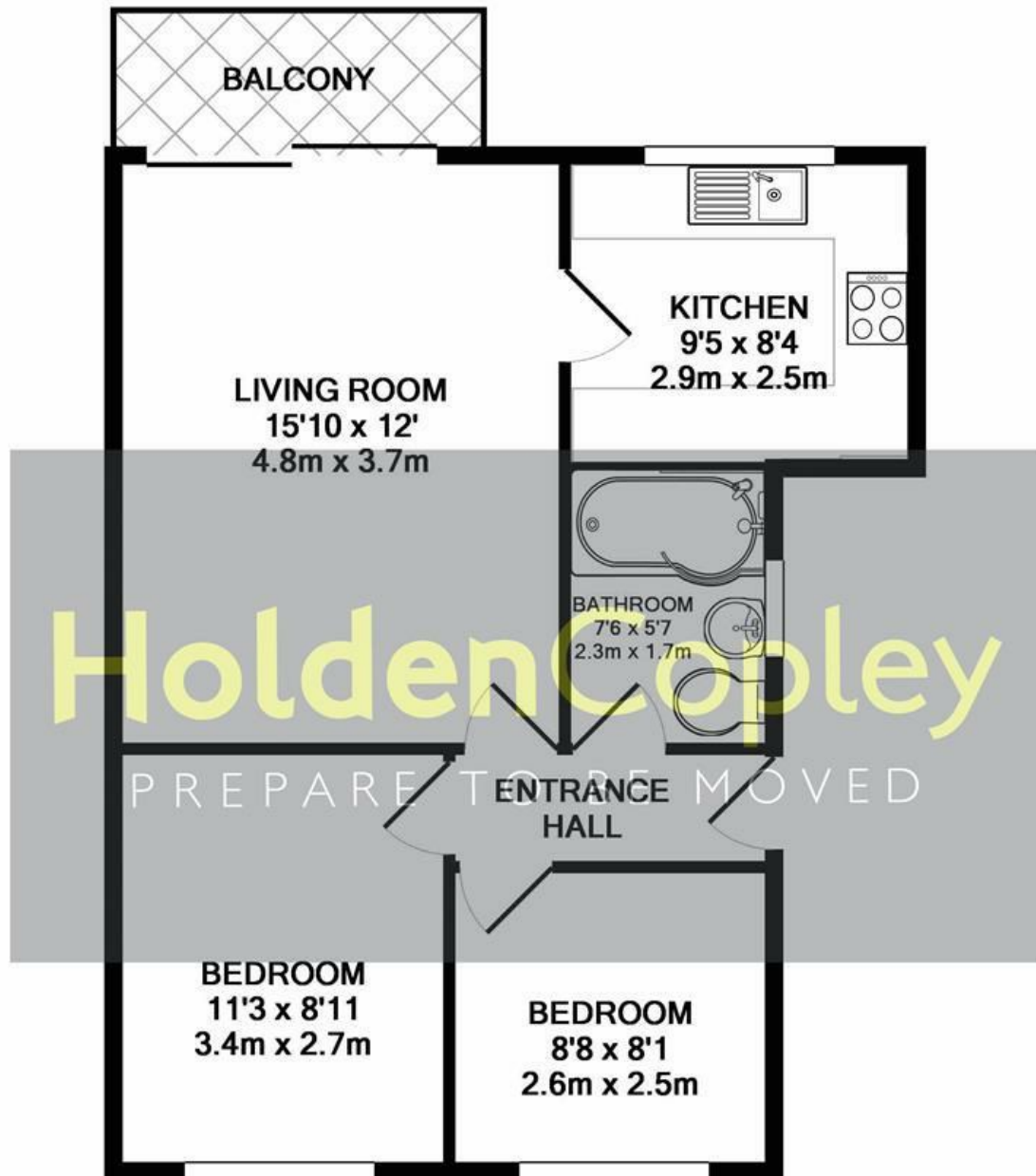

TOTAL APPROX. FLOOR AREA 509 SQ.FT. (47.2 SQ.M.)

Whilst every attempt has been made to ensure the accuracy of the floor plan contained here, measurements of doors, windows, rooms and any other items are approximate and no responsibility is taken for any error, omission, or mis-statement. This plan is for illustrative purposes only and should be used as such by any prospective purchaser. The services, systems and appliances shown have not been tested and no guarantee as to their operability or efficiency can be given

Made with Metropix ©2018

0115 8969 800

26 High Street, Arnold, Nottinghamshire, NG5 7DZ

sales@holdencopley.co.uk

www.holdencopley.co.uk

Agents Disclaimer: HoldenCopley, their clients and employees I: Are not authorised to make or give any representations or warranties in relation to the property either here or elsewhere, either on their own behalf or on behalf of their client or otherwise. They assume no responsibility for any statement that may be made in these particulars. These particulars do not form part of any offer or contract and must not be relied upon as statements or representations of fact. 2: Any areas, measurements or distances are approximate. The text, photographs and plans are for guidance only and are not necessarily comprehensive. It should not be assumed that the property has all necessary planning, building regulation or other consents and HoldenCopley have not tested any services, equipment or facilities. Purchasers must make further investigations and inspections before entering into any agreement.