



Cookes Meadow, Northill, Biggleswade, SG18 9FX
£1,850,000 Freehold

Plot 13, Cookes Meadow - Introducing this beautiful 5 bedroom detached family home built to a high specification set in this exclusive community nestled within the scenic village of Northill. This impressive property offers you the highest standard of luxury living with spacious accommodation, beautifully finished with bespoke fixtures and fittings.

This property is now ready to move in to. To book a viewing contact Taylor Made today.

Reception Hall
 Cloakroom
 Lounge
 18'8" x 22'2" (5.71 x 6.76)
 Study
 12'10" x 9'2" (3.93 x 2.81)
 Family Room
 18'6" x 11'6" (5.65 x 3.52)
 Kitchen/Dining Room
 30'5" x 21'3" (9.28 x 6.48)
 Utility Room
 Bedroom 5
 16'0" x 10'1" (4.9 x 3.08)
 1st Floor Landing
 Loft Room
 Master Bedroom
 14'6" x 13'5" (4.44 x 4.09)
 Dressing Room
 Ensuite
 Bedroom 2
 18'6" x 13'4" (5.64 x 4.07)
 Dressing Room
 Ensuite
 Bedroom 3
 13'3" x 18'6" (4.04 x 5.64)
 Ensuite
 Bedroom 4
 18'9" x 10'0" (5.73 x 3.07)
 Ensuite
 Outside

Front & Rear Gardens
 Double Garage
 Specifications
 Quooker 3 in 1 boiling tap
 Integrated coffee machine with coffee centre with bi-folding doors
 2 built in microwaves
 1-Hide slide Neff single oven with built in steamer
 1-Neff hide slide single multifunctional oven
 600 Built in 2 Zone wine cooler
 900 wide 5 Zones touch control induction Hob
 Stainless steel Neff "American style" fridge freezer with ice and water dispenser.
 Integrated remote control fully ducted outside ceiling hood
 Quartz bathroom cloakroom vanity tops
 Quartz kitchen utility work surfaces
 Bespoke fully fitted kitchen units with a soft sheen painted finish .
 Walk in larder area with storage and no heating in this area ideal to store drinks and food storage .
 Extensive utility room with walk in storage units and swing open larder units in anthracite finish .
 Space for stacking washing machine and Tumble dryer .
 Full under floor heating up stairs fully carpeted and Down stairs has porcelain tiles from mandarine stone with under floor heating .
 Neo thermostats to control each zone which can be connected and controlled via a app on your phone .
 Led lighting through out house choice of warm subtle white for mood lighting or cool white all the lights are

Central

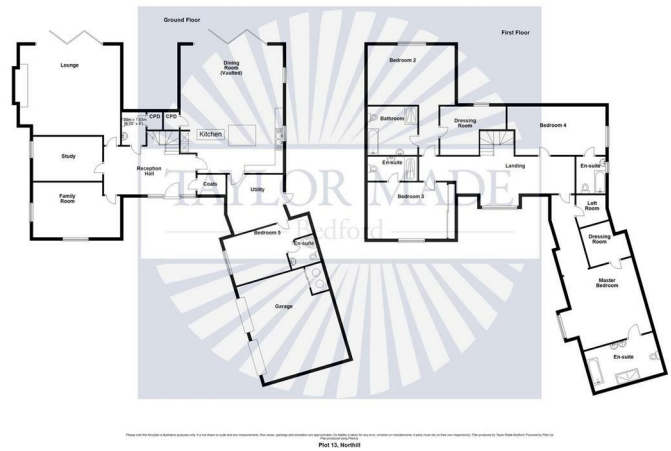

These particulars of sale are a general outline, acting as guidance only. All descriptions, dimensions and references to condition are given without responsibility falling upon the vendors or their agents. Taylor Made Residential Ltd has not tested any apparatus, equipment, fixtures or services. We have not sought to verify the legal title of the property, purchasers must obtain verification from their solicitor. This is offered for sale on a Subject to Contract and Without Prejudice basis 2022.

 Taylor Made New Homes Limited
 Taylor House, Roman Gate, Saxon Way, Great Denham, Bedford, MK40 4FU

 01234 302043

 bedford@taylorandandpropertygroup.co.uk
 www.taylorandandpropertygroup.co.uk

Company Registration: 7122033 VAT No: 158 9989 22

