



**MOVE INN ESTATES**

MAKING THE RIGHT MOVE



## Glaisyer Way

, Iver, SL0 0RX

**Price Guide £585,000**

Move Inn Estates are delighted to offer this attractive and thoughtfully extended three/four bedroom end-of-terrace home, tucked away in a peaceful cul-de-sac within easy reach of Iver Heath village centre, local shops and schools.

The property has been tastefully updated and features a modern, recently installed kitchen finished with quartz worktops and a range of integrated appliances, including a double oven, hob, dishwasher and extractor. Neutral décor runs throughout the home, creating a bright and welcoming feel, including within the contemporary bathroom suite.

To the rear, the extension provides a fantastic open-plan layout where the kitchen leads naturally into the dining area and flows around to the main living space, making it ideal for both everyday living and entertaining. At the front of the property is a separate sitting room which offers flexibility and could also be used as an additional bedroom if required.

As an end-of-terrace home, the property benefits from extra outdoor space, including a side garden currently accommodating a wooden Wendy house/shed. The rear garden also features a further storage shed and a timber garden room complete with power, lighting and plumbing, perfect for home working or hobbies.

A garage is located nearby within a separate block, adding further convenience.

- Extended three/four bedroom
- quiet cul-de-sac location
- Close to Iver Heath village
- Modern fitted kitchen
- open-plan kitchen, dining and living area
- Flexible front reception room / fourth bedroom
- Additional side garden plus rear garden with powered timber garden room
- Garage in a nearby block

### Viewing

Please contact our Move Inn Estates - Sales Office on 0208 574 4966 if you wish to arrange a viewing appointment for this property or require further information.



3



1



1



C



Floor Plan

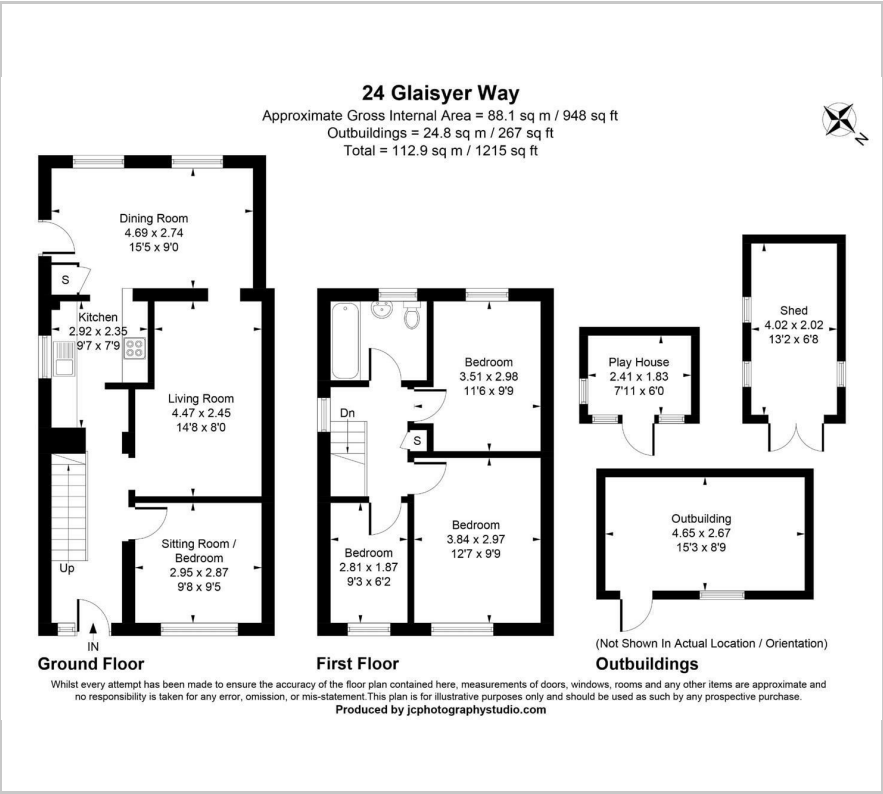

Area Map



Energy Efficiency Graph

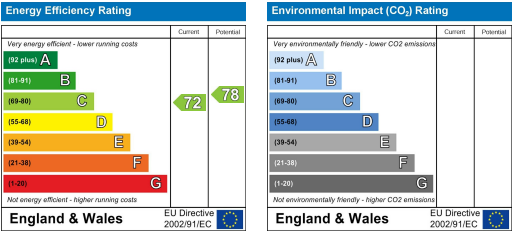

These particulars, whilst believed to be accurate are set out as a general outline only for guidance and do not constitute any part of an offer or contract. Intending purchasers should not rely on them as statements of representation of fact, but must satisfy themselves by inspection or otherwise as to their accuracy. No person in this firms employment has the authority to make or give any representation or warranty in respect of the property.