



# MOVE INN ESTATES

MAKING THE RIGHT MOVE



Lady Margaret Road

, Southall, UB1 2RG

Price Guide £269,950

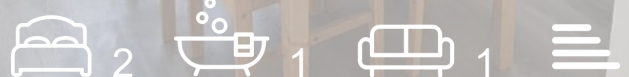

## Floor Plan

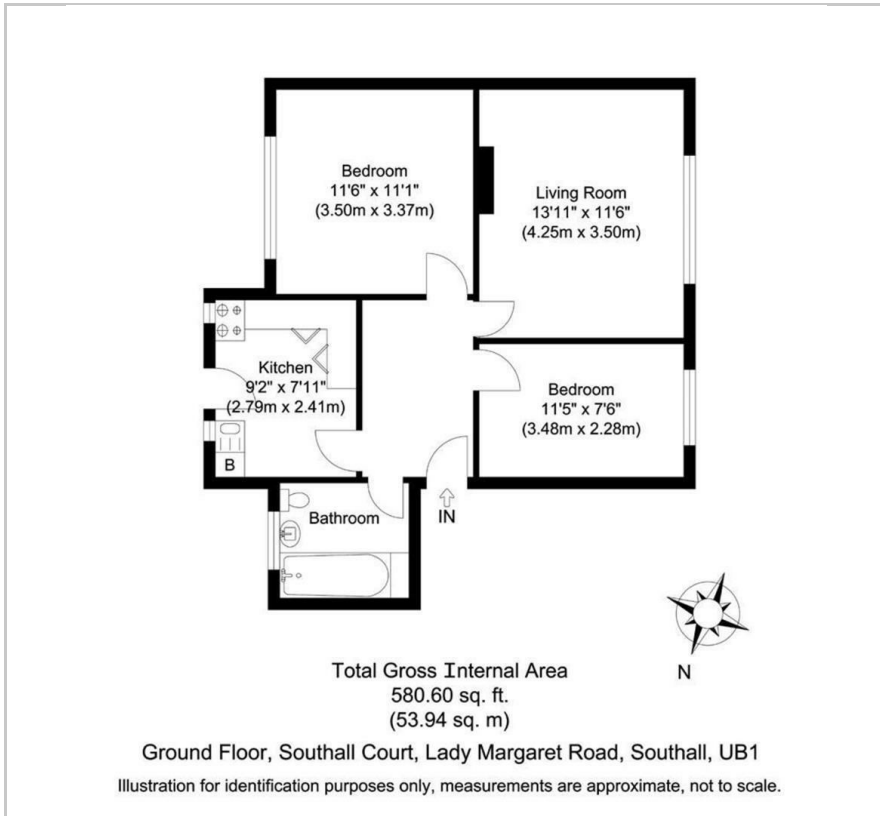

## Area Map



## Energy Efficiency Graph

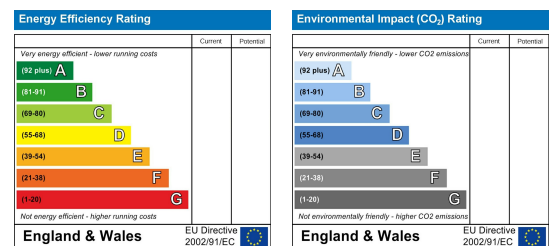

## Viewing

Please contact our Move Inn Estates - Sales Office on 0208 574 4966 if you wish to arrange a viewing appointment for this property or require further information.

- Leasehold
- No Chain
- Ideal Location
- Ground Floor Flat
- 108 Year Lease
- Great Rental Yield

Move Inn Estates Presents this Ground Floor Flat In Southall Court, a charming residential enclave nestled on Lady Margaret Road. This delightful property offers two bedrooms, a cozy lounge, kitchen, and bathroom/WC. Enjoy communal gardens and parking facilities. Located moments from South Road with easy access to amenities and transport. No onward chain. Ideal for investors. Contact us to view today.



These particulars, whilst believed to be accurate are set out as a general outline only for guidance and do not constitute any part of an offer or contract. Intending purchasers should not rely on them as statements of representation of fact, but must satisfy themselves by inspection or otherwise as to their accuracy. No person in this firm's employment has the authority to make or give any representation or warranty in respect of the property.

46 Vicarage Farm Road, Hounslow, Middlesex, TW5 0AB

Tel: 0208 574 4966 Email: [info@moveinnestates.co.uk](mailto:info@moveinnestates.co.uk) [www.moveinnestates.co.uk](http://www.moveinnestates.co.uk)