

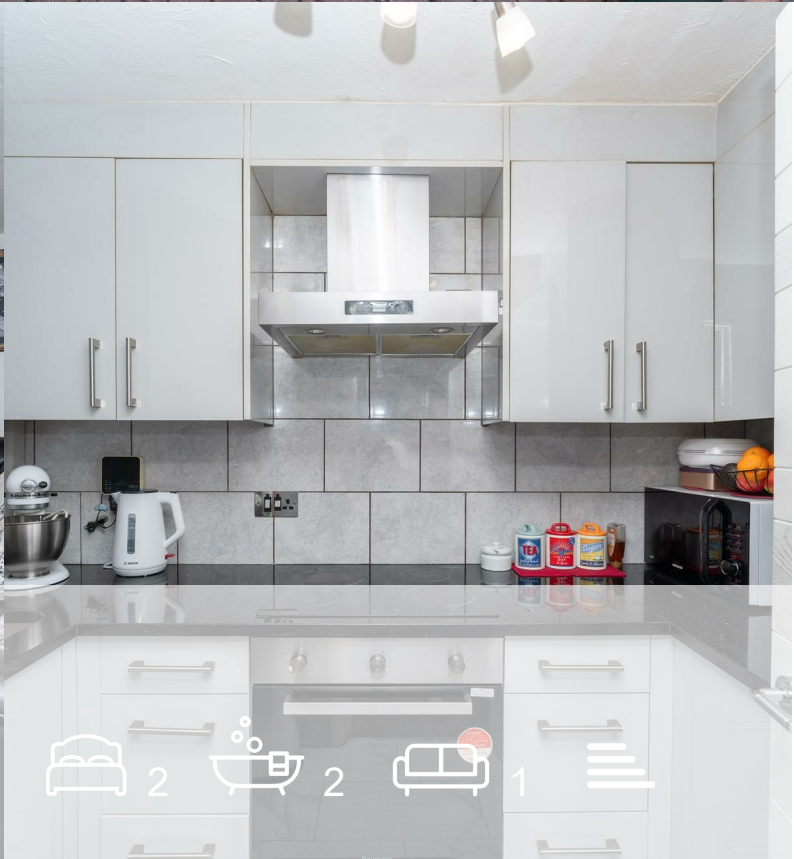

**MOVE INN ESTATES**  
MAKING THE RIGHT MOVE



**Hawthorn Close**  
, Hounslow, TW5 9TG  
Price Guide £465,000



## Floor Plan

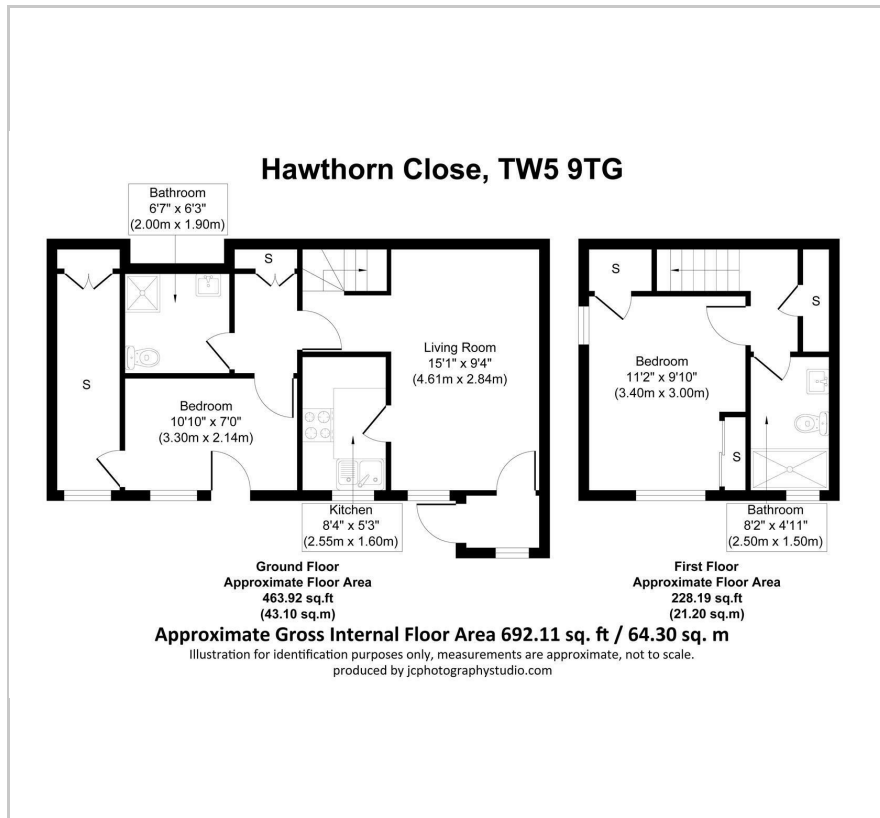

## Area Map

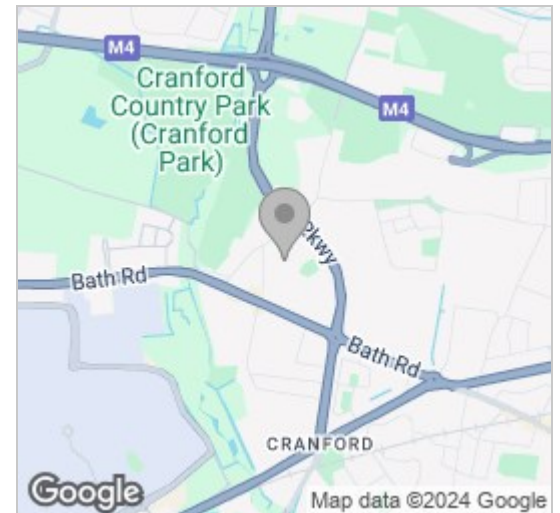

## Energy Efficiency Graph

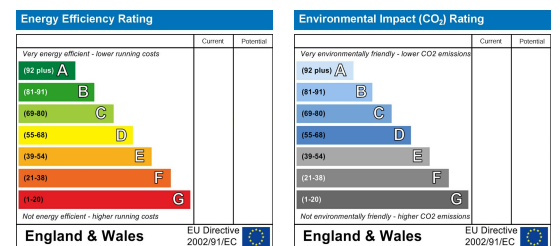

## Viewing

Please contact our Move Inn Estates - Sales Office on 0208 574 4966 if you wish to arrange a viewing appointment for this property or require further information.

- Two Bedroom House
- Cul De Sac
- Two Bathrooms
- Good Schools
- Popular Location
- End Of Terrace
- Immaculate Condition
- Transport Links
- Gated Entrance



Move Inn Estates is pleased to present this charming two-bedroom end-of-terrace house situated in a serene cul-de-sac within the highly sought-after area of Hounslow. This all-electric property features a spacious living room, an extended en-suite bedroom, and a kitchen on the ground floor. The first floor offers an additional bedroom and a family bathroom.

The house boasts ample storage space and benefits from abundant natural light, thanks to numerous windows throughout. The neutral interior color scheme ensures it will appeal to a wide range of tastes.

Outside, the property features a large garden at the front, perfect for family gatherings and entertaining guests. It is gated, providing privacy, and includes one allocated parking space along with ample free parking for visitors.

The property is well-maintained and move-in ready, making it an ideal choice for first-time home buyers or investors. Call us today to book your viewing!



These particulars, whilst believed to be accurate are set out as a general outline only for guidance and do not constitute any part of an offer or contract. Intending purchasers should not rely on them as statements of representation of fact, but must satisfy themselves by inspection or otherwise as to their accuracy. No person in this firm's employment has the authority to make or give any representation or warranty in respect of the property.