



MOVE INN ESTATES
MAKING THE RIGHT MOVE



Glade Lane



Floor Plan

Area Map

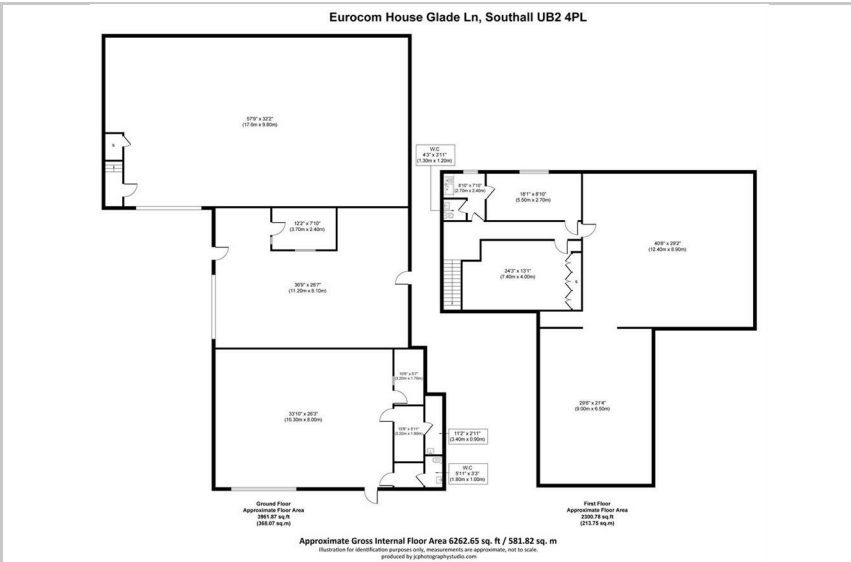

This impressive commercial property, currently a thriving hardware store, is an exceptional investment opportunity. Split into three separate units, it offers flexibility for various business ventures. With a Gross Internal Floor Area of approximately 6,262.65 sq. ft (581.82 sq. m), this property is both spacious and versatile.

Key features include on-site parking for convenience and electric shutters and gates for enhanced security. Additionally, there is potential for development, subject to planning permissions, offering excellent growth opportunities.

Situated in a prime location, the property enjoys high visibility and accessibility, making it ideal for businesses. The surrounding area is a bustling commercial hub with a mix of retail, dining, and professional services.

While currently used as a hardware store, the property is suitable for various uses, including retail outlets, office spaces, showrooms, warehousing, and light industrial purposes. The three separate units offer diverse business opportunities.

Investment highlights include its substantial size, versatile units, secure access, and development potential.

For further details or to arrange a viewing, please contact our Heston office 02085744966. This is a rare opportunity to acquire a versatile and secure commercial property with significant growth potential. Act quickly to avoid disappointment.

Note: All measurements are approximate, and potential development is subject to obtaining the necessary planning permissions.



Energy Efficiency Graph

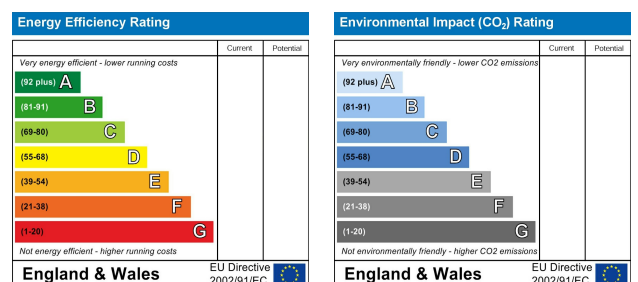

These particulars, whilst believed to be accurate are set out as a general outline only for guidance and do not constitute any part of an offer or contract. Intending purchasers should not rely on them as statements of representation of fact, but must satisfy themselves by inspection or otherwise as to their accuracy. No person in this firm's employment has the authority to make or give any representation or warranty in respect of the property.