



# MOVE INN ESTATES

MAKING THE RIGHT MOVE



**Salisbury Road**

, Southall, UB2 5QJ

Price Guide £355,000



 2  1  1  B

## Floor Plan

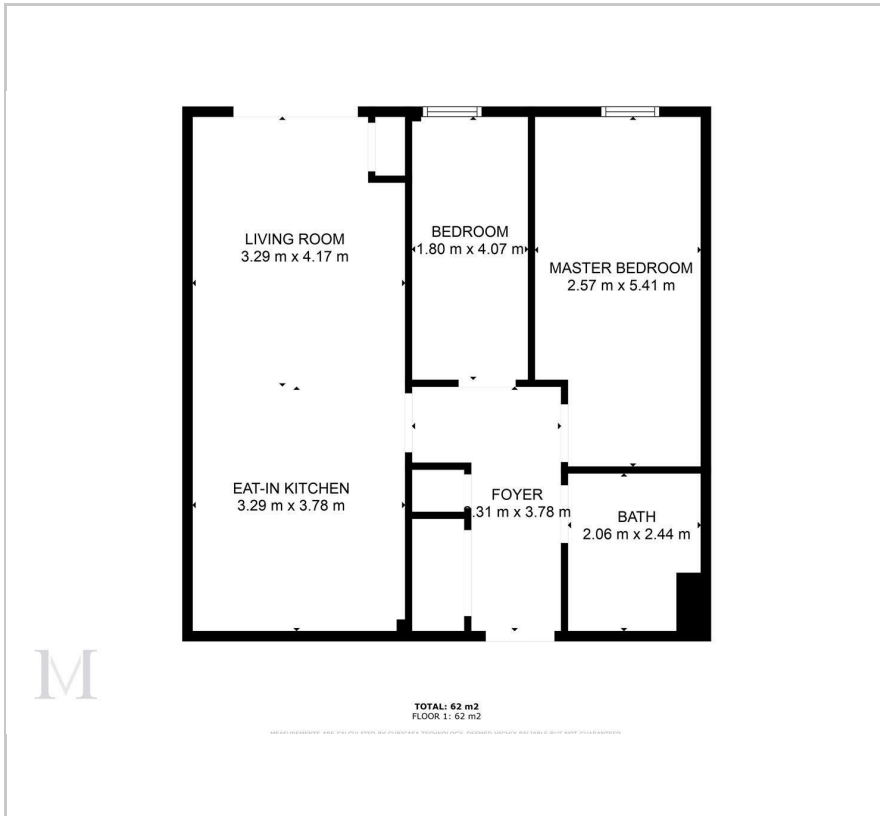

## Area Map



## Energy Efficiency Graph

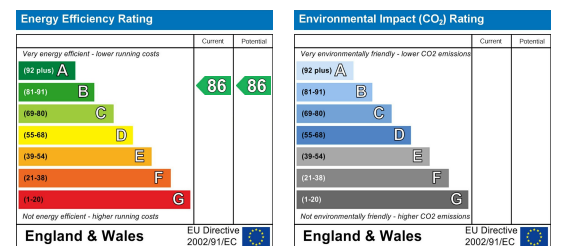

## Viewing

Please contact our Move Inn Estates - Sales Office on 0208 574 4966 if you wish to arrange a viewing appointment for this property or require further information.

- Long Lease 990 Years
- Ground Floor 2 Bed Flat
- Secure Gated Allocated Parking
- Lift Access
- Rooftop Communal Garden
- Wheelchair Accessible
- Park Access

Move Inn Estates proudly presents this stunning ground floor 2-bedroom flat, boasting lift access and an impressive lease term of 990 years! Situated in close proximity to local amenities and transport links, this property offers both comfort and convenience in a central location.

The generously sized kitchen seamlessly flows into a spacious living room, complemented by a private rear garden, perfect for relaxation and entertainment. With 2 double bedrooms, this flat provides ample space for residents.

Further enhancing its appeal, the property includes a secure gated allocated parking space underground. Additionally, residents have access to a rooftop garden and communal park opposite the development, offering a serene outdoor retreat.

Whether you're a first-time buyer, commuter, or investor, this property presents a brilliant opportunity not to be missed! Book your viewings now to experience the charm and potential of this exceptional home!

Furthermore, the neighborhood boasts an outstanding array of primary and secondary schools, ensuring top-notch educational opportunities for residents. With excellent access to downtown London, Southall offers seamless transit options, making it a commuter's dream. The Southall Overground station, mere minutes away on foot, provides convenient connections to Reading, Heathrow, Paddington, or Shenfield.



These particulars, whilst believed to be accurate are set out as a general outline only for guidance and do not constitute any part of an offer or contract. Intending purchasers should not rely on them as statements of representation of fact, but must satisfy themselves by inspection or otherwise as to their accuracy. No person in this firm's employment has the authority to make or give any representation or warranty in respect of the property.