



MOVE INN ESTATES

MAKING THE RIGHT MOVE



New Road

Bedfont, Feltham, TW14 8HW

Offers In Excess Of £600,000



Floor Plan

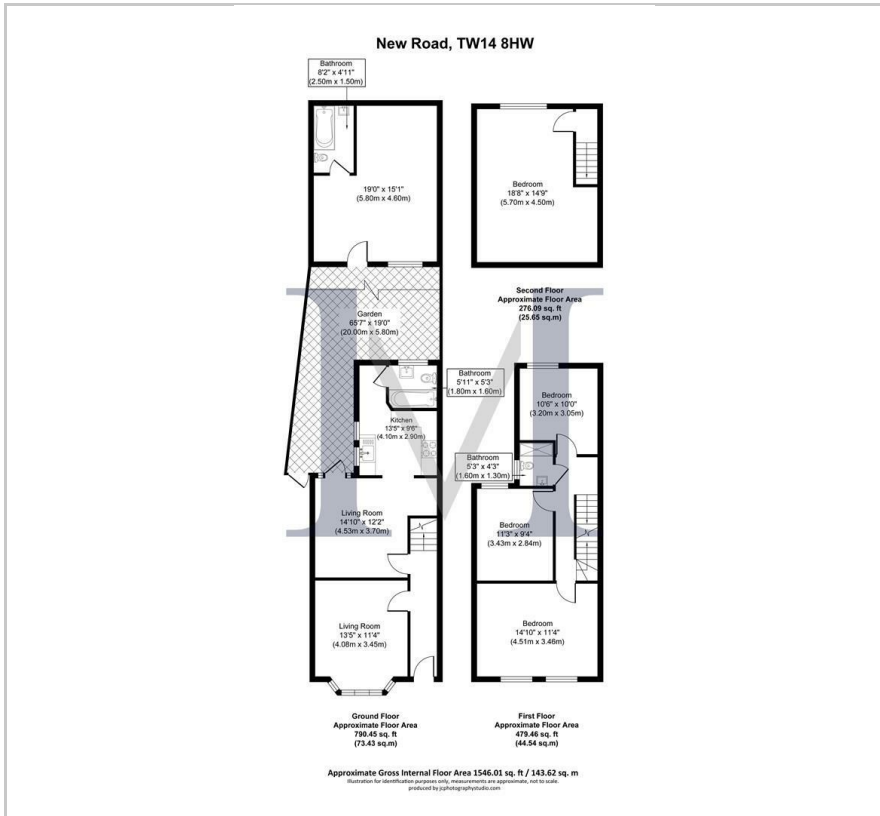

Area Map



Energy Efficiency Graph

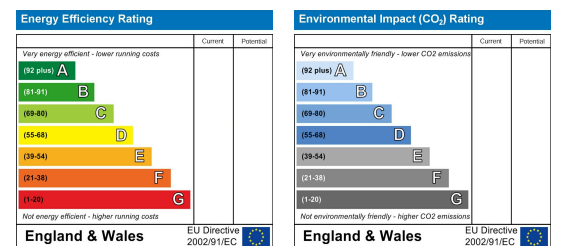

Viewing

Please contact our Move Inn Estates - Sales Office on 0208 574 4966 if you wish to arrange a viewing appointment for this property or require further information.

- 5 Bedrooms
- Located In Feltham
- Scope To Extend (STTP)
- Ideal For Investors
- End Of Terrace
- Refurbished

Move Inn Estates are proud to present this spacious and well-maintained 5-bedroom End Of Terrace house located in the desirable area of Feltham. This property is ideal for investors or larger families.

Upon entering, you'll be greeted by a bright and inviting entrance hallway, leading you to the various rooms on offer. The property boasts five generously sized bedrooms, providing ample space for privacy and relaxation. Each room is well-appointed, featuring large windows that allow plenty of natural light to flood in, creating a warm and welcoming atmosphere.

Furthermore, this property benefits from a convenient location, with easy access to local amenities, transportation links, and educational institutions. Feltham provides a range of shops, supermarkets, restaurants, and recreational facilities, ensuring that daily necessities and leisure activities are within reach.



These particulars, whilst believed to be accurate are set out as a general outline only for guidance and do not constitute any part of an offer or contract. Intending purchasers should not rely on them as statements of representation of fact, but must satisfy themselves by inspection or otherwise as to their accuracy. No person in this firm's employment has the authority to make or give any representation or warranty in respect of the property.

46 Vicarage Farm Road, Hounslow, Middlesex, TW5 0AB

Tel: 0208 574 4966 Email: info@moveinnestates.co.uk www.moveinnestates.co.uk