



MOVE INN ESTATES

MAKING THE RIGHT MOVE



Kingsnympton Park
Kingston Upon Thames, KT2 7TH
Offers In Excess Of £340,000



Floor Plan

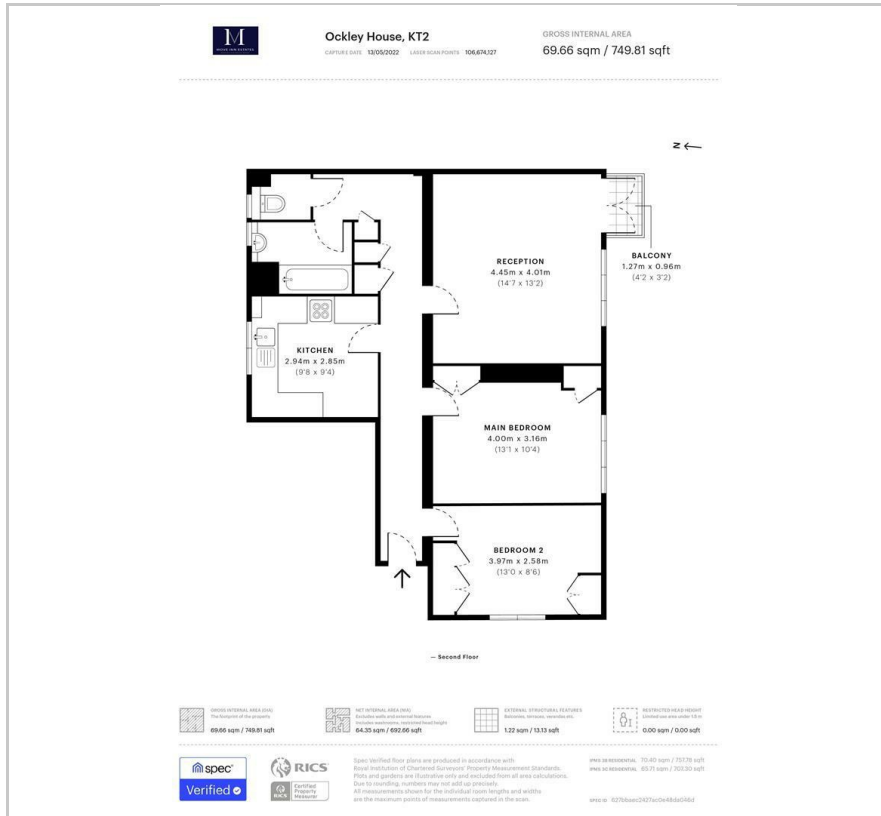

Area Map



Energy Efficiency Graph

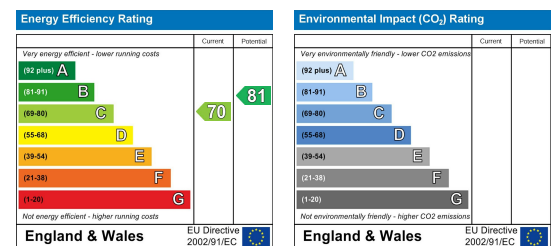

Viewing

Please contact our Move Inn Estates - Sales Office on 0208 574 4966 if you wish to arrange a viewing appointment for this property or require further information.

- Two bedrooms
- Balcony
- Intercom system
- Second floor
- Parking
- Gas central heating



Move Inn Estates bring to the market, this immaculate two bedroom, second floor flat ideally located just a short walk from excellent bus links, good local shops and amenities, Richmond Park and within easy reach of Kingston Town Centre with its wide range of amenities and mainline train station.

This ideal investment property comprises of a bright and spacious living room with balcony, two double sized bedrooms with fitted wardrobes, a modern fitted kitchen, family bathroom and separate WC. Further benefits include; ample parking, gas central heating and communal grounds.

Property Details:

Lease Remaining - 85 years (approx)

Ground Rent - £10 pa (approx)

Service Charge - £80 pm (approx)

Situated off Kingston Hill convenient for Norbiton train station with its services into London Waterloo, Richmond Park, excellent local schools and town centre with its comprehensive shopping facilities and a choice of riverside bars and restaurants.

Viewings advised.



These particulars, whilst believed to be accurate are set out as a general outline only for guidance and do not constitute any part of an offer or contract. Intending purchasers should not rely on them as statements of representation of fact, but must satisfy themselves by inspection or otherwise as to their accuracy. No person in this firm's employment has the authority to make or give any representation or warranty in respect of the property.

46 Vicarage Farm Road, Hounslow, Middlesex, TW5 0AB

Tel: 0208 574 4966 Email: info@moveinnestates.co.uk www.moveinnestates.co.uk