

Waterman House, 1 Lord Street. Gravesend
Kent, DA12 1AW

Sales: 01474 330840

Email: info@watermanhouseestates.co.uk

www.watermanhouseestates.co.uk



Waterman House Estates



Waterslippe, Tonbridge, TN11 0EP

Offers in excess of £300,000

We are pleased to bring to the market this 3 BEDROOM TERRACED HOUSE located in HADLOW, TONBRIDGE. Downstairs comprises of the KITCHEN and LARGE LOUNGE/DINER. There are 3 BEDROOMS upstairs, 2 DOUBLES and 1 SINGLE plus the FAMILY BATHROOM. To the rear of the property is a GARDEN LAID TO LAWN.

Located in the picturesque village of HADLOW and close to all local amenities. This property is situated on the A26 and on main bus routes. Tonbridge Train Station is just 11 minutes away by car and can take you to London in approximately 40 minutes.

Can be sold with TENANT IN-SITU or VACANT POSSESSION.



8 Waterslippe, Hadlow, Tonbridge, Kent, TN11 0EP



GROUND FLOOR
495 sq.ft. (46.0 sq.m.) approx.

1ST FLOOR
410 sq.ft. (38.1 sq.m.) approx.

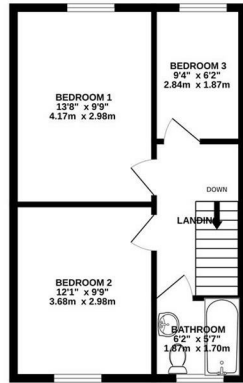
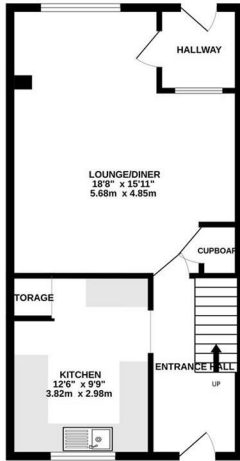

TOTAL FLOOR AREA: 905 sq.ft. (84.1 sq.m.) approx.
While every effort has been made to ensure the accuracy of the figures contained here, measurements of doors, windows, rooms and any other items are approximate and no responsibility is taken for any errors, omissions or misstatements. This plan is for illustrative purposes only and should be used as a guide only. All rights reserved. No part of this publication may be reproduced, stored in a retrieval system, or transmitted in any form or by any means, electronic, mechanical, photocopying, recording, or by any information storage and retrieval system, without the prior written permission of the publisher. EPC and Energy Rating.

Energy Efficiency Rating

	Current	Potential
Very energy efficient - lower running costs		
(92 plus) A		
(81-91) B		
(69-80) C		
(55-68) D		
(39-54) E		
(21-38) F		
(1-20) G		
Not energy efficient - higher running costs		
	72	85

Environmental Impact (CO₂) Rating

	Current	Potential
Very environmentally friendly - lower CO ₂ emissions		
(92 plus) A		
(81-91) B		
(69-80) C		
(55-68) D		
(39-54) E		
(21-38) F		
(1-20) G		
Not environmentally friendly - higher CO ₂ emissions		

