



Shacklewell Lane, E8

£565 Per week

A beautifully presented two double bedroom apartment in Babik Court. This well proportioned property has a large open plan reception, wood floors throughout, a recently renovated bathroom and a private balcony.

The property is close to Hackney Downs and Hackney Central overground stations for easy access to Stratford and Liverpool Street. Close to Hackney Downs park as well as London Fields park that leads to the endless amenities of Broadway Market.

Features

- Two Double Bedrooms
- Renovated Bathroom
- Private Balcony
- Wooden Flooring
- Open plan
- Unfurnished

Shacklewell Lane, London, E8

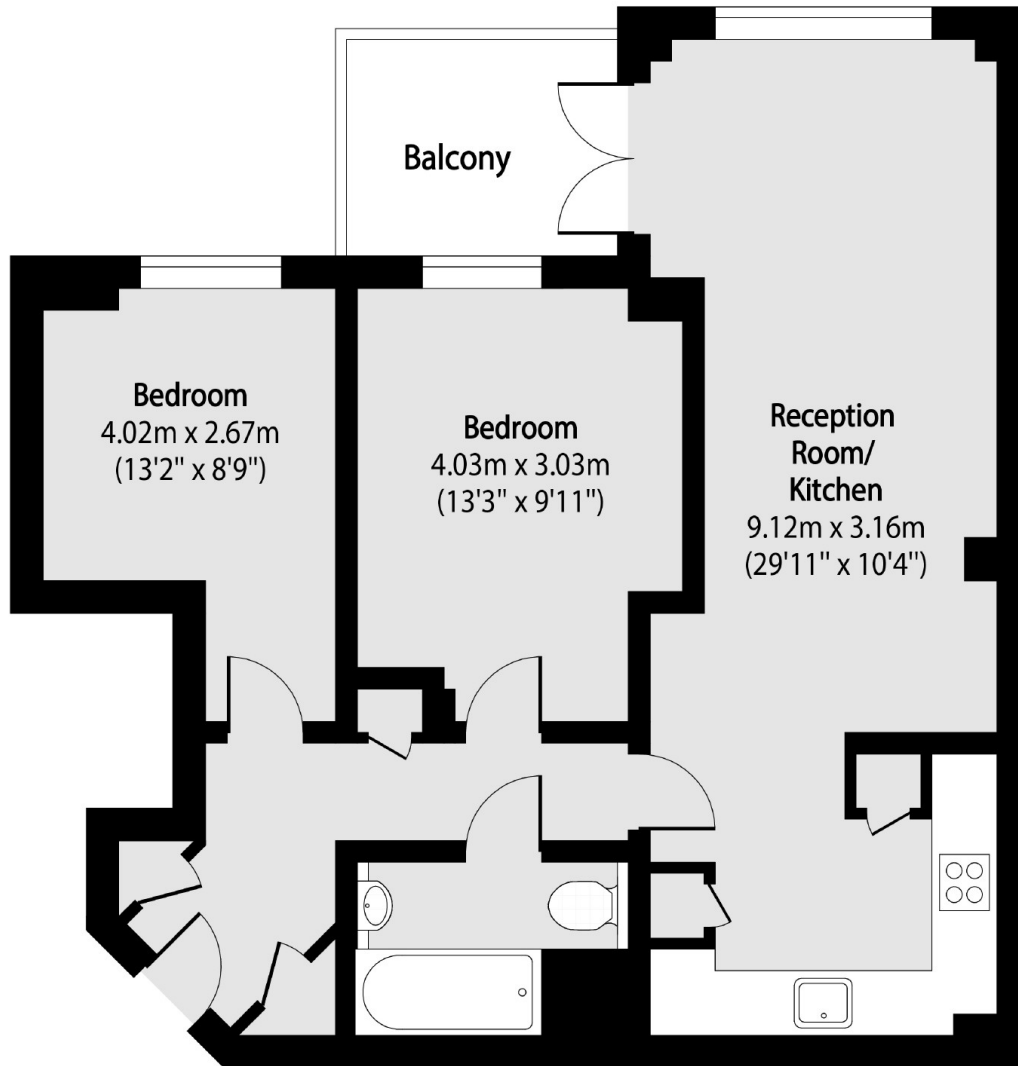

Total area (approx): 62.31 sq m (671 sq. ft)

Balcony total area (approx): 5.00 sq m (54 sq. ft)

Dexters

Hackney
10 Broadway Market
London
E8 4QJ
Lettings
0207 247 2441

Energy Rating: B. We aim to make our particulars both accurate and reliable. However they are not guaranteed; nor do they form part of an offer or contract. If you require clarification on any points then please contact us, especially if you're traveling some distance to view. Please note that appliances and heating systems have not been tested and therefore no warranties can be given as to their good working order.

 **RICS** | Regulated
Estate Agent
and Letting Agent

[dexters.co.uk](https://www.dexters.co.uk)