



## Earlston Grove, E9

£692 Per week

A large two bedroom garden property within a cul-de-sac off Victoria Park Road. This well presented property has a large open reception, wooden flooring, exposed brick feature wall and large private south facing garden.

Amazing location within easy reach of Victoria Park village, Broadway Market, London Fields, and Cambridge Heath for all local cafés, shops and restaurants.

### Features

- Two Bedroom
- Open Plan
- Exposed Brickwork
- Wooden Flooring
- Built-in Wardrobes
- South Facing Garden

# Earlston Grove, London, E9

## Ground Floor

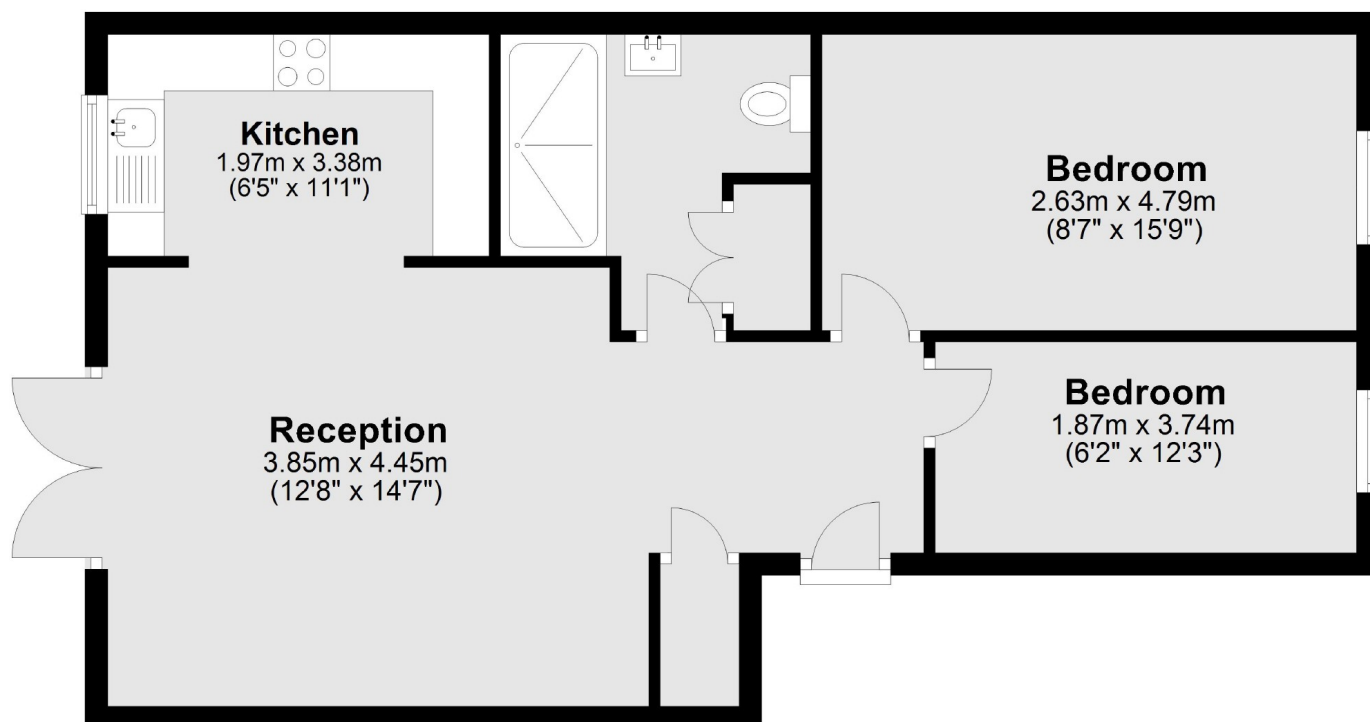

Total area: approx. 58.5 sq. metres (629.6 sq. feet)