



## Dalston Square, E8

£657 Per week

A large two double bedroom apartment on the tenth floor of Sledge Tower. This beautifully presented apartment comes with floor to ceiling windows, a large private balcony and use of a communal roof terrace and gym.

Located close to Dalston Kingsland, Islington, Haggerston and Broadway Market for all local shops, supermarkets and restaurants.

### Features

- Two Double Bedrooms
- Two Bathrooms
- Large Balcony
- Open Plan
- Part-Furnished
- Residents Gym

# Dalston Square, London, E8

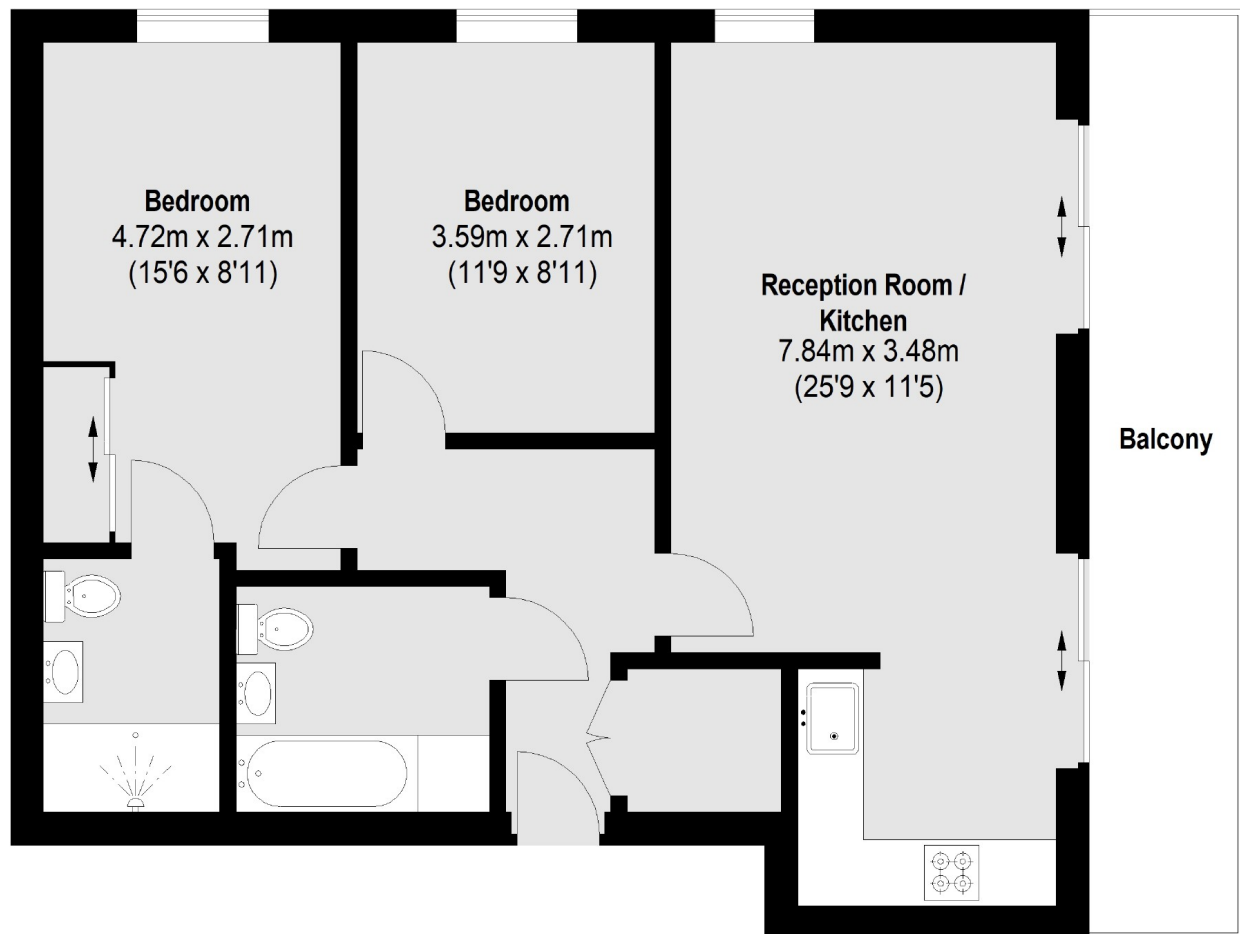

## Tenth Floor

Total area (approx.): 67.35 sq. m (725 Sq. ft)  
Balcony: 11.27 sq. m (121 Sq. ft)

# Dexters

Hackney  
10 Broadway Market  
London  
E8 4QJ  
Lettings  
0207 247 2441

Energy Rating: C. We aim to make our particulars both accurate and reliable. However they are not guaranteed; nor do they form part of an offer or contract. If you require clarification on any points then please contact us, especially if you're traveling some distance to view. Please note that appliances and heating systems have not been tested and therefore no warranties can be given as to their good working order.

 **RICS** | Regulated  
Estate Agent  
and Letting Agent

[dexters.co.uk](http://dexters.co.uk)