



Middleton Road, E8

£525,000

A bright one double bedroom Victorian conversion situated on one of London Fields Prime roads. This property has large Sash Windows in both the living room and bedroom, with views over the shared south facing garden from the bedroom. It has been modernised and would allow for anyone to put their own stamp on it.

Middleton Road is a short walk from London Fields and the popular Broadway Market with its endless cafes, bars and restaurants. Both London Fields and Hackney Central overground stations are less than a mile away.

Features

- Share of Freehold
- Period
- Shared South-facing Garden
- Sash Windows
- One Double Bedroom
- London Fields

Middleton Road, London, E8

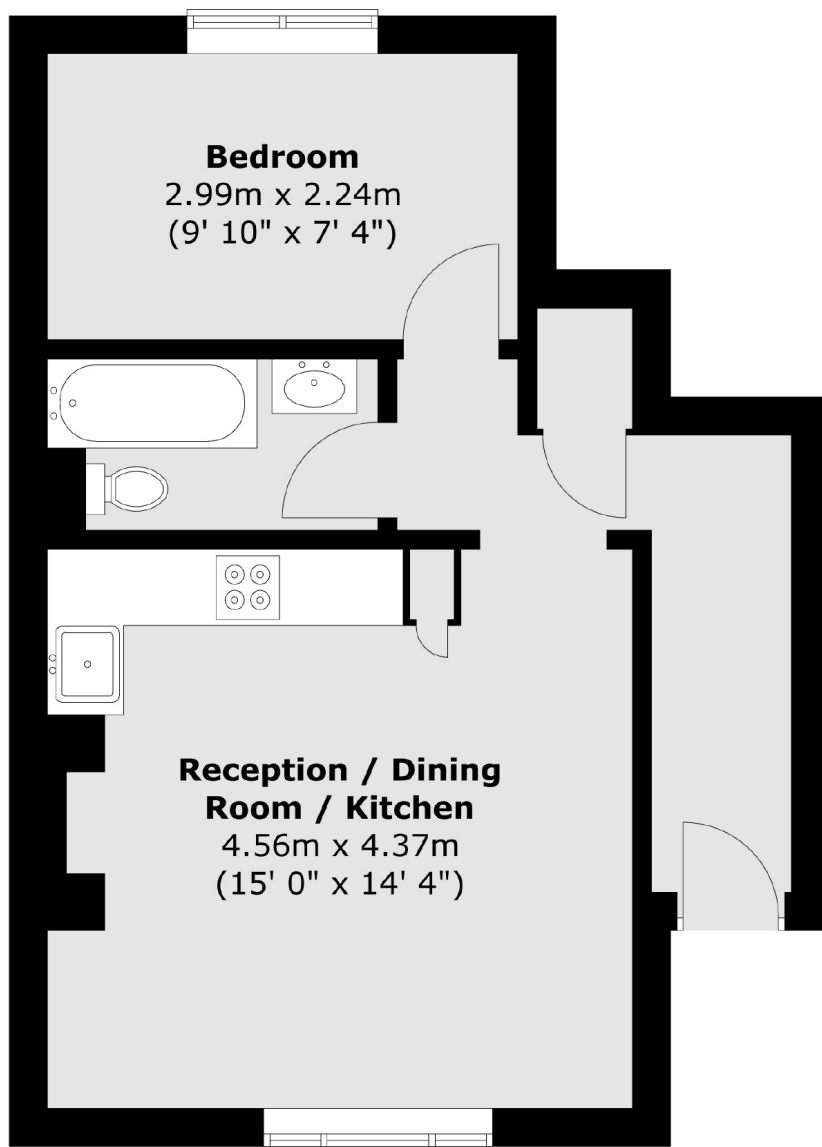

Total area (approx.) : 41 sq. m (441 sq. ft)