



Wyke Road, E3

£425,000

A modern one double bedroom, apartment located in one of the most vibrant areas of East London. This Hackney Wick property benefits from an open plan living kitchen area and floor to windows and doors which lead out onto a private balcony, which does have a slight view of the canal, The development comes with a gym, concierge and bike storage.

The property is located a short walk from the greeneries of Queen Elizabeth Olympic Park and Victoria Park. Hackney Wick overground station is close by. A short walk or cycle across the park are Stratford Station & Westfield shopping centre.

Features

Hackney Wick
Open Plan
Modern
Ample Storage
Gym & Concierge
Hertford Union Canal

Wyke Road,
London, E3

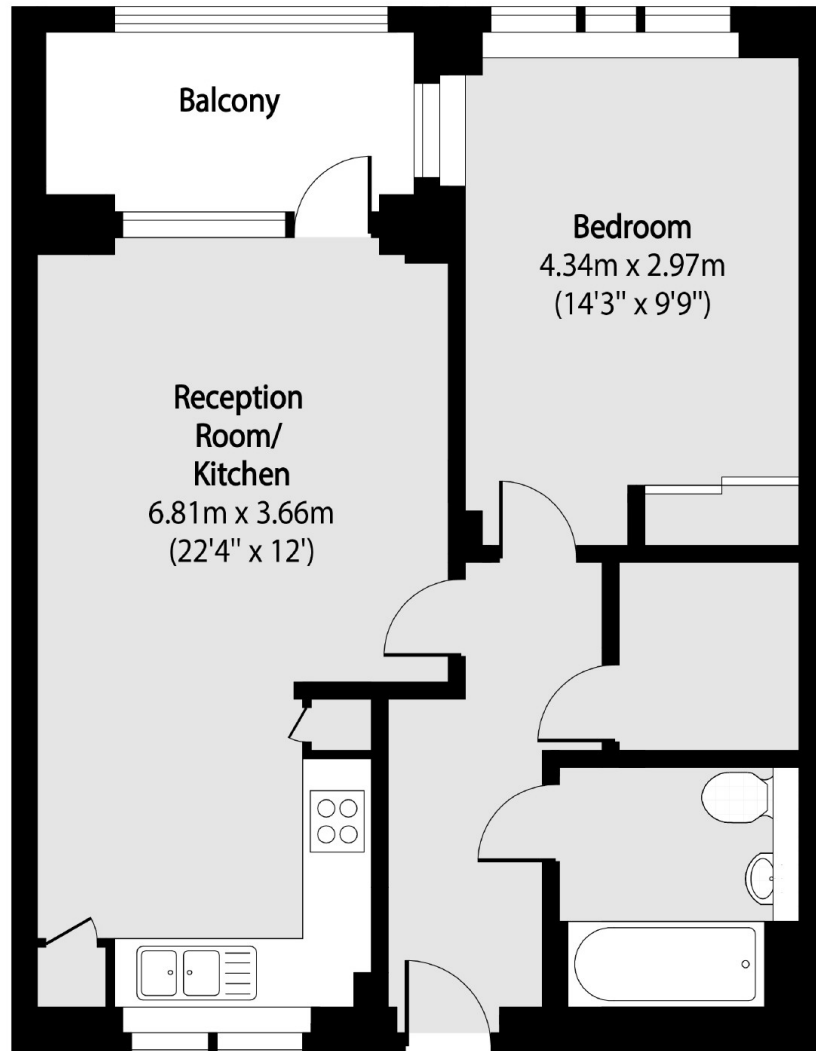

Total area (approx): 51.00 sq m (549 sq. ft)

Balcony total area (approx): 5.01 sq m (54 sq. ft)

Dexters

Hackney
10 Broadway Market
London
E8 4QJ
Sales
0207 247 2440

Energy Rating: B. We aim to make our particulars both accurate and reliable. However they are not guaranteed; nor do they form part of an offer or contract. If you require clarification on any points then please contact us, especially if you're traveling some distance to view. Please note that appliances and heating systems have not been tested and therefore no warranties can be given as to their good working order.

 **RICS** | Regulated
Estate Agent
and Letting Agent

[dexters.co.uk](https://www.dexters.co.uk)