



## Copperfield Road, E3

### £575,000

A stunning park and canal side, two bedroom apartment. Floor to ceiling glass doors open on to a private canal facing balcony from the large open plan reception room and both bedrooms. The property comes with a communal roof terrace, private secure parking and is available chain free,

Sat between Regents Canal and Mile End Park. Mile End Underground station less than half a mile away provides good access to The City and Stratford. The flat is also close to the popular areas of Limehouse, London Fields and Canary Wharf.

### Features

- Chain Free
- Two Double Bedrooms
- Private Balcony
- Communal Roof Terrace
- Secure Parking Space
- Regents Canal

Copperfield Road,  
London, E3

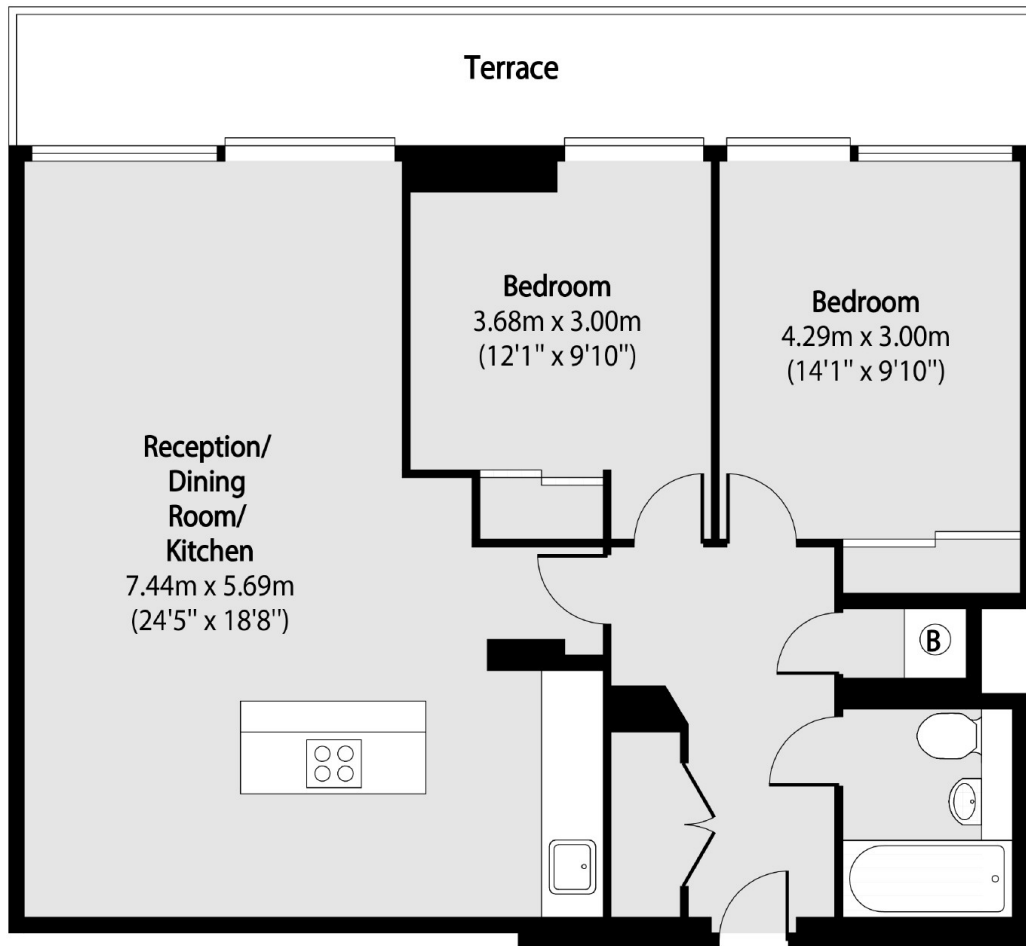

Total area (approx): 72.74 sq m (783 sq. ft)

Terrace total area (approx): 12.91 sq m (139 sq. ft)