



Taylor Place, E3

£250,000

A spacious modern one bedroom apartment in the popular Fondant Court development. With a well sized open plan kitchen-living space. This property has plentiful storage and has floor to ceiling windows from the private balcony allowing an abundance of natural light throughout. And also benefits from an on site concierge.

Centrally located within easy reach of Bow, Stratford, Hackney Wick and Victoria Park for all local shops, restaurants and cafés as well as great transport links including multiple tube stations within 0.3 of a mile

Features

- Large Balcony
- 24 hr Concierge
- Open Plan
- EWS1: B1
- Olympic Park
- Views towards the Olympic Park

Taylor Place, London, E3

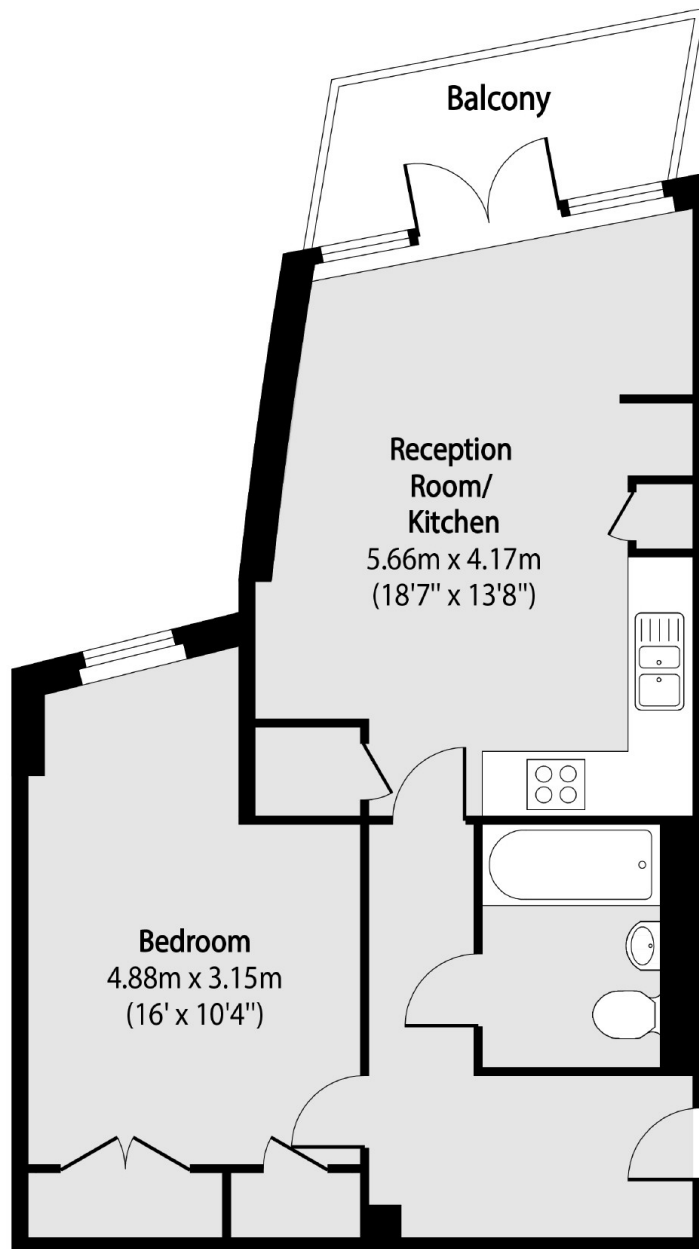

Total area (approx): 49.05 sq m (528 sq. ft)

Balcony total area (approx): 4.92 sq m (53 sq. ft)

Dexters

Hackney
10 Broadway Market
London
E8 4QJ
Sales
0207 247 2440

Energy Rating: C. We aim to make our particulars both accurate and reliable. However they are not guaranteed; nor do they form part of an offer or contract. If you require clarification on any points then please contact us, especially if you're traveling some distance to view. Please note that appliances and heating systems have not been tested and therefore no warranties can be given as to their good working order.

 **RICS** | Regulated
Estate Agent
and Letting Agent

[dexters.co.uk](https://www.dexters.co.uk)