



Taylor Place, E3

£225,000

A well presented apartment, located within a warehouse conversion in a gated and secure development. This property offers open plan living, separate kitchen and has access to a gated communal garden. This property is being offered chain free.

Centrally located within easy reach of Bow, Stratford, Hackney Wick and Victoria Park for all local shops, restaurants and cafés as well as great transport links including multiple tube stations within 0.3 of a mile

Features

Offers In Excess Of
Chain Free
Converted Warehouse Building
Well Presented
Communal Garden
Secure & Gated
Lift Access

Taylor Place, London, E3

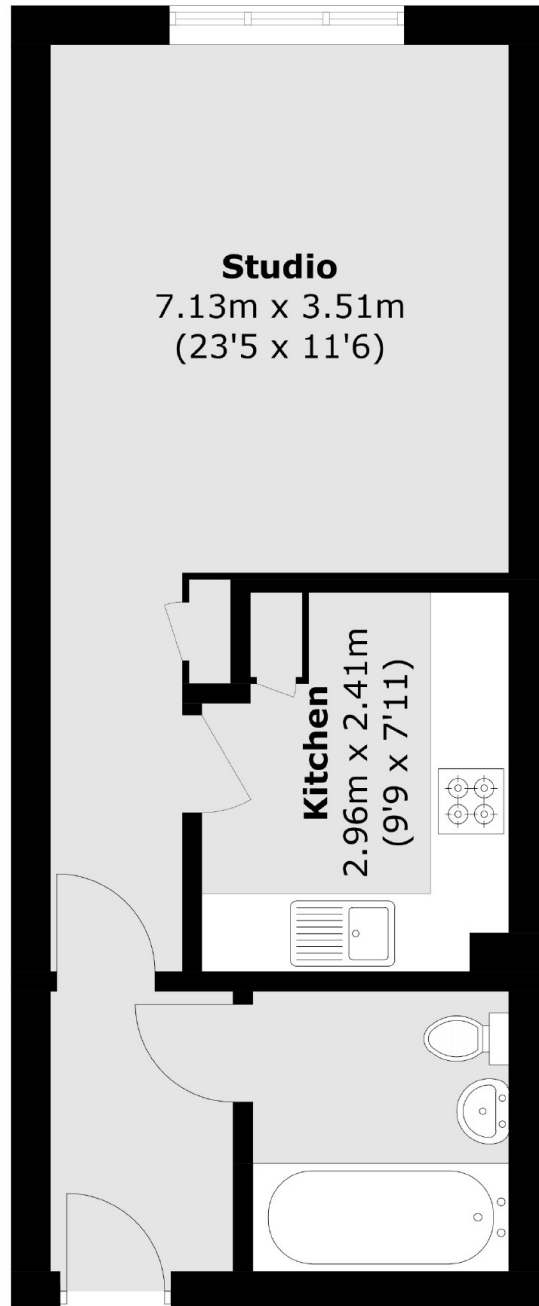

Total area (approx.): 33.1 sq. m (356.2 sq. ft)