



Well Street, E9

£500,000

A three double bedroom ground floor apartment laid out laterally and measures over 800 sqft located within a brick built apartment block. This property has a separate kitchen and living room with access to a private balcony and shared garden, laminate flooring and separate WC. This property is being offered chain free.

Ideally located close by to ample green spaces like Victoria Park and London Fields and all of their amenities. The property also offers great transport links in and around the city with London Fields, Homerton and Hackney Central Overground stations all within walking distance.

Features

- Chain Free
- Three Double Bedrooms
- Over 800SqFt
- Private Balcony
- London Fields
- Victoria Park

Well Street, London, E9

Ground Floor

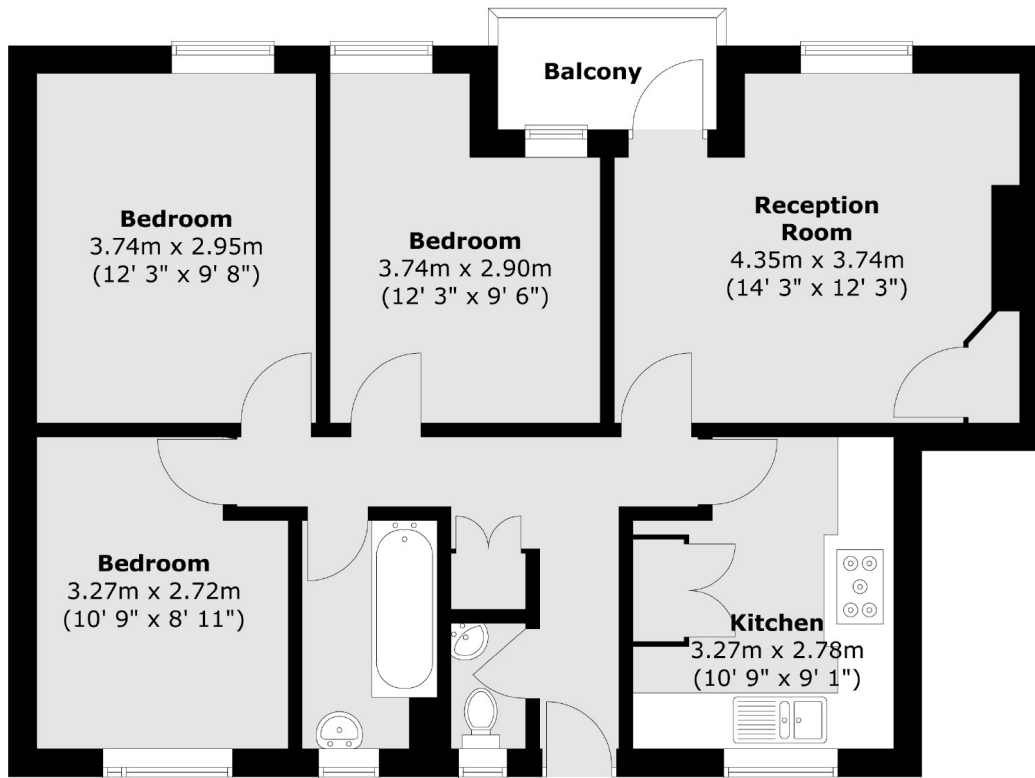

Total area (approx.) : 69.4 sq. m (747 sq. ft)
Total balcony area (approx.) : 2.8 sq. m (30 sq. ft)