



Terrace Road, E9

£1,096 Per week

A stunning three double bedroom end of terraced house on Terrace Road. This beautifully presented property has high ceilings, bay windows, modern spacious kitchen with dining area leading onto two private landscape gardens.

Terrace Road connects directly to Well Street common, nearby Mare Street amenities. Various transport links going directly into the City and Victoria Park are all within walking distance.

Features

- Three Double Bedroom
- Two Bathroom
- Double Reception
- Two Private Gardens
- Bay Windows
- Terraced House

Terrace Road, London, E9

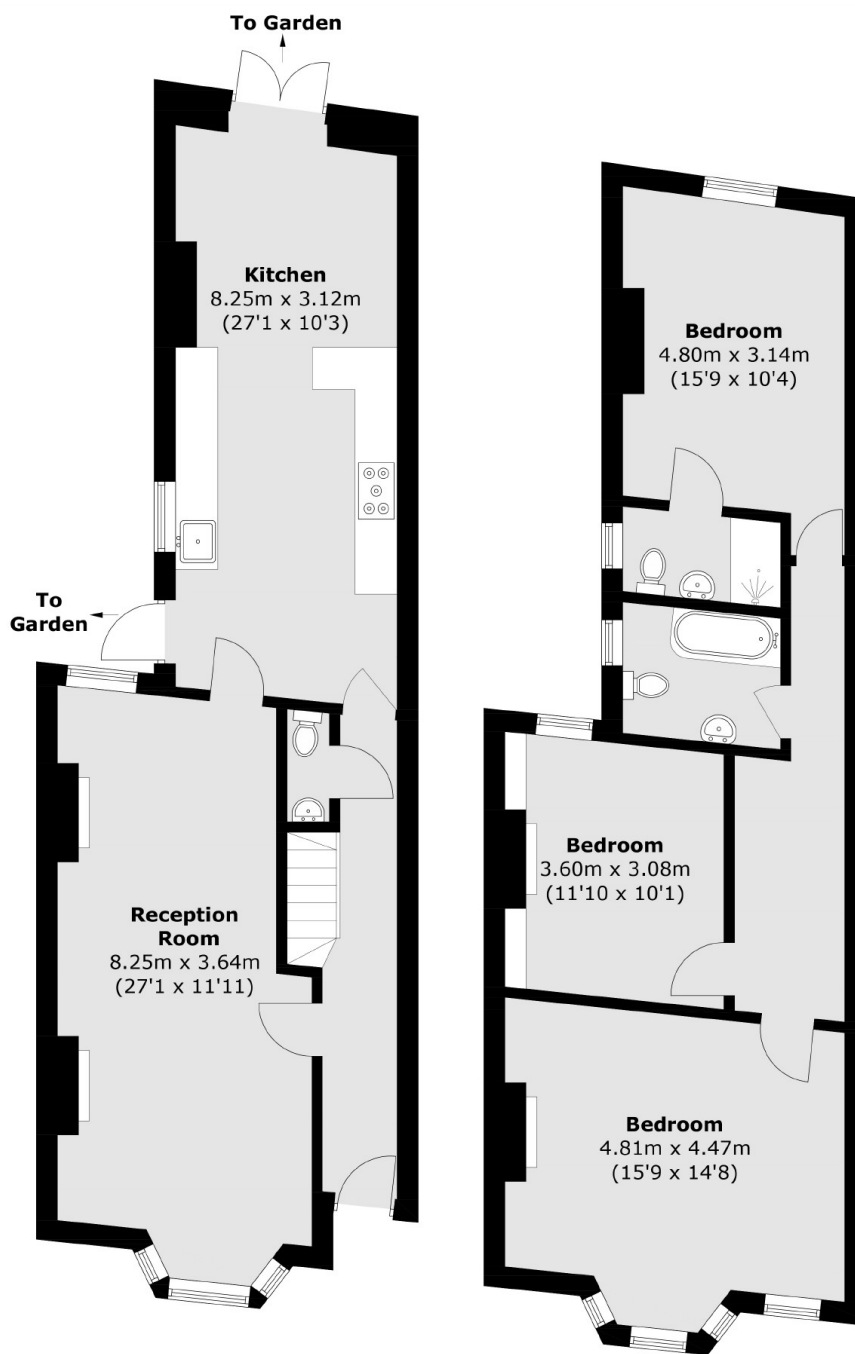

Ground Floor

First Floor

Total area (approx.): 125.0 sq. m (1,345.5 sq. ft)