



Wyke Road, E3

£542 Per week

A stunning one double bedroom apartment in Fish Island, Torchbearer Court. This 5th floor property has a open plan reception, floor to ceiling windows and a private balcony with partial canal views which comes furnished.

Located within the heart of Hackney Wick in Fish Island. Close to Victoria Park and the Regents Canal, as well as a number of local independent bars and restaurant.

Features

- One Double Bedrooms
- Open Plan
- Private Balcony
- On-site Gym
- Concierge
- Furnished

Wyke Road, London, E3

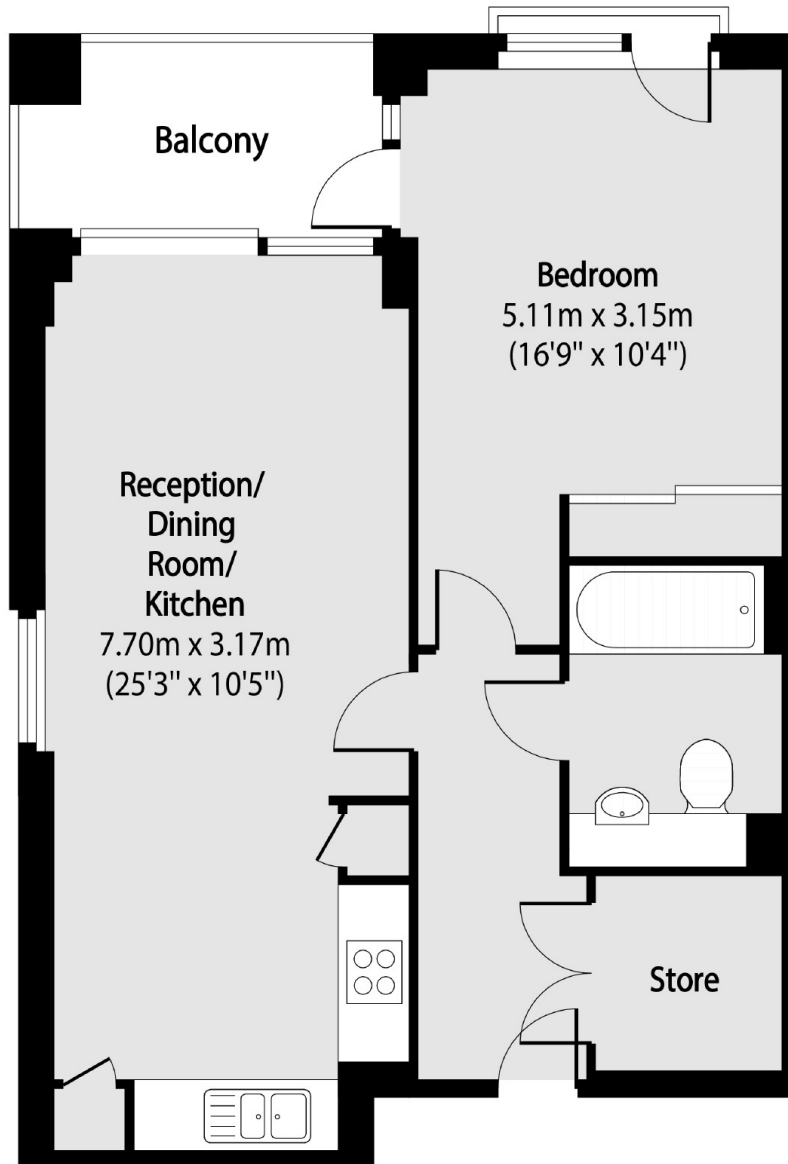

Total area (approx): 51.38 sq m (553 sq. ft)

Balcony total area (approx): 4.92 sq m (53 sq. ft)