



Cardigan Road, E3

£350,000

A bright one bedroom apartment just off Roman road. This property has open plan living, a modern kitchen, plenty of storage and a communal garden.

Roman Road is a main route between Bethnal Green and Mile End underground stations with ample amenities, restaurant, coffee shops and a popular weekend market nearby.

Features

- Lift Serviced
- Communal Garden
- Bike Storage
- Local Markets
- Roman Road
- Victoria Park

Cardigan Road, London, E3

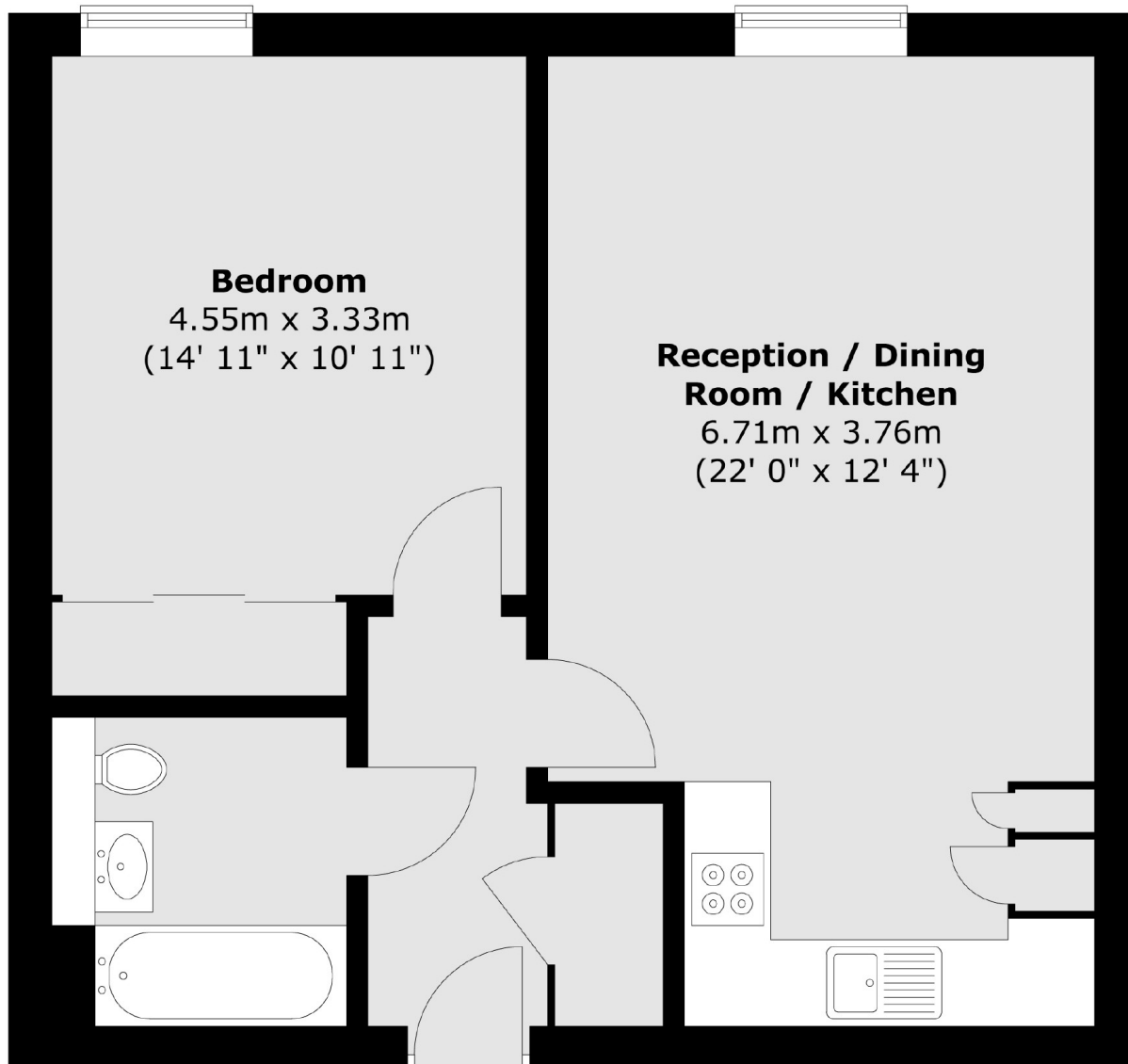

Total area (approx.) : 49.1 sq. m (528 sq. ft)